

VEGETATIVE SWALE MAINTENANCE

- The vegetated swale shall be inspected annually and after large storm events.
- Eroded slopes and channel bottom shall be stabilized as necessary.
- If the surface of the dry swale becomes clogged to the point that standing water is observed on the surface 48 hours after precipitation events, the bottom shall be raked or cultivated to break up any hard-packed sediment, and then reseeded.
- Vegetation in dry swales shall be mowed as required to maintain minimum grass heights in the 4-6 inch range.
- Every five years, the channel bottom of dry swales should be scraped to remove sediment and to restore original cross section and infiltration rate, and should be seeded to restore ground cover, where necessary.

RAIN GARDEN

TREATMENT

Rain garden to be 8" deep with a 2-4 inch amended soil layer (50/50 mixture of the excavated native soils and mature organic compost) and a 2-3 inch layer of non-dyed aged shredded hardwood mulch.

CONSTRUCTION

- A crushed stone entrance should be installed at the inflow to prevent channeling.
- A berm to detain stormwater should be constructed along the downhill side of the rain garden, perpendicular to the slope of the lawn.
- Be sure that the soil within the rain garden area does not become compacted by construction activities (i.e. heavy machinery). If soil becomes severely compacted it may need to be tilled and amended to maintain proper.

MAINTENANCE

- The rain garden shall be inspected following at least the first two precipitation events of at least 1.0 inch to ensure that the system is functioning properly.
- Thereafter, the rain garden shall be monitored and maintained to assure proper functioning, plant growth and survival. Plants shall be replaced on an as-needed basis during the growing season.
- Silt/sediment shall be removed from the rain garden when the accumulation exceeds one inch, or when water ponds on the surface of the rain garden for more than 48 hours. The top few inches of material shall be removed and shall be replaced with fresh soil mixture and mulch.
- Pruning or replacement of woody vegetation shall occur when dead or dying vegetation is observed.
- Soil erosion gullies shall be repaired when they occur.
- Fertilizer or pesticides shall not be applied to plants within rain gardens.
- Perennial plants and ground covers shall be replaced as necessary to maintain adequate vegetated ground cover. Annual plants may also be used to maintain ground cover.

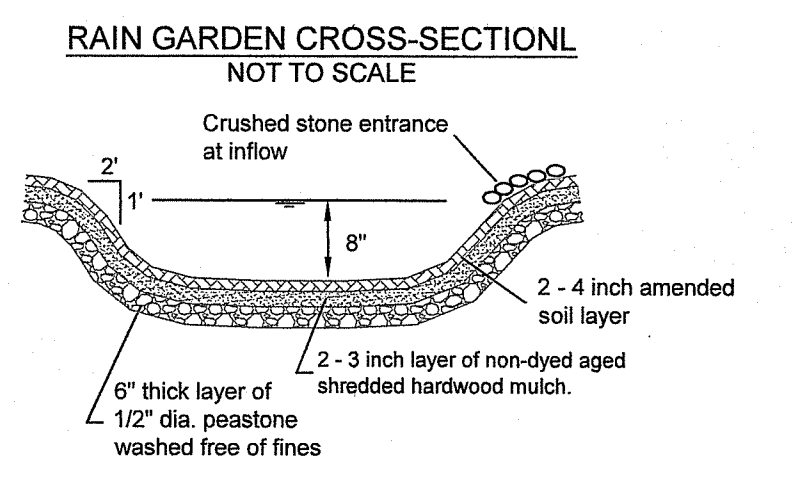
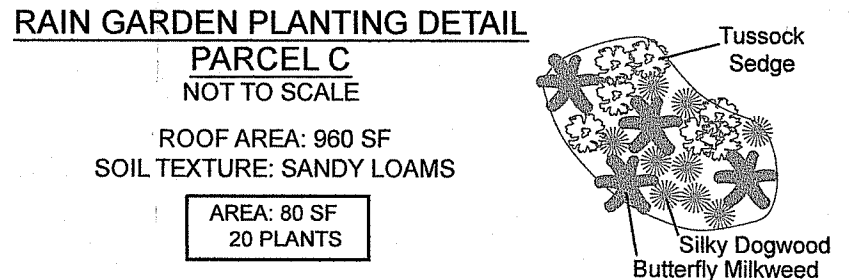
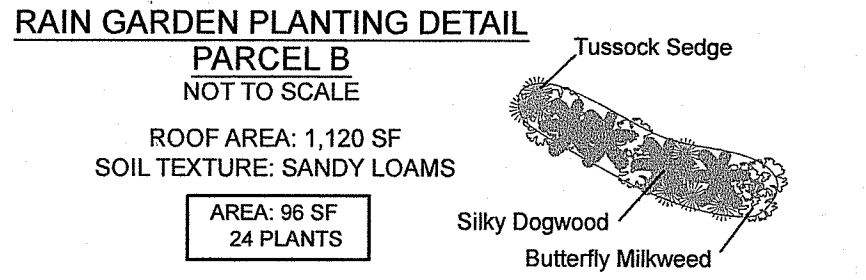
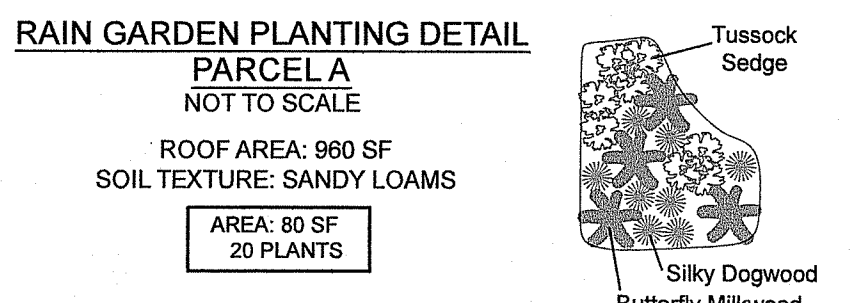

DEPARTMENT OF ENVIRONMENTAL MANAGEMENT
OFFICE OF WATER RESOURCES
FRESHWATER WETLANDS PROGRAM
APPROVED WITH CONDITIONS
AS SPECIFIED IN THE LETTER OF APPROVAL
DATED OCT 20 2021 FILE # 21-0177
NO CHANGES ALLOWED WITHOUT PRIOR APPROVAL
APPROVED PLANS MUST BE AT CONSTRUCTION SITE

Nancy L. Freeman

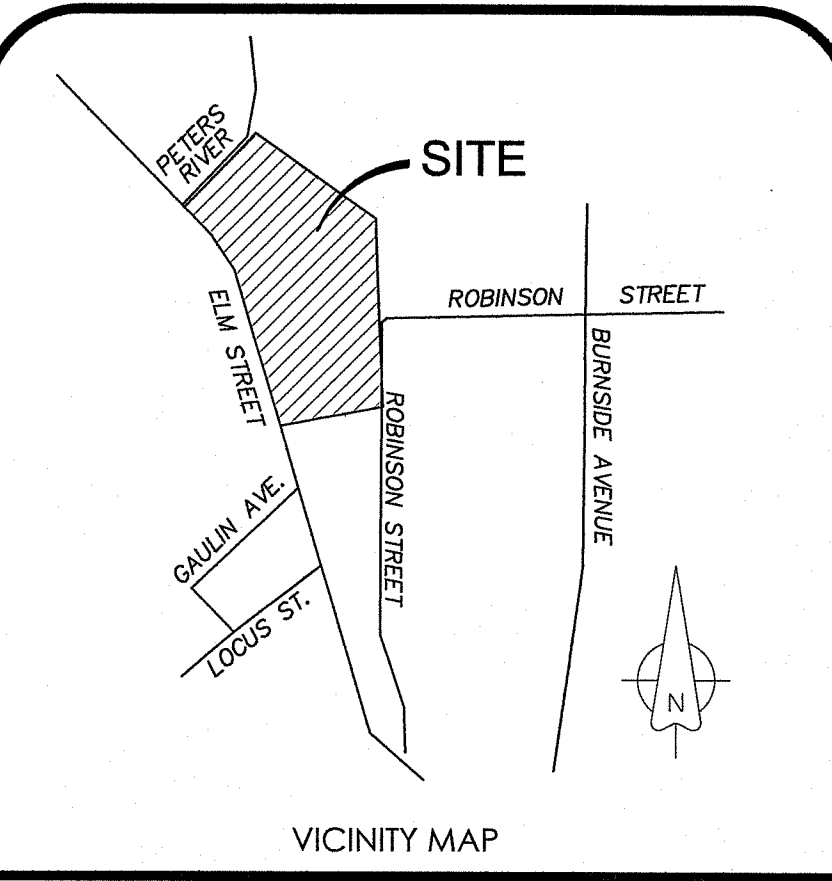

ZONING DISTRICT: R-4
MINIMUM SETBACKS: FRONT - 20'
SIDE - 10'
REAR - 25'

NOTES:
AREA OF DISTURBANCE WITHIN 200' RIVERBANK WETLAND: 13,728 SF.

SITE PLAN

for
EDWARD BEAUCHEMIN
MAP C5, LOTS 36-76 & 36-78
PARCELS A, B & C
ELM STREET
WOONSOCKET, RHODE ISLAND
JUNE, 2021
SCALE 1"= 10'
REVISED: 9-10-21

CERTIFICATION
THIS SURVEY HAS BEEN CONDUCTED AND THE PLAN HAS BEEN PREPARED PURSUANT TO SECTION 9 OF THE RULES AND REGULATIONS ADOPTED BY THE RHODE ISLAND STATE BOARD OF REGISTRATION FOR PROFESSIONAL LAND SURVEYORS ON NOVEMBER 25, 2015, AS FOLLOWS:

LIMITED CONTENT BOUNDARY SURVEY: CLASS IV
TOPOGRAPHIC T-4
STATEMENT OF PURPOSE
THE PURPOSE FOR THE CONDUCT OF THE SURVEY AND THE PREPARATION OF THE PLAN IS AS FOLLOWS: PROPOSED HOUSES
By: *Marc N. Nyberg*
MARC N. NYBERG License No. 1797 COA No.: A52

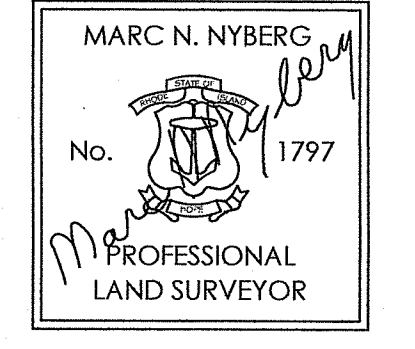

AN SITE Engineering Services, LLC
PROFESSIONAL ENGINEERS | LAND SURVEYORS
Precision. Clarity. Certainty.

501 Great Road, Unit 104
North Smithfield, Rhode Island 02896
Phone: (401) 762-2870 Fax: (401) 401-762-2871
Web Address: an-site-engineers.com
Environmental Management

19-086
SEP 20 2021
Office of Water Resources