

**PLAN VIEW**  
SCALE: 1" = 40'

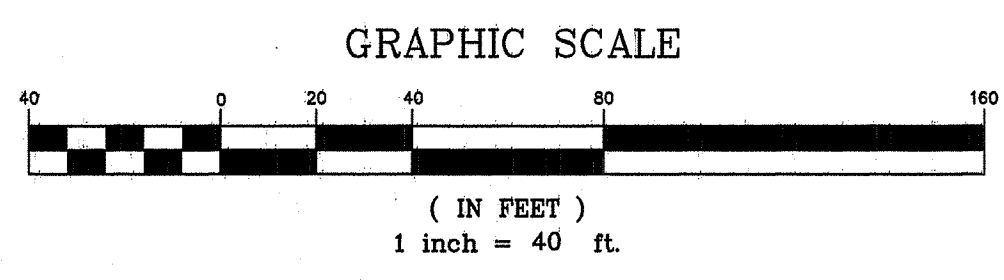

**LEGEND**

- SBDHF □ STONE BOUND FOUND
- SBDHF □ STONE BOUND DRILLHOLE FOUND
- IRF ○ IRON ROD FOUND
- U.P. 40' ○ UTILITY POLE
- WATER SHUTOFF
- DHF ○ DRILLHOLE FOUND
- CESSPOOL/SEPTIC TANK LID
- WELL
- STONE WALL
- PROPERTY LINE
- - - - - APPROX. PROPERTY LINE
- - - - - CONTOUR (ASSUMED DATUM)
- - - - - EXISTING WATERLINE±
- - - - - EXISTING ELECTRICLINE±
- - - - - EXISTING TREELINE
- TH-2

**R-80 ZONE DATA:**

- ZONING SETBACKS:
- FRONT = 50'
- SIDES = 40'
- REAR = 60'

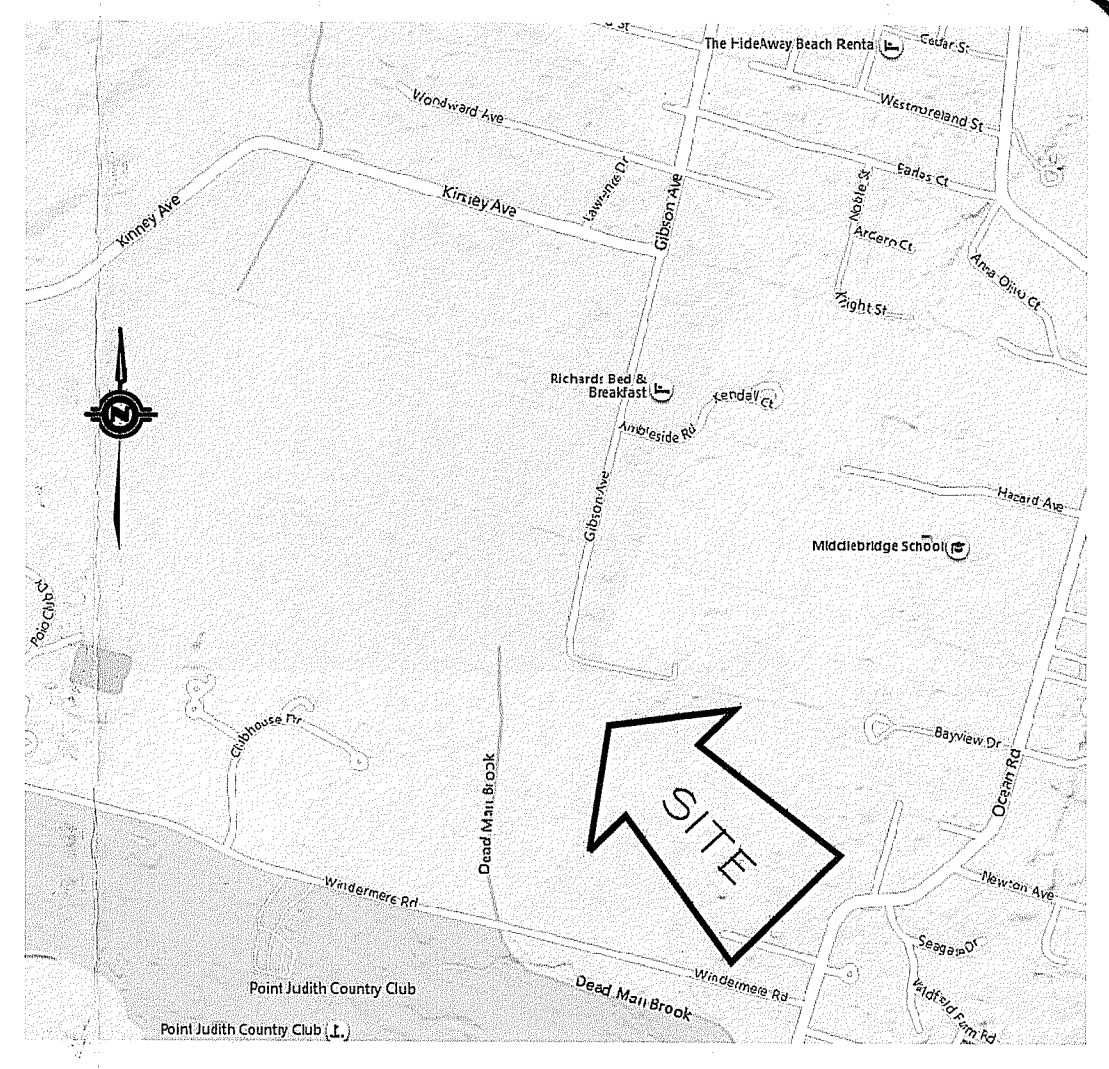

**LOCUS MAP**

**OWNER:**

JOHN W. & LISA B. GOODWIN  
176 GIBSON AVENUE  
NARRAGANSETT, RI

**NOTES:**

- 1.) SITE IS LOCATED WITHIN IDENTIFIED FLOOD ZONE "X" ACCORDING TO FEMA MAP# 44009C0212J, DATED 10/16/2013.
- 2.) SITE IS NOT LOCATED WITHIN A CRMC & RIDEM CRITICAL RESOURCE AREA.
- 3.) THE UTILITIES SHOWN HEREON ARE THE RESULT OF FIELD LOCATIONS OF VISIBLE STRUCTURES AT THE TIME OF FIELD SURVEY & RECORD PLANS ACQUIRED FROM THE UTILITY COMPANIES. WE ACCEPT NO RESPONSIBILITY FOR THE ACCURACY OR COMPLETENESS OF UTILITIES SHOWN. CALL DIG-SAFE PRIOR TO START OF CONSTRUCTION FOR EXACT UTILITY LOCATIONS.
- 4.) THIS SURVEY HAS BEEN CONDUCTED & THE PLAN HAS BEEN PREPARED PURSUANT TO SECTION 9 OF THE RULES & REGULATIONS ADOPTED BY THE RI STATE BOARD OF REGISTRATION FOR PROFESSIONAL LAND SURVEYORS ON 11/25/2015 AS FOLLOWS: PERIMETER SURVEY: CLASS II. TOPOGRAPHY: CLASS II. THE PURPOSE FOR THE CONDUCT OF THE SURVEY & THE PLAN PREPARATION IS TO DETERMINE WHETHER LOT 4-1 IS BUILDABLE.
- 5.) REFERENCE "COMPILED PLAN OF PARTITION OF LAND SITUATED IN THE TOWN OF NARRAGANSETT, RI, PROPERTY OF PAUL S. & FRANCES E. KNOWLES, PARCELS 4-1 & 4-2 TO BE CONVEYED TO JAMES W. & RUTH J K FAIN. PARCEL 5-1 TO BE CONVEYED TO JAMES & LINDA K. GLOOR, JANUARY 1995, AJ EASTERBROOKS, C.E., SCALE: 1"=100'."
- 6.) REFERENCE "LAND AT POINT JUDITH IN THE TOWN OF NARRAGANSETT, RI OWNED BY JULIA B. MCHALE. LOT A TO KATHERINE HAZARD, LOT B TO I. PEACE HAZARD. SCALE: 1"=200', MAY 20, 1936, T.G.HAZARD, JR. SURVEYOR."
- 7.) REFERENCE DEED BOOK/PAGE: 5/48, 34/202, 48/344, 151/11, 625/744, 847/586-588, 328/102-103 .
- 8.) SUBJECT TO EASEMENTS & RIGHTS OF WAY OF RECORD (IF ANY).
- 9.) STREET INDEX : GIBSON AVENUE
- 10.) WETLAND EDGE LOCATION DELINEATED BY NINIGRET ENVIRONMENTAL, LLC IN MAY 2021.

**WETLAND EDGE VERIFICATION SURVEY SITE PLAN**

A.P. Z, LOTS 4 & 4-1  
GIBSON AVENUE  
NARRAGANSETT, RHODE ISLAND  
Prepared For:  
JOHN & LISA GOODWIN

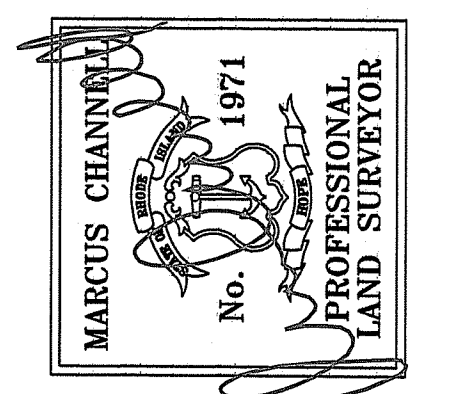

**ATLAS LAND SURVEYING, LLC**  
PROPERTY & CONSTRUCTION SURVEYING & MAPPING

91 Parkway Drive ~ Warwick, RI 02886  
401-737-4407  
WWW.ATLASLANDSURVEYING.COM

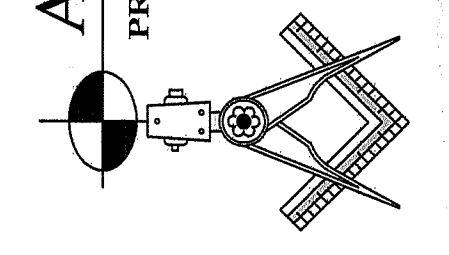

Revised Management  
JUN 18 2021  
DRAWN BY: KRC  
SCALE: 1" = 40'

SHEET  
**1**  
OF 1 SHEETS 1  
JOB NO. GOODWIN  
DWG. NO. GOODWIN-WET