

LOCUS MAP
NOT TO SCALE
BEING MAP 63-9, LOT 333
LOT AREA = 1.1 ACRES

Basemap Note:
All basemap and survey data provided by Atlas Land Surveying.

PLANTING NOTE:
Rhododendron (*Rhododendron maximum*) 4-5 feet tall, spaced 8 foot on-center shall be planted as shown.

Infiltration Basin Maintenance Note:
Infiltration facilities should be inspected annually to ensure that design infiltration rates are being met. If sediment or organic debris build-up has limited the infiltration capabilities (infiltration basins) to below the design rate, the top 6 inches should be removed and the surface re-tilled to a depth of 12 inches. The basin bottom should be restored according to original design specifications. Any oil or grease found at time of the inspection should be cleaned with oil absorption pads and disposed of in an approved location. Inspect facility for signs of wetness and note any eroded areas. If dead or dying grass on the bottom is observed, check to ensure that water percolates 2-3 days following storms. Mow and remove litter and debris. Stabilize eroded banks and repair undercut and eroded areas at inflow and outflow structures.

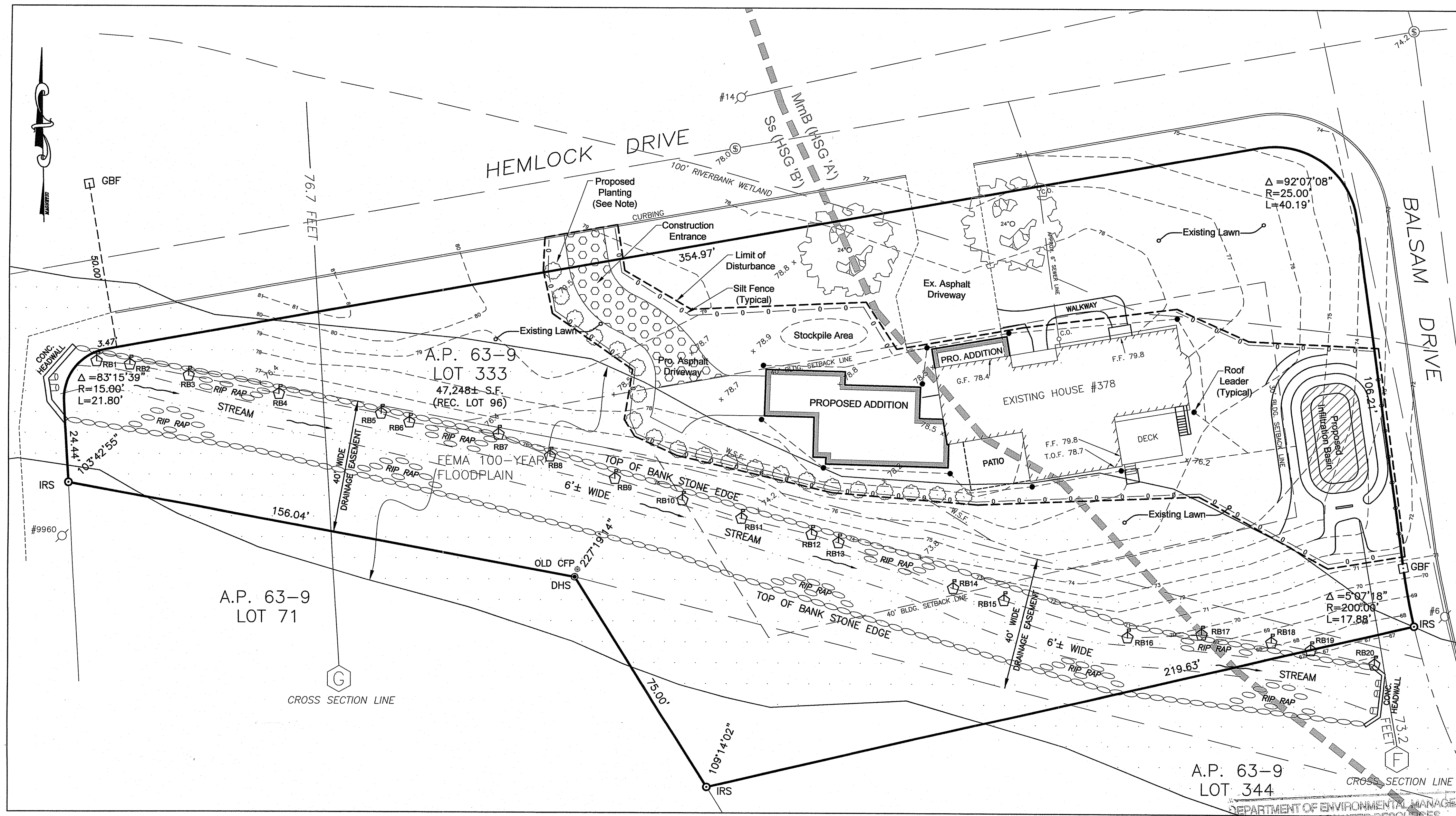

- EROSION CONTROL & SOIL STABILIZATION PROGRAM**
- DENUDED SLOPES SHALL NOT BE UNATTENDED OR EXPOSED FOR EXCESSIVE PERIODS OF TIME SUCH AS THE INACTIVE WINTER SEASON.
 - ALL DISTURBED SLOPES EITHER NEWLY CREATED OR EXPOSED PRIOR TO OCTOBER 15 SHALL BE SEEDED OR PROTECTED BY THAT DATE FOR ANY WORK COMPLETED DURING EACH CONSTRUCTION PERIOD.
 - THE TOPSOIL SHALL HAVE A SANDY LOAM TEXTURE RELATIVELY FREE OF SUBSOIL MATERIAL, STONES, ROOTS, LUMPS OF SOIL, TREE LIMBS, TRASH OR CONSTRUCTION DEBRIS, AND SHALL CONFORM WITH R. I. STANDARD SPECIFICATION M. 20.
 - THE SEED MIX SHALL BE INOCULATED WITHIN 24 HOURS, BEFORE MIXING AND PLANTING, WITH APPROPRIATE INOCULUM FOR EACH VARIETY.
 - THE DESIGN MIX SHALL BE COMPRISED OF THE FOLLOWING PERMANENT SEEDING MIXTURES: A - MOWED AREA: ALL FLAT OR SLOPES LESS THAN 3:1

MIXTURE	% BY WT.	SEEDING DATES
RED FESCUE	75	APRIL 1 - JUNE 15
KENTUCKY BLUEGRASS	5	AUG. 15 - OCT. 15
PERENNIAL RYEGRASS	5	
COLONIAL BENTGRASS	5	
PERENNIAL RYEGRASS	5	

TOTAL 100%/ACRE
PERMANENT SEEDING MIXTURES:

B - UNMOWED AREA OR INFREQUENTLY MOWED: FLAT OR SLOPES GREATER THAN 3:1

MIXTURE	% BY WT.	SEEDING DATES
RED FESCUE	75	APRIL 1 - JUNE 15
PERENNIAL RYEGRASS	5	AUG. 15 - OCT. 15
COLONIAL BENTGRASS	5	
BIRDSFOOT TREFOIL	15	

- TEMPORARY TREATMENTS SHALL CONSIST OF A HAY, STRAW OR FIBER MULCH OR PROTECTIVE COVERS SUCH AS A MAT OR FIBER LINING (GULAP, JUTE, FIBERGLASS NETTING, EXCELOR BLANKETS). THEY SHALL BE INCORPORATED INTO THE WORK AS WARRANTED OR AS ORDERED BY THE ENGINEER.
 - HAY OR STRAW APPLICATIONS SHOULD BE IN AN AMOUNT OF 3000-4000 LBS/AC. ALL HAYBALES OR TEMPORARY PROTECTION SHALL REMAIN IN PLACE UNTIL AN ACCEPTABLE STAND OF GRASS OR APPROVED GROUND COVER IS ESTABLISHED. IF NEEDED, TEMPORARY SEEDING CAN BE USED TO HELP MINIMIZE EROSION. TEMPORARY SEEDING GUIDE MUST BE INCLUDED AS A REFERENCE. THE FOLLOWING SPECIES ARE RECOMMENDED:
- | SPECIES | LBS/ACRE | LBS/1,000 SQ. FT. | SEEDING DATES |
|--------------------|----------|-------------------|---------------------|
| ANNUAL RYEGRASS | 60 | 1.5 | MAR. 15 - JUNE 15 |
| PERENNIAL RYEGRASS | 40 | 1.0 | MAY 15 - AUGUST 15 |
| SUDAN GRASS | 40 | 1.0 | MAY 15 - AUGUST 15 |
| WINTER RYE | 120 | 3.0 | AUGUST 15 - JUNE 15 |
| CATS PAW | 120 | 3.0 | MAR. 15 - JUNE 15 |
| WEEDING LOVEGRASS | 20 | 0.5 | MAY 1 - JUNE 30 |
- THE CONTRACTOR MUST REPAIR AND OR RESEED ANY AREAS THAT DO NOT DEVELOP WITHIN THE PERIOD OF ONE YEAR AND HE SHALL DO SO AT NO ADDITIONAL EXPENSE.
 - THE NORMAL ACCEPTABLE SEEDING DATES ARE APRIL 1ST THRU OCT. 15TH.
 - STABILIZATION OF ONE FORM OR ANOTHER AS DESCRIBED ABOVE SHALL BE ACHIEVED WITHIN 15 DAYS OF FINAL GRADING.
 - STOCKPILES OF TOPSOIL SHALL NOT BE LOCATED NEAR WATERWAYS OR WETLANDS, OR TRACKING TO TAKE DOWN MULCH APPLICATIONS.
 - REFER TO THE SEDIMENTATION CONTROL PROGRAM AND ORDER OF PROCEDURE FOR PROPER COORDINATION.

- SEDIMENTATION CONTROL PROGRAM**
- ALL DISTURBED AREAS SUBJECT TO EROSION TENDENCIES WHETHER THEY ARE NEWLY FILLED OR EXCAVATED SHALL RECEIVE SUITABLE SLOPE PROTECTION.
 - DURING CONSTRUCTION, THE CONTRACTOR AND/OR DEVELOPER SHALL BE RESPONSIBLE FOR MAINTAINING DRAINAGE AND RUNOFF FLOW DURING STORMS AND PERIODS OF RAINFALL.
 - CARE SHALL BE TAKEN SO AS TO PREVENT ANY UNSUITABLE MATERIAL FROM ENTERING EITHER EXISTING OR PROPOSED DRAINAGE OR SEWER STRUCTURES.
 - SEEDING AND SEDIMENTATION CONTROL MEASURES SHALL BE PERIODICALLY INSPECTED AND MAINTAINED AS NEEDED.
 - ADDITIONAL HAYBALES, SILT FENCE OR SANDBAGS SHALL BE LOCATED AS CONDITIONS WARRANT OR AS DIRECTED BY THE ENGINEER.
 - REFER TO THE "RIP RAP ISLAND EROSION AND SEDIMENT CONTROL HANDBOOK" PREPARED BY THE U.S. DEPT. OF AGRICULTURE, SOIL CONSERVATION SERVICE, 1989, WITH ANY AMENDMENTS, AS A GUIDE.

- ORDER OF PROCEDURE**
- IMMEDIATELY UPON COMPLETION OF THE CLEARING AND GRUBBING OPERATION AND PRIOR TO ANY GRADING, TEMPORARY HAYBALES, SILT FENCE OR SANDBAGS SHALL BE PLACED OUTSIDE THE LIMITS OF DISTURBANCE AS SHOWN ON THE PLANS, I.E. NEW ROADWAYS, STREAMBANKS, CRITICAL AREAS, ETC.
 - ALL EROSION AND SEDIMENTATION CONTROL MEASURES SHALL BE PERIODICALLY CLEANED AND MAINTAINED AS PER THE RESPECTIVE PROGRAMS DURING THE CONSTRUCTION.
 - IF WORK PROGRESS IS TO BE INTERRUPTED AT ANY TIME, REFERENCE EROSION AND SEDIMENTATION CONTROL PROGRAMS FOR TEMPORARY CONTROL.

- MAINTENANCE AND RESPONSIBILITY**
- THE CONTRACTOR SUPERINTENDENT SHALL HAVE THE SOLE RESPONSIBILITY FOR THE DESIGN IMPLEMENTATION. HE SHALL ALSO BE RESPONSIBLE FOR ENSURING THAT ALL CONSTRUCTION WORKERS AND SUB CONTRACTORS ARE AWARE OF THE PROVISIONS OF THE PLAN AND THE ENGINEER'S REPORT.
- THE CONTRACTOR SHALL BE RESPONSIBLE FOR MAINTAINING ALL ASPECTS OF THE DESIGN PRIOR TO FINAL APPROVAL BY THE TOWN. DURING THAT TIME, ALL EROSION AND SEDIMENTATION CONTROL MEASURES SHOULD BE CHECKED ON A WEEKLY BASIS AS WELL AS AFTER EACH SIGNIFICANT RAINFALL. ALL SUCH MEASURES SHOULD BE CLEANED OR REPLACED AS NECESSARY.
 - REPLANTING, REGRADING OR OTHER REPAIRS NEEDED AS A RESULT OF EROSION AND SEDIMENTATION SHOULD BE DONE PROMPTLY.

- NOTES:**
- ALL EROSION CONTROL MEASURES TO REMAIN FOR 3 CONSECUTIVE MOWINGS.
 - CONTRACTOR TO CALL PUBLIC WORKS PRIOR TO CONSTRUCTION AND AGAIN FOR FINAL INSPECTION.
 - THIS SITE AS DESIGNED WILL HAVE NO ADVERSE EFFECT ON ADJUTING PROPERTIES ASSUMING EROSION CONTROL PLAN IS IMPLEMENTED.
 - FOR DRIVEWAYS SLOPING DOWN TOWARD THE ROAD HAYBALES TO BE SET ACROSS DRIVEWAY AT THE END OF DAY.
 - CONSTRUCTION TO COMMENCE IMMEDIATELY FOLLOWING APPROVAL AND WILL TAKE APPROXIMATELY 6 MONTHS TO COMPLETE.

- GENERAL NOTES**
- IT SHALL BE THE CONTRACTOR'S RESPONSIBILITY TO OBTAIN ANY AND ALL PERMITS REQUIRED BY THE STATE OF RHODE ISLAND AND THE MUNICIPALITY PRIOR TO COMMENCING ANY WORK.
 - IT SHALL ALSO BE THE CONTRACTOR'S RESPONSIBILITY TO MAINTAIN THE INTEGRITY OF ALL EXISTING UTILITIES, STRUCTURES, AND ADJUTING PROPERTIES. THE COST OF ANY REPAIR OR REPLACEMENT OF DAMAGED ITEMS SHALL BE BORNE BY THE CONTRACTOR.
 - THE CONTRACTOR SHALL COORDINATE ALL WORK WITH THE MUNICIPAL ENGINEERING DEPARTMENT AND ALL UTILITY INSTALLATIONS AND INSPECTIONS WITH THE APPROPRIATE UTILITY CO. A 48 HOUR ADVANCE NOTICE IS REQUIRED BEFORE WORK COMMENCEMENT.
 - ALL WORK WITHIN THE STATES ROW WILL CONFORM TO RIDOT'S STANDARD SPECIFICATIONS FOR ROAD AND BRIDGE CONSTRUCTION, 2015 AMENDED AUGUST 2015 AND STANDARD DETAILS, JUNE 15, 1998 AS AMENDED BY REVISION 5. ALL TRAFFIC CONTROL SHALL CONFORM TO THE MANUAL ON UNIFORM TRAFFIC CONTROL DEVICES 2009, INCLUDING ALL REVISIONS.
 - THE CONTRACTOR SHALL BE SOLELY RESPONSIBLE FOR QUANTITY TAKE OFF IN COMPUTING ANY ESTIMATES.
 - EMBANKMENT SLOPES AND ALL DISTURBED AREAS ARE TO RECEIVE 4" OF TOPSOIL AND SEED. SEE EROSION CONTROL PROGRAM DETAILS.
 - THE CONTRACTOR IS RESPONSIBLE FOR ALL CONSTRUCTION INDICATED ON THESE PLANS. THAT INCLUDES ANY CONSTRUCTION TO BRING UTILITIES TO THE SITE, ANY REPAIRS, ANY TRENCHING REQUIRED.
 - THE CONTRACTOR SHALL BE RESPONSIBLE FOR ESTABLISHING AND MAINTAINING ALL TEMPORARY SEDIMENTATION AND SOIL EROSION CONTROL MEASURES.
 - THE LOCATION OF EXISTING UTILITIES IS SHOWN AS APPROXIMATE AND SHOULD BE VERIFIED BY THE CONTRACTOR WITH THE APPROPRIATE UTILITY COMPANIES. CALL DIG-SAFE 1(888)944-7233.
 - IN ALL EXCAVATION AND PLACEMENT OF FILL THE CONTRACTOR SHALL PERFORM THE WORK IN FULL COMPLIANCE WITH THE R.I. STANDARD SPECIFICATION SECTION 202.
 - ALL CONSTRUCTION AND UTILITY WORK SHALL CONFORM TO THE LATEST MUNICIPAL STANDARDS. IT IS THE RESPONSIBILITY OF THE CONTRACTOR TO OBTAIN, COMPREHEND AND IMPLEMENT THESE REQUIREMENTS PROPERLY.

WATER QUALITY CALCULATIONS:
PROPOSED ADDITIONAL IMPERVIOUS AREA = 2,180 S.F.
2,180 S.F. X 1" = 182 C.F. REQUIRED
564 C.F. PROVIDED
(25-YEAR STORM RUNOFF MITIGATION REQUIRED PER TOWN OF EAST GREENWICH)

FEMA DETERMINATION
PARTIALLY ZONE "X" - AREA OF MINIMAL CHANCE ANNUAL FLOODING
PARTIALLY ZONE "AE" - AREA OF 1% CHANCE ANNUAL FLOODING
PANEL NO. - 44003C0138 G
EFFECTIVE - DECEMBER 3, 2010

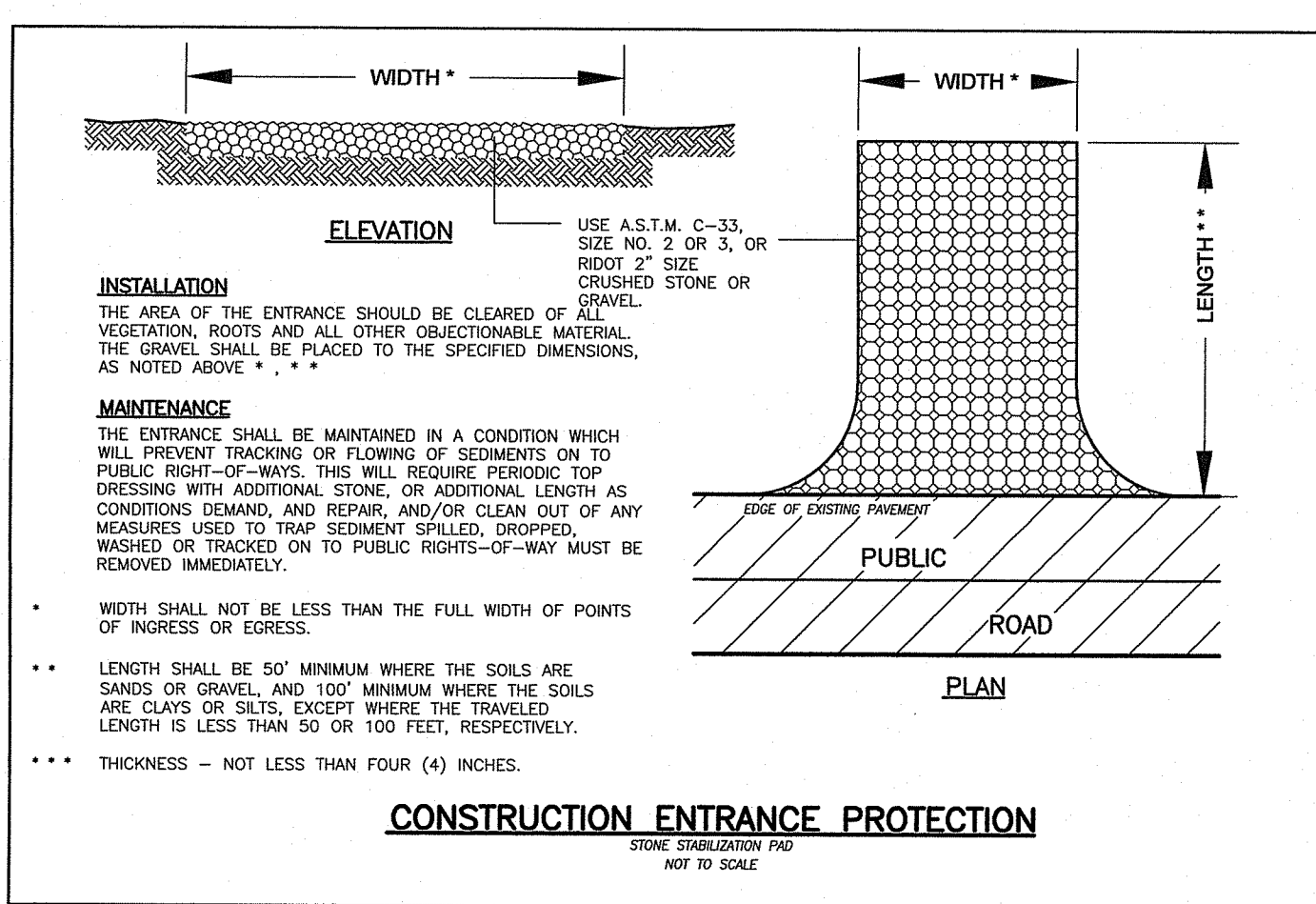
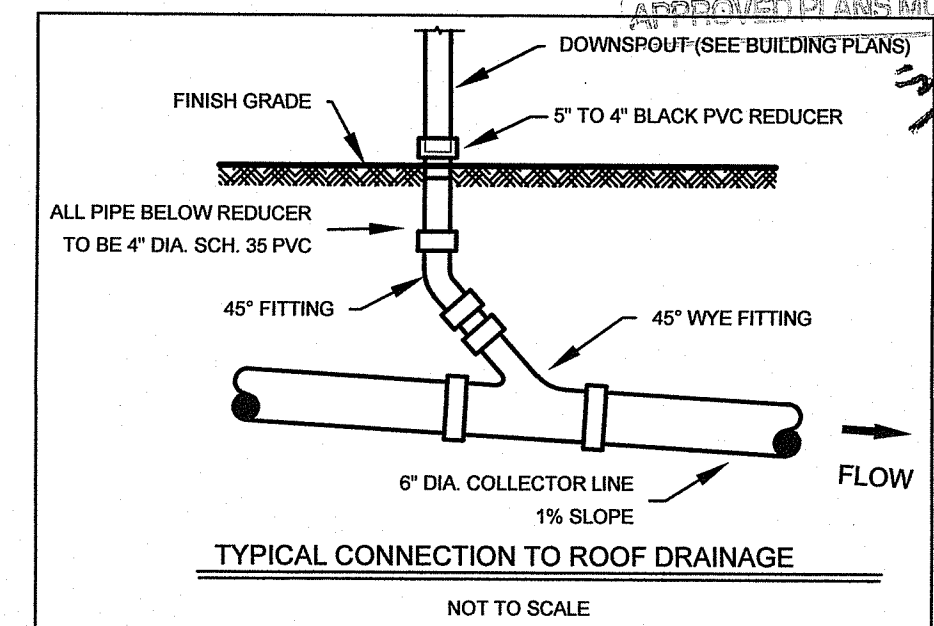
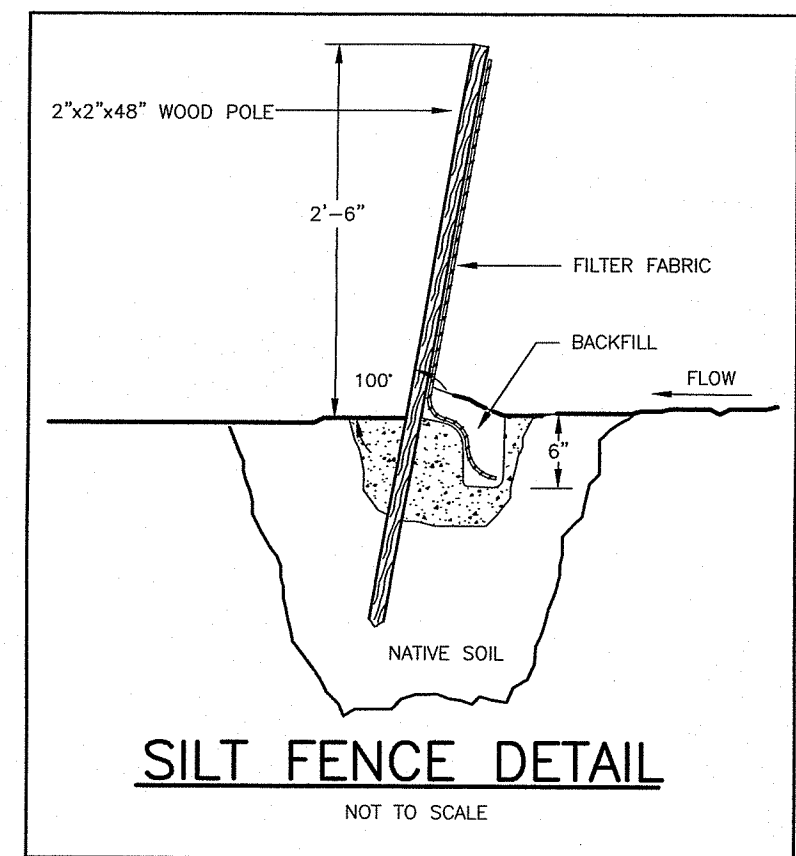
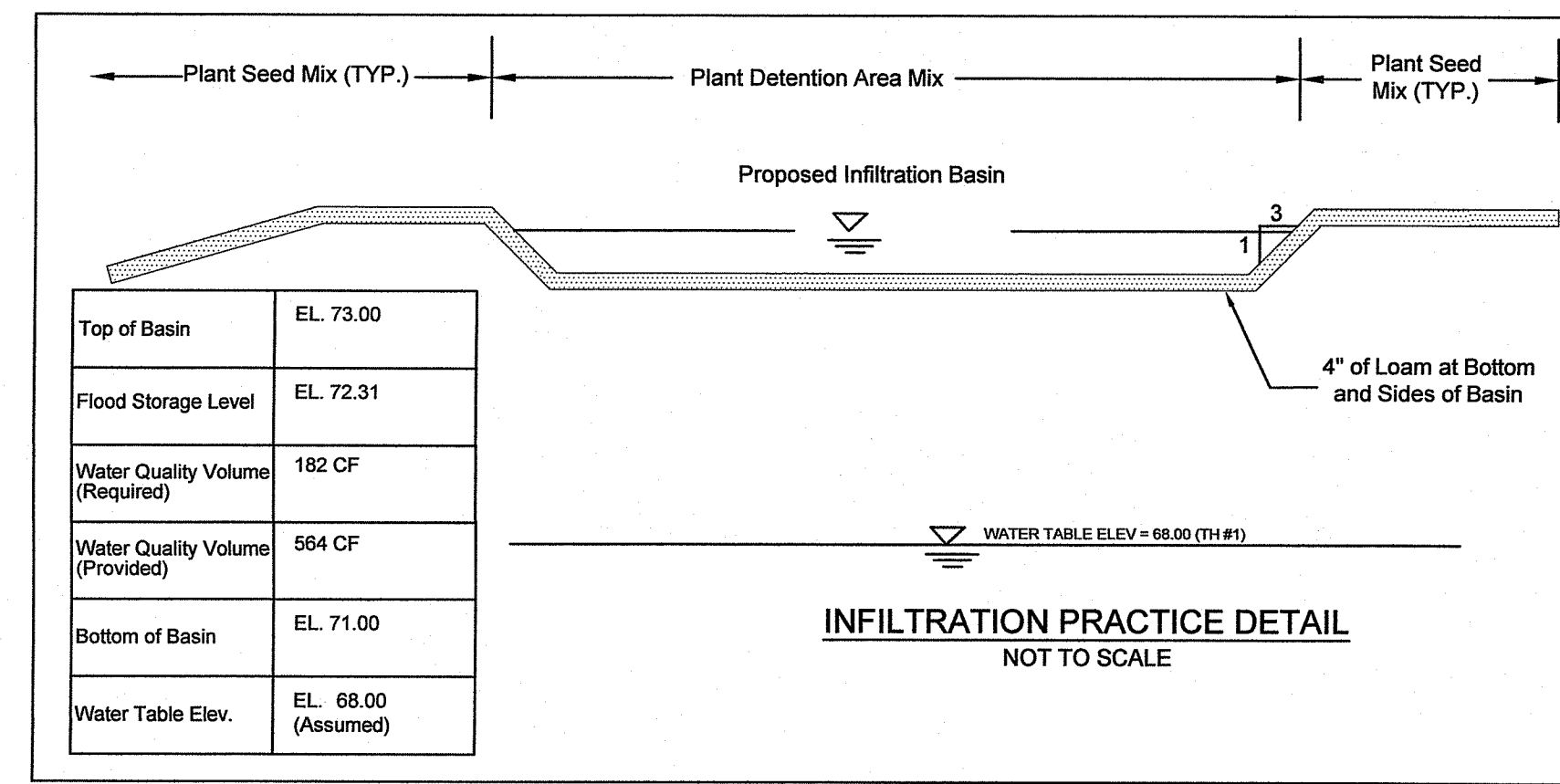
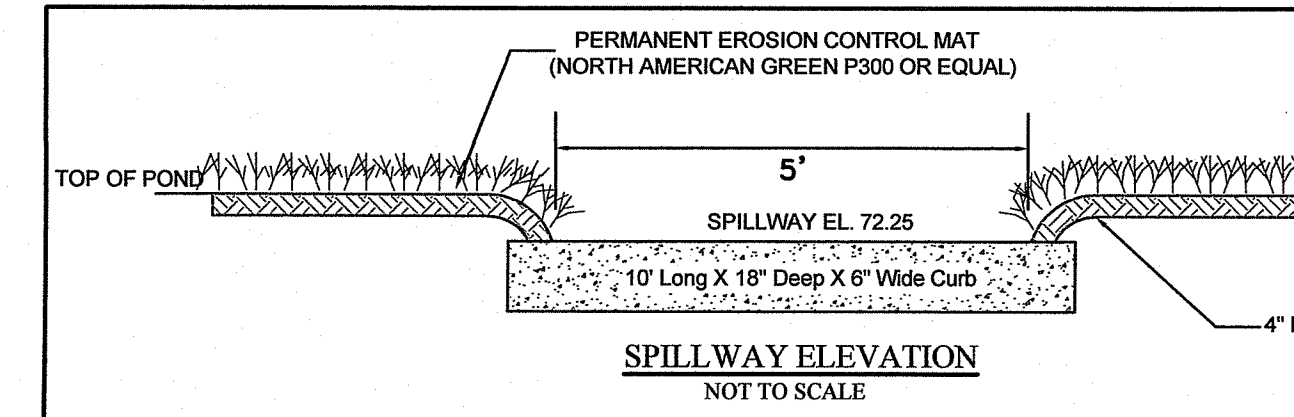
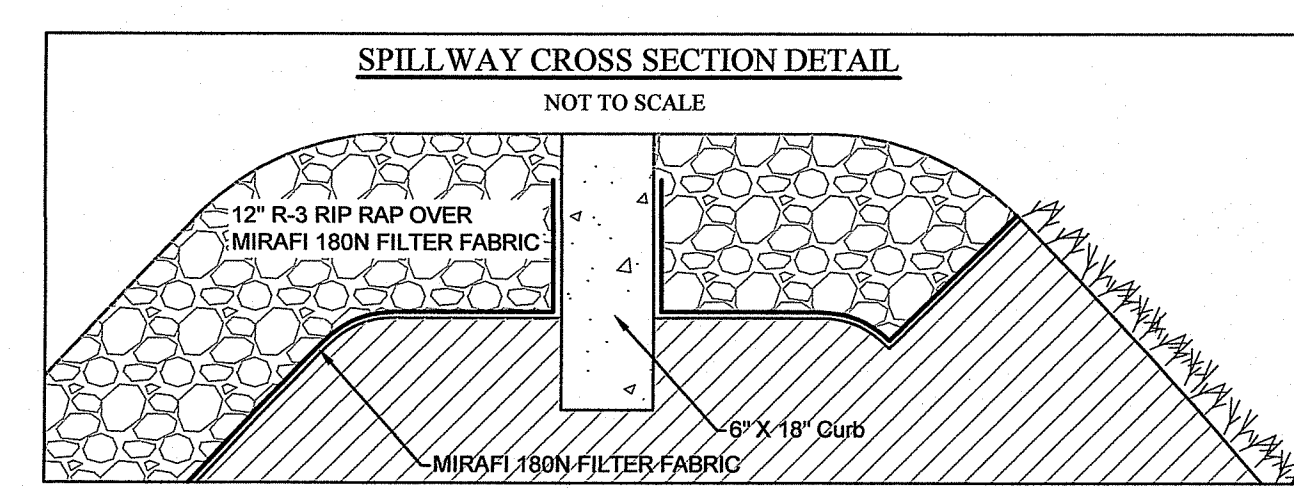
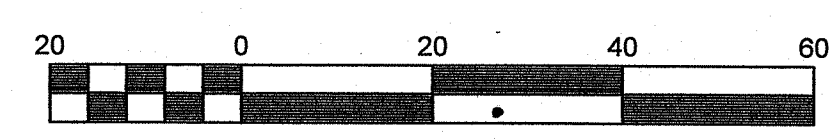

STORMWATER POLLUTION PREVENTION PLAN
FOR
MICHAEL & CATHERINE SIMONETTI
LOCATED AT
378 HEMLOCK DRIVE
EAST GREENWICH, RI

Checked By: P/JF
Date: 06/09/2021
Scale: 1" = 20'

NO.	REVISION	DATE	BY
1.	PER RFI# COMMENTS	P/JF	P/JF
2.	PER RFI# COMMENTS	P/JF	P/JF

SEP 13 2021

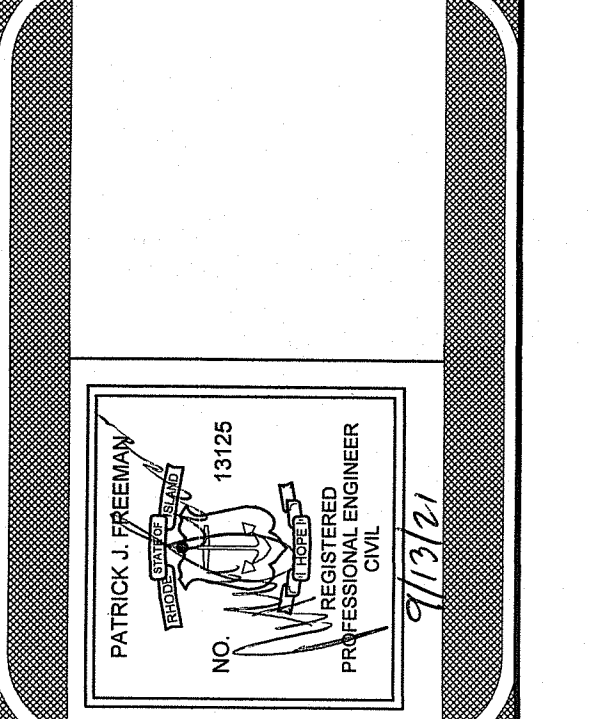

AMERICAN ENGINEERING, INC.
DANIEL R. COTTA Professional Engineer / Professional Land Surveyor
400 South County Trail - Suite A 201
Exeter, Rhode Island 02822
DCotta@AmericanEngineeringRI.com
Phone (401) 294-4090 / Fax (401) 294-3625

Sheet
1
of 1 sheets
Drawing No. 121129

PLAN FOR NOTICE