

EMBANKMENT BRIDGE REPLACEMENT DESIGN SLATER MILL RESIDENCES SLATERSVILLE, RHODE ISLAND AUGUST 2021

PREPARED FOR:

**RESIDENCES AT SLATER
MILL, LLC**

PREPARED BY:

 **GZA** GeoEnvironmental, Inc.
Engineers and Scientists
www.gza.com

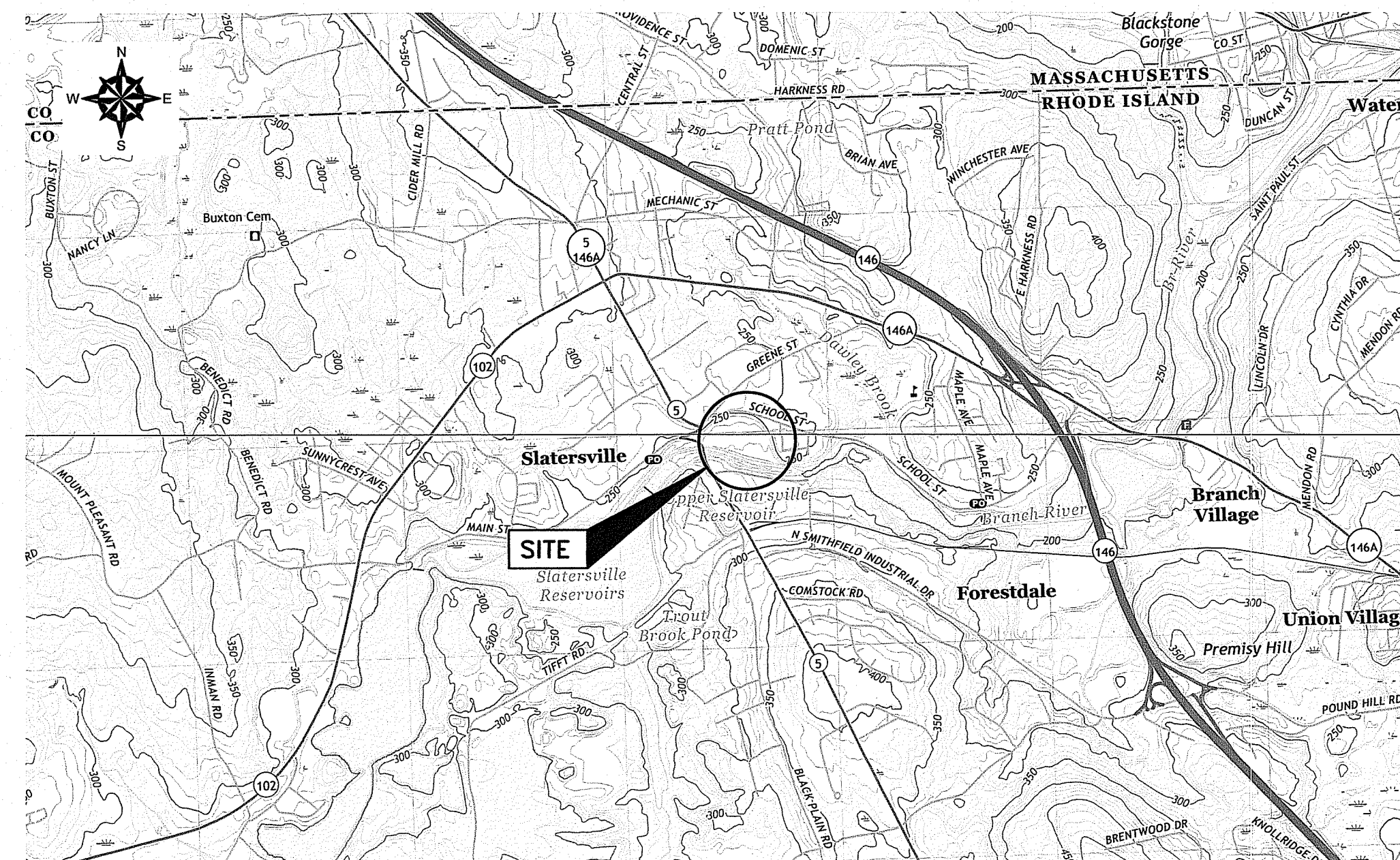

PROJECT LOCUS MAP

SOURCE: USGSSTORE.GOV

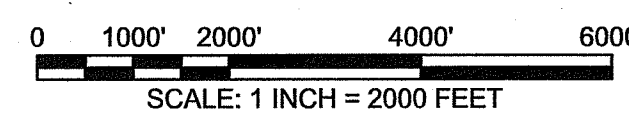

BASE MAP FROM THE FOLLOWING USGS QUADRANGLE MAP:
GEORGIAVILLE, RI (2018), BLACKSTONE, MA (2018)

DIGITAL TOPOGRAPHIC MAPS PROVIDED BY USGSSTORE.GOV.

CONTOUR ELEVATIONS REFERENCE NAVD 88.
CONTOURS ARE SHOWN IN FEET AT 10 FOOT INTERVALS

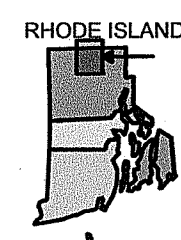

QUADRANGLE LOCATION

INDEX OF DRAWINGS	
SHEET NUMBER	SHEET TITLE
1	COVER
2	EXISTING CONDITIONS PLAN
3	SOIL EROSION AND SEDIMENT CONTROL PLAN
4	DEMOLITION PLAN
5	WATER CONTROL PLAN
6	SITE RESTORATION PLAN
7	CONSTRUCTION DETAILS AND SPECIFICATIONS

DEPARTMENT OF ENVIRONMENTAL MANAGEMENT
OFFICE OF WATER RESOURCES
FRESHWATER WETLANDS PROGRAM
APPROVED WITH CONDITIONS
AS SPECIFIED IN THE LETTER OF APPROVAL
DATED **OCT 05 2021** FILE # **21-0207**
NO CHANGES ALLOWED WITHOUT PRIOR APPROVAL
APPROVED PLANS MUST BE AT CONSTRUCTION SITE

Martin D. Semsek

Environmental Management
AUG 20 2021
Office of Water Resources

Kindly be advised that this
Permit is not equivalent to a
verification of the type or extent
of freshwater wetlands on site.

**PERMITTING ONLY
NOT FOR CONSTRUCTION**

© 2021 - GZA GeoEnvironmental, Inc. GZA-A\GEO\33918.07\AH\FIGURES\CAD\CURRENT\PLANS\EXISTING CONDITIONS PLANDWG EXISTING CONDITIONS PLAN AUGUST 18, 2021 10:13AM COLLIN CAMP

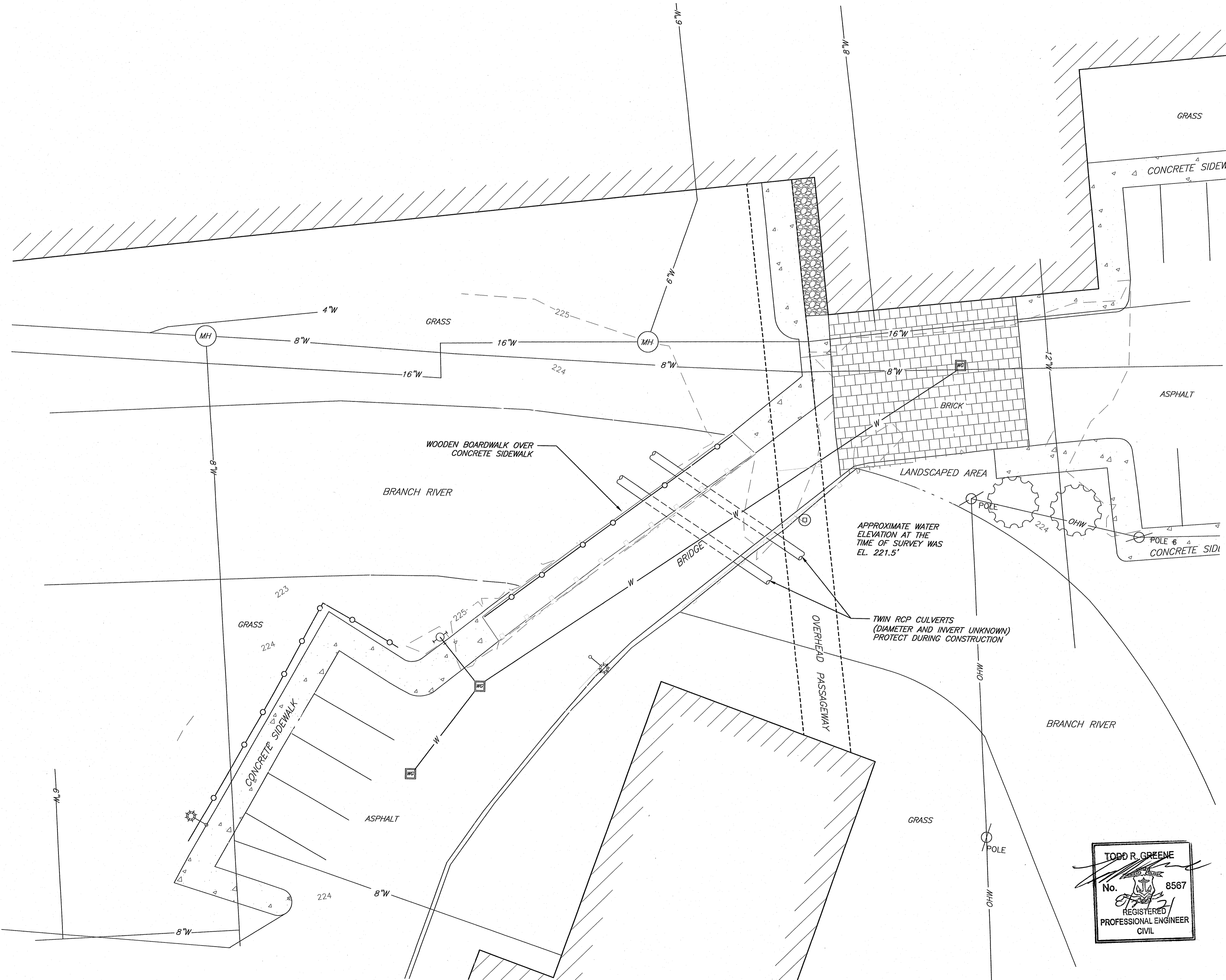

- GENERAL NOTES**
1. BASE MAP DEVELOPED FROM SURVEY DATA COLLECTED BY GZA PERSONNEL IN DECEMBER 2020 AND FROM DRAWING TITLED "EXISTING CONDITIONS SURVEY" PROVIDED TO GZA FROM VHB AND DATED AUGUST 2004. HORIZONTAL DATUM NAD83 RHODE ISLAND STATE PLAN. VERTICAL DATUM IS NORTH AMERICAN VERTICAL DATUM 1988 (NAVD88).
 2. THE LOCATIONS OF UNDERGROUND UTILITIES ARE APPROXIMATE AND SHOULD BE VERIFIED BY THE CONTRACTOR PRIOR TO CONSTRUCTION.
 3. PROJECT AREA IS IN FLOOD ZONE A PER FEMA MAP PANEL 44007C0152G, EFFECTIVE MARCH 2, 2009.

Environmental Management
AUG 20 2021
 Office of Water Resources

Kindly be advised that this Permit is not equivalent to a verification of the type or extent of freshwater wetlands on site.

LEGEND

- MANHOLE
- WATER GATE
- UTILITY POLE
- LIGHT POLE
- HYDRANT
- SUPPORT BEAM FOR OVERHEAD WALK
- WATER LINE
- FENCE
- WOODEN GUARD RAIL
- EXISTING MAJOR CONTOUR
- EXISTING MINOR CONTOUR
- CONCRETE SIDEWALK
- BRICK
- CRUSHED STONE
- WOODEN BOARDWALK

DEPARTMENT OF ENVIRONMENTAL MANAGEMENT
 OFFICE OF WATER RESOURCES
 FRESHWATER WETLANDS PROGRAM
 APPROVED WITH CONDITIONS
 AS SPECIFIED IN THE LETTER OF APPROVAL
 DATED **OCT 05 2021** FILE # **21-0207**
 NO CHANGES ALLOWED WITHOUT PRIOR APPROVAL
 APPROVED PLANS MUST BE AT CONSTRUCTION SITE
Martin D. Senack

**PERMITTING ONLY
 NOT FOR CONSTRUCTION**

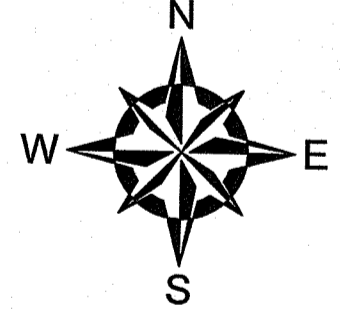

0 5' 10' 20' 30'
 SCALE IN FEET 1" = 10'

TODD R. GREENE
 No. 8567
 REGISTERED
 PROFESSIONAL ENGINEER
 CIVIL

RESPONSE TO COMMENTS	RAD	8/16/2021
NO.	ISSUE/DESCRIPTION	BY DATE
<small>UNLESS SPECIFICALLY STATED BY WRITTEN AGREEMENT, THIS DRAWING IS THE SOLE PROPERTY OF GZA GEOENVIRONMENTAL, INC. (GZA). THE INFORMATION SHOWN ON THE DRAWING IS SOLELY FOR USE BY GZA'S CLIENT OR THE CLIENT'S DESIGNATED REPRESENTATIVE FOR THE SPECIFIC PROJECT AND LOCATION IDENTIFIED ON THE DRAWING. THE DRAWING SHALL NOT BE TRANSFERRED, REUSED, COPIED, OR ALTERED IN ANY MANNER FOR USE AT ANY OTHER LOCATION OR FOR ANY OTHER PURPOSE WITHOUT THE PRIOR WRITTEN CONSENT OF GZA. ANY TRANSFER, REUSE, OR MODIFICATION TO THE DRAWING BY THE CLIENT OR OTHERS, WITHOUT THE PRIOR WRITTEN EXPRESS CONSENT OF GZA, WILL BE AT THE USER'S SOLE RISK AND WITHOUT ANY RISK OR LIABILITY TO GZA.</small>		
EMBANKMENT BRIDGE REPLACEMENT DESIGN SLATER MILL RESIDENCES SLATERSVILLE, RHODE ISLAND		
EXISTING CONDITIONS PLAN		
PREPARED BY: GZA GeoEnvironmental, Inc. Engineers and Scientists www.gza.com	PREPARED FOR: RESIDENCES AT SLATER MILL, LLC	
PROJ MGR: AH	REVIEWED BY: TRG	CHECKED BY: EAS
DESIGNED BY: RAD	DRAWN BY: CMC	SCALE: AS NOTED
DATE: AUGUST 2021	PROJECT NO. 33918.07	REVISION NO. 0
		SHEET 2 SHEET NO. 2 OF 7

© 2021 - GZA GeoEnvironmental, Inc. GZA-J:\GEO\33918.07\AH\FIGURES\AO\CURRENT PLANS\SOIL EROSION AND SEDIMENT CONTROL PLAN.DWG SOIL EROSION AND SEDIMENT CONTROL PLAN AUGUST 18, 2021 10:14AM COLLIN CAMP

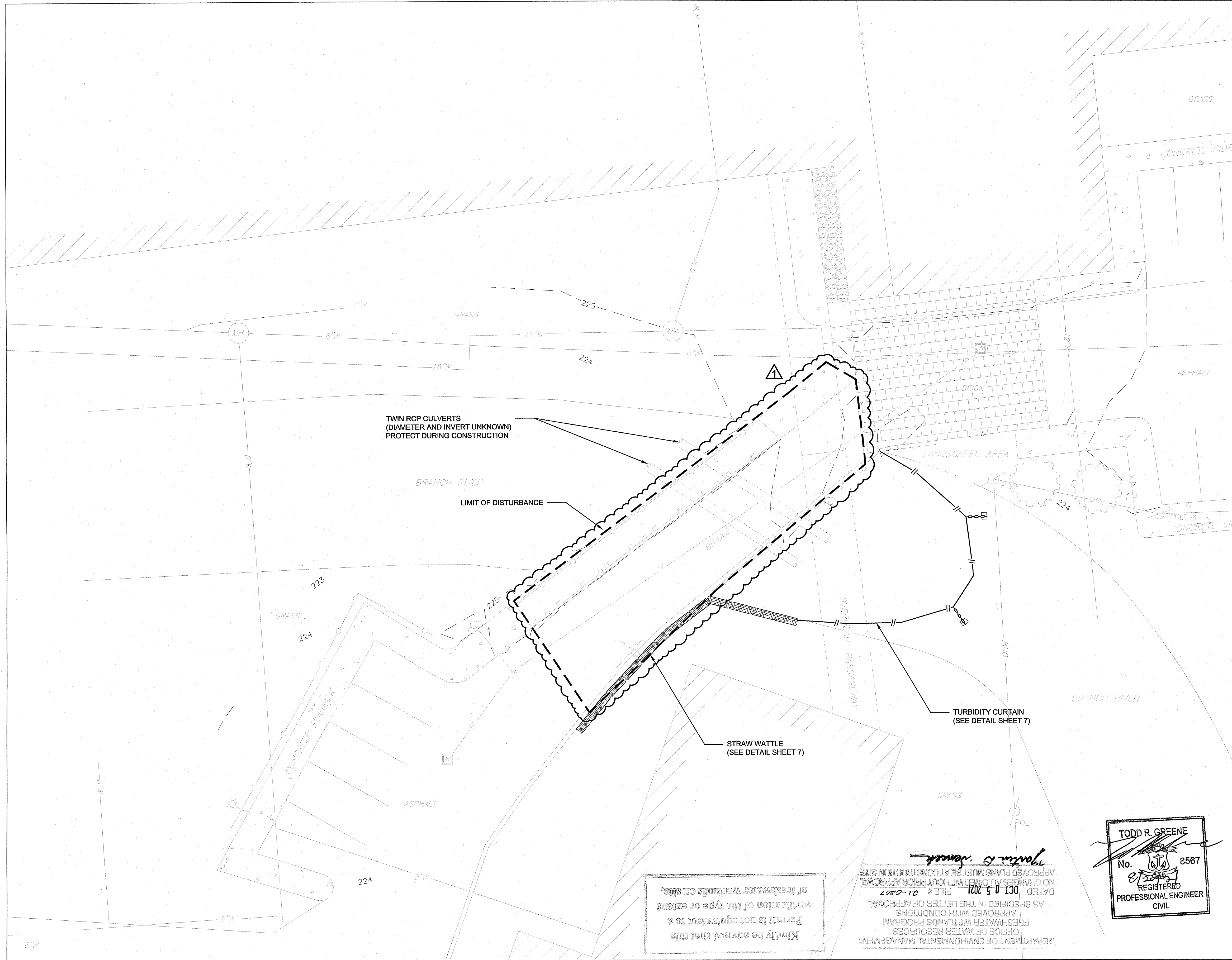

- GENERAL NOTES**
1. BASE MAP DEVELOPED FROM SURVEY DATA COLLECTED BY GZA PERSONNEL IN DECEMBER 2020 AND FROM DRAWING TITLED "EXISTING CONDITIONS SURVEY" PROVIDED TO GZA FROM VHB AND DATED AUGUST 2004.
 2. THE CHANNEL BANKS WILL NOT BE DISTURBED AS PART OF THE PROPOSED REPAIR. EARTHWORK EQUIPMENT WILL ACCESS THE EMBANKMENT BRIDGE FROM THE EXISTING PAVED ROADWAYS.
 3. NO WORK OR EQUIPMENT STAGING WILL OCCUR WITHIN THE CHANNEL.

Office of Water Resources
 Environmental Management
 AUG 20 2021

- LEGEND**
- MANHOLE
 - WATER GATE
 - UTILITY POLE
 - LIGHT POLE
 - HYDRANT
 - SUPPORT BEAM FOR OVERHEAD WALK
 - WATER LINE
 - FENCE
 - WOODEN GUARD RAIL
 - EXISTING MAJOR CONTOUR
 - EXISTING MINOR CONTOUR
 - CONCRETE SIDEWALK
 - BRICK
 - CRUSHED STONE
 - WOODEN BOARDWALK
 - PROPOSED STRAW WATTLES EROSION CONTROL
 - PROPOSED TURBIDITY CURTAIN
 - APPROXIMATE LIMIT OF DISTURBANCE

**PERMITTING ONLY
 NOT FOR CONSTRUCTION**

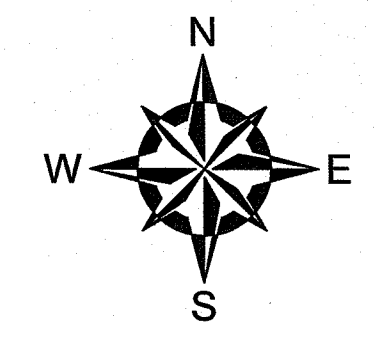

0 5' 10' 20' 30'
 SCALE IN FEET 1" = 10'

NO.	RESPONSE TO COMMENTS	RAD	8/16/2021
NO.	ISSUE/DESCRIPTION	BY	DATE

UNLESS SPECIFICALLY STATED BY WRITTEN AGREEMENT, THIS DRAWING IS THE SOLE PROPERTY OF GZA GEON ENVIRONMENTAL, INC. (GZA). THE INFORMATION SHOWN ON THE DRAWING IS SOLELY FOR USE BY GZA'S CLIENT OR THE CLIENT'S DESIGNATED REPRESENTATIVE FOR THE SPECIFIC PROJECT AND LOCATION IDENTIFIED ON THE DRAWING. THE DRAWING SHALL NOT BE TRANSFERRED, REUSED, COPIED, OR ALTERED IN ANY MANNER FOR USE AT ANY OTHER LOCATION OR FOR ANY OTHER PURPOSE WITHOUT THE PRIOR WRITTEN CONSENT OF GZA. ANY TRANSFER, REUSE, OR MODIFICATION TO THE DRAWING BY THE CLIENT OR OTHERS, WITHOUT THE PRIOR WRITTEN EXPRESS CONSENT OF GZA, WILL BE AT THE USER'S SOLE RISK AND WITHOUT ANY RISK OR LIABILITY TO GZA.

**EMBANKMENT BRIDGE REPLACEMENT DESIGN
 SLATER MILL RESIDENCES
 SLATERSVILLE, RHODE ISLAND**

SOIL EROSION AND SEDIMENT CONTROL PLAN

PREPARED BY: **GZA GeoEnvironmental, Inc.**
 Engineers and Scientists
 www.gza.com

PREPARED FOR: **RESIDENCES AT SLATER MILL, LLC**

PROJ MGR: AH	DESIGNED BY: RAD	REVIEWED BY: TRG	CHECKED BY: EAS	SHEET
DATE: AUGUST 2021	DRAWN BY: CMC	PROJECT NO: 33918.07	SCALE: AS NOTED	3
			REVISION NO: 0	SHEET NO. 3 OF 7

Kindly be advised that this
 Permit is not equivalent to a
 verification of the type or extent
 of freshwater wetlands on site.

DEPARTMENT OF ENVIRONMENTAL MANAGEMENT
 OFFICE OF WATER RESOURCES
 FRESHWATER WETLANDS PROGRAM
 APPROVED WITH CONDITIONS
 AS SPECIFIED IN THE LETTER OF APPROVAL
 DATED OCT 05 2021 FILE # 21-0001
 NO CHANGES ALLOWED WITHOUT PRIOR APPROVAL
 APPROVED PLANS MUST BE AT CONSTRUCTION SITE

TODD R. GREENE
 No. 8567
 REGISTERED
 PROFESSIONAL ENGINEER
 CIVIL

© 2021 - GZA GeoEnvironmental, Inc. GZA-1\GEO\3918.07\AN\FIGURES\CAD\CURRENT\PLANS\DEMOLITION PLAN AUGUST 18, 2021 10:15AM COLLIN CAMP

GENERAL NOTES

1. BASE MAP DEVELOPED FROM SURVEY DATA COLLECTED BY GZA PERSONNEL IN DECEMBER 2020 AND FROM DRAWING TITLED "EXISTING CONDITIONS SURVEY" PROVIDED TO GZA FROM VHB AND DATED AUGUST 2004.

Environmental Management
AUG 20 2021
 Office of Water Resources

LEGEND

- MANHOLE
- WATER GATE
- UTILITY POLE
- LIGHT POLE
- HYDRANT
- WATER LINE
- FENCE
- WOODEN GUARD RAIL
- EXISTING MAJOR CONTOUR
- EXISTING MINOR CONTOUR
- CONCRETE SIDEWALK
- BRICK
- CRUSHED STONE
- WOODEN BOARDWALK
- INDICATES PROPOSED LOCATION OF SAW CUT IN PAVEMENT
- APPROXIMATE LIMIT OF DISTURBANCE

DEPARTMENT OF ENVIRONMENTAL MANAGEMENT
 OFFICE OF WATER RESOURCES
 FRESHWATER WETLANDS PROGRAM
 APPROVED WITH CONDITIONS
 AS SPECIFIED IN THE LETTER OF APPROVAL
 DATED **OCT 05 2021** FILE # **21-0307**
 NO CHANGES ALLOWED WITHOUT PRIOR APPROVAL
 APPROVED PLANS MUST BE AT CONSTRUCTION SITE
Martin B. Wenczek

Kindly be advised that this Permit is not equivalent to a verification of the type or extent of freshwater wetlands on site.

**PERMITTING ONLY
 NOT FOR CONSTRUCTION**

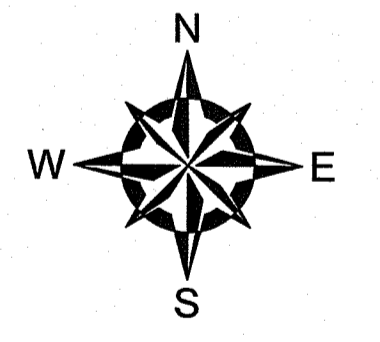

0 5' 10' 20' 30'
 SCALE IN FEET 1" = 10'

NO.	RESPONSE TO COMMENTS	RAD	8/16/2021
NO.	ISSUE/DESCRIPTION	BY	DATE

UNLESS SPECIFICALLY STATED BY WRITTEN AGREEMENT, THIS DRAWING IS THE SOLE PROPERTY OF GZA GEOENVIRONMENTAL, INC. (GZA). THE INFORMATION SHOWN ON THE DRAWING IS SOLELY FOR USE BY GZA'S CLIENT OR THE CLIENT'S DESIGNATED REPRESENTATIVE FOR THE SPECIFIC PROJECT AND LOCATION IDENTIFIED ON THE DRAWING. THE DRAWING SHALL NOT BE TRANSFERRED, REUSED, COPIED, OR ALTERED IN ANY MANNER FOR USE AT ANY OTHER LOCATION OR FOR ANY OTHER PURPOSE WITHOUT THE PRIOR WRITTEN CONSENT OF GZA. ANY TRANSFER, REUSE, OR MODIFICATION TO THE DRAWING BY THE CLIENT OR OTHERS, WITHOUT THE PRIOR WRITTEN EXPRESS CONSENT OF GZA, WILL BE AT THE USER'S SOLE RISK AND WITHOUT ANY RISK OR LIABILITY TO GZA.

**EMBANKMENT BRIDGE REPLACEMENT DESIGN
 SLATER MILL RESIDENCES
 SLATERSVILLE, RHODE ISLAND**

DEMOLITION PLAN

PREPARED BY: GZA GeoEnvironmental, Inc. Engineers and Scientists www.gza.com	PREPARED FOR: RESIDENCES AT SLATER MILL, LLC
PROJ MGR: AH DESIGNED BY: RAD DATE: AUGUST 2021	REVIEWED BY: TRG DRAWN BY: CMC PROJECT NO.: 33918.07
CHECKED BY: EAS SCALE: AS NOTED REVISION NO.: 0	SHEET 4 SHEET NO. 4 OF 7

TODD R. GREENE
 No. **8567**
 REGISTERED
 PROFESSIONAL ENGINEER
 CIVIL

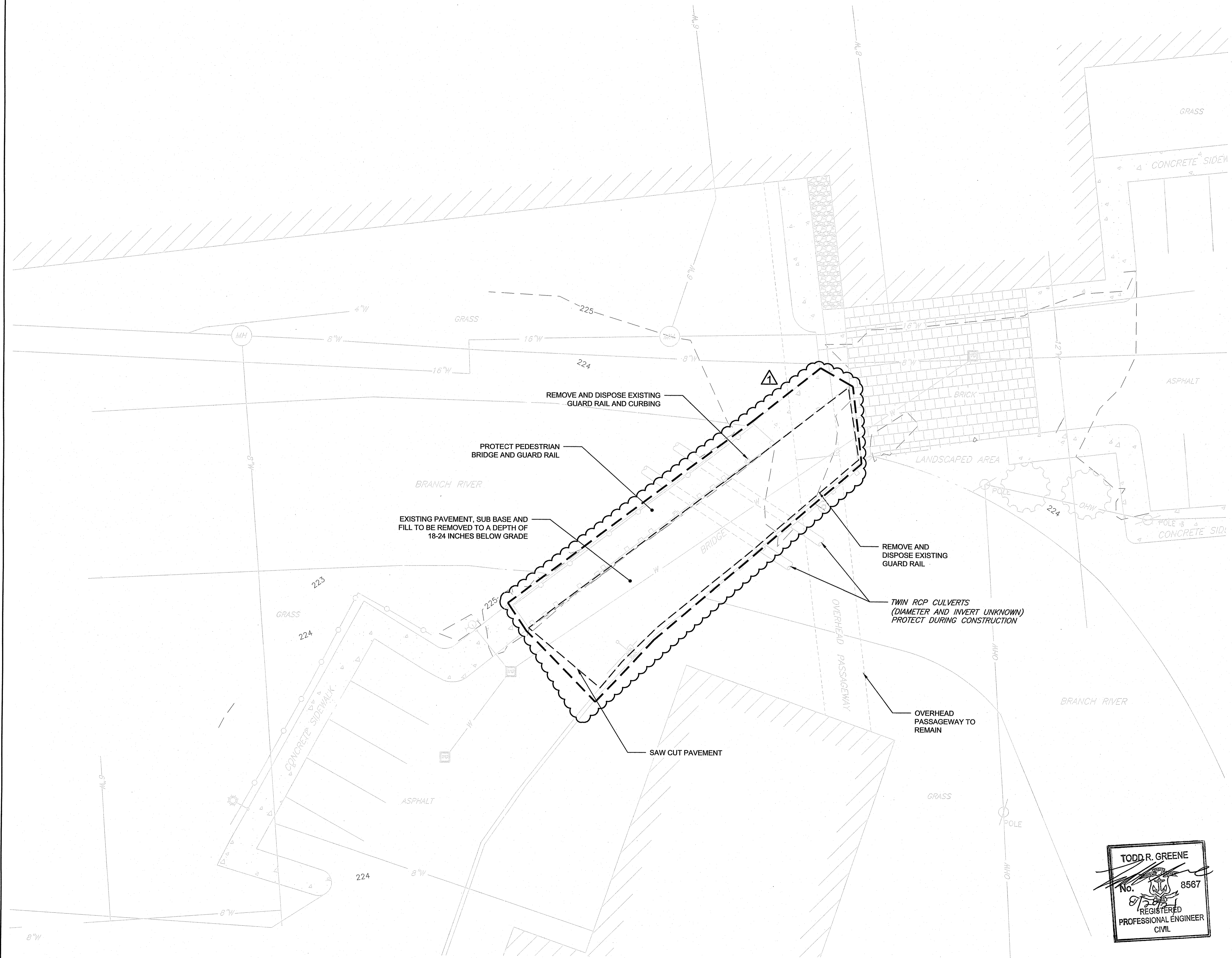

© 2021 - GZA GeoEnvironmental, Inc. GZA-J:\GEO\33918.07\4\FIGURES\DWG\CURRENT\PLANS\WATER CONTROL PLAN.DWG 5 WATER CONTROL PLAN AUGUST 18, 2021 10:18AM COLLIN CAMP

GENERAL NOTES

1. BASE MAP DEVELOPED FROM SURVEY DATA COLLECTED BY GZA PERSONNEL IN DECEMBER 2020 AND FROM DRAWING TITLED "EXISTING CONDITIONS SURVEY" PROVIDED TO GZA FROM VHB AND DATED AUGUST 2004.
2. THE LOCATIONS OF UNDERGROUND UTILITIES ARE APPROXIMATE AND SHOULD BE VERIFIED BY THE CONTRACTOR PRIOR TO CONSTRUCTION.

Environmental Management
AUG 20 2021
 Office of Water Resources

DEPARTMENT OF ENVIRONMENTAL MANAGEMENT
 OFFICE OF WATER RESOURCES
 FRESHWATER WETLANDS PROGRAM
 APPROVED WITH CONDITIONS
 AS SPECIFIED IN THE LETTER OF APPROVAL
 DATED **OCT 05 2021** FILE # **81-0207**
 (NO CHANGES ALLOWED WITHOUT PRIOR APPROVAL)
 APPROVED PLANS MUST BE AT CONSTRUCTION SITE
Yvonne D. Wenczek

LEGEND

- MANHOLE
- WATER GATE
- UTILITY POLE
- LIGHT POLE
- HYDRANT
- SUPPORT BEAM FOR OVERHEAD WALK
- WATER LINE
- FENCE
- WOODEN GUARD RAIL
- EXISTING MAJOR CONTOUR
- EXISTING MINOR CONTOUR

Kindly be advised that this Permit is not equivalent to a verification of the type or extent of freshwater wetlands on site.

TODD R. GREENE
 No. 8567
 REGISTERED PROFESSIONAL ENGINEER
 CIVIL

**PERMITTING ONLY
 NOT FOR CONSTRUCTION**

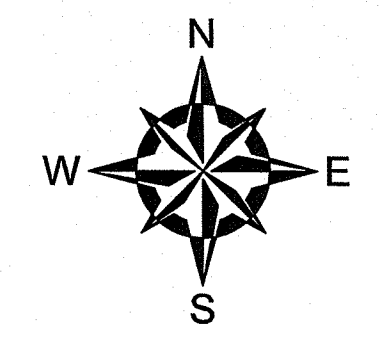

0 20' 40' 80' 120'
 SCALE IN FEET 1" = 40'

NO.	RESPONSE TO COMMENTS	BY	DATE
	RESPONSE TO COMMENTS	RAD	8/16/2021
	ISSUE/DESCRIPTION		

UNLESS SPECIFICALLY STATED BY WRITTEN AGREEMENT, THIS DRAWING IS THE SOLE PROPERTY OF GZA GEOENVIRONMENTAL, INC. (GZA). THE INFORMATION SHOWN ON THE DRAWING IS SOLELY FOR USE BY GZA'S CLIENT OR THE CLIENT'S DESIGNATED REPRESENTATIVE FOR THE SPECIFIC PROJECT AND LOCATION IDENTIFIED ON THE DRAWING. THE DRAWING SHALL NOT BE TRANSFERRED, REUSED, COPIED, OR ALTERED IN ANY MANNER FOR USE AT ANY OTHER LOCATION OR FOR ANY OTHER PURPOSE WITHOUT THE PRIOR WRITTEN CONSENT OF GZA. ANY TRANSFER, REUSE, OR MODIFICATION TO THE DRAWING BY THE CLIENT OR OTHERS, WITHOUT THE PRIOR WRITTEN EXPRESS CONSENT OF GZA, WILL BE AT THE USER'S SOLE RISK AND WITHOUT ANY RISK OR LIABILITY TO GZA.

**EMBANKMENT BRIDGE REPLACEMENT DESIGN
 SLATERS MILL RESIDENCES
 SLATERSVILLE, RHODE ISLAND**

WATER CONTROL PLAN

PREPARED BY: GZA GeoEnvironmental, Inc. Engineers and Scientists www.gza.com	PREPARED FOR: RESIDENCES AT SLATERS MILL, LLC
PROJ MGR: AH DESIGNED BY: RAD DATE: AUGUST 2021	REVIEWED BY: TRG DRAWN BY: CMC PROJECT NO. 33918.07
CHECKED BY: EAS SCALE: AS NOTED REVISION NO. 0	SHEET 5 SHEET NO. 5 OF 7

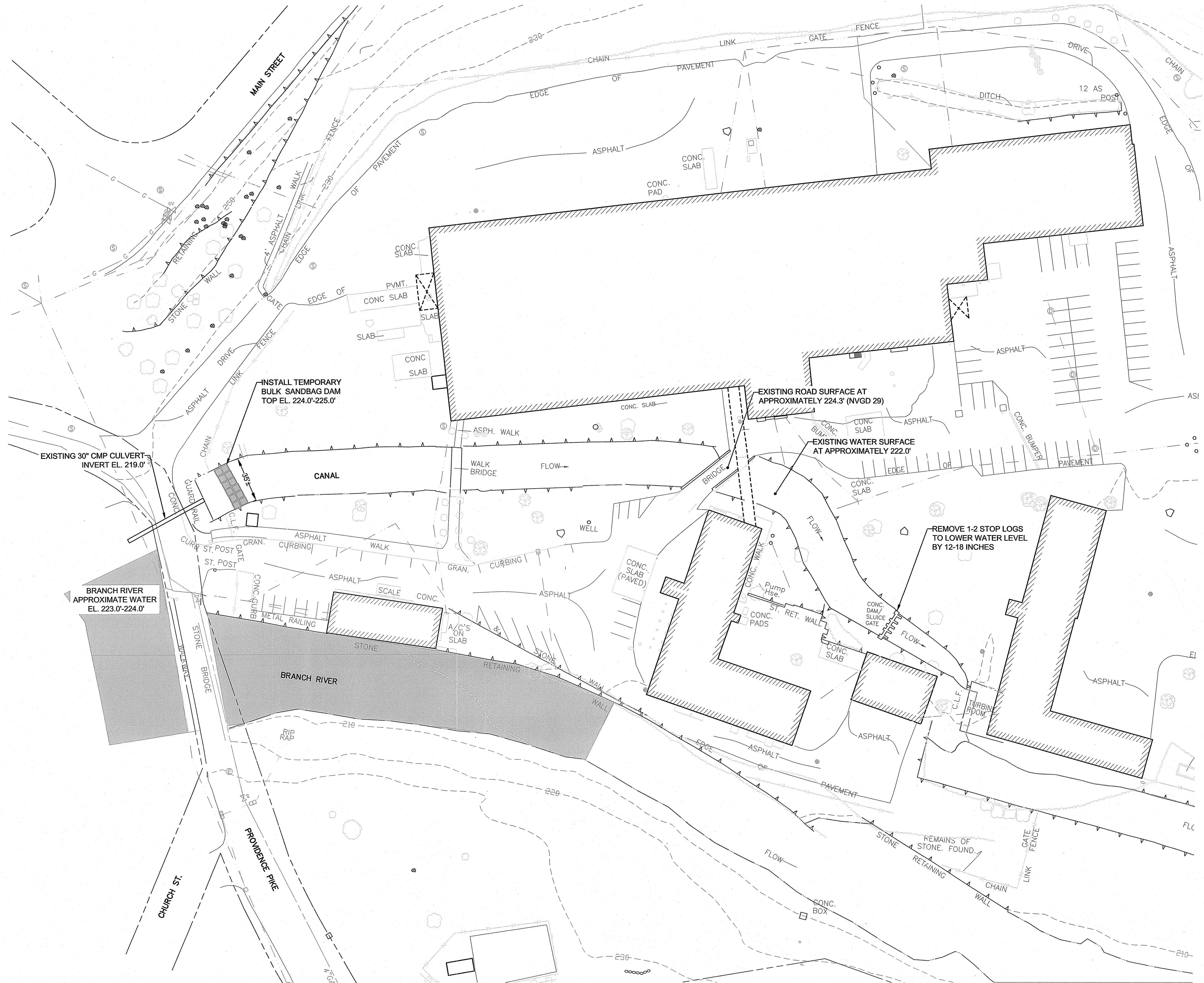

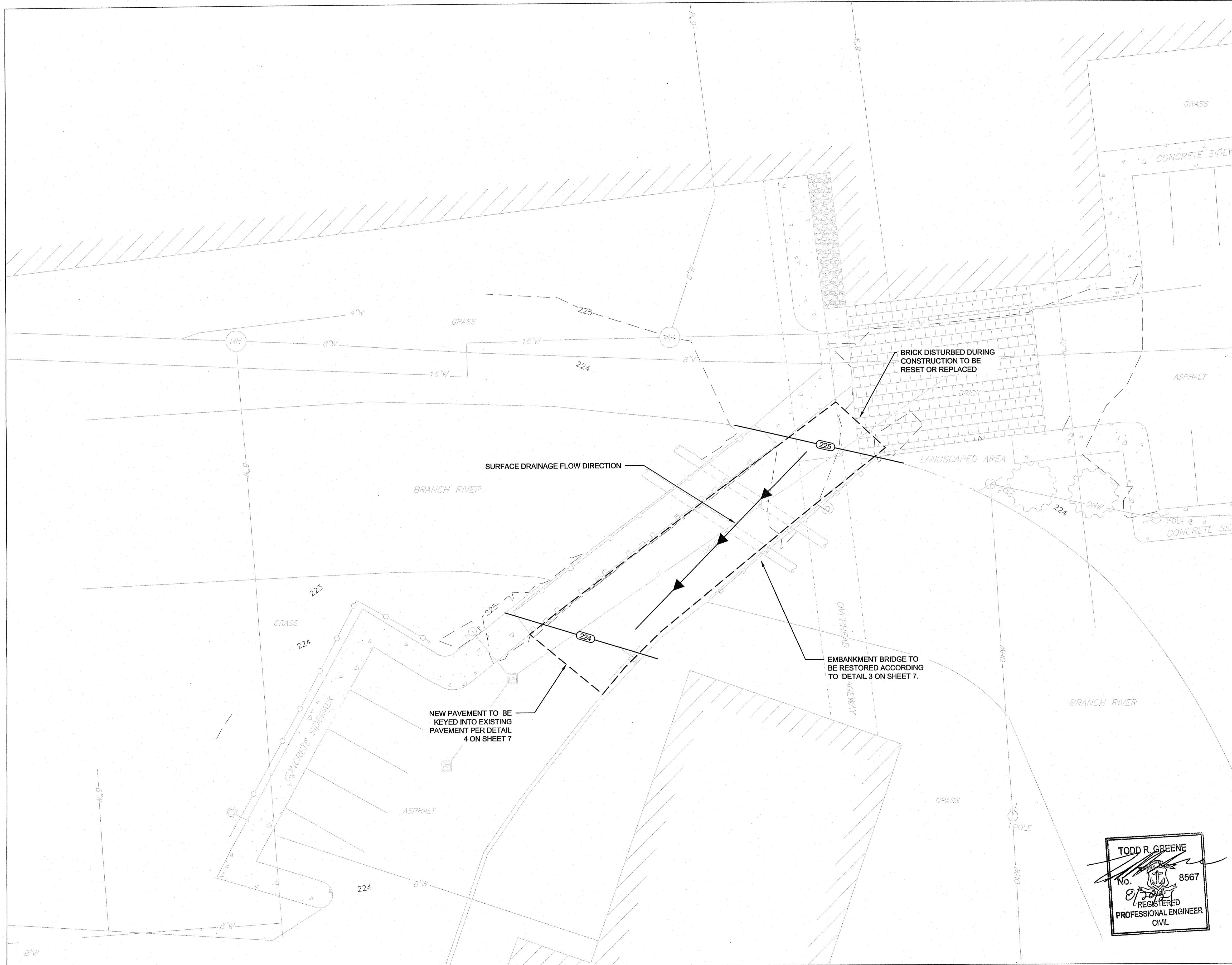

GENERAL NOTES

1. BASE MAP DEVELOPED FROM SURVEY DATA COLLECTED BY GZA PERSONNEL IN DECEMBER 2020 AND FROM DRAWING TITLED "EXISTING CONDITIONS SURVEY" PROVIDED TO GZA FROM VHB AND DATED AUGUST 2004.
2. ANY DISTURBANCE OR DAMAGE CAUSED BY CONSTRUCTION ACTIVITIES TO UTILITIES, SIDEWALKS, LANDSCAPED AREAS OR EXISTING PAVEMENTS SHALL BE REPAIR OR REPLACED BY THE CONTRACTOR AT THE CONCLUSION OF THE PROJECT.

Environmental Management
AUG 20 2021
Office of Water Resources

LEGEND

- MANHOLE
- WATER GATE
- UTILITY POLE
- LIGHT POLE
- HYDRANT
- WATER LINE
- FENCE
- WOODEN GUARD RAIL
- EXISTING MAJOR CONTOUR
- EXISTING MINOR CONTOUR
- CONCRETE SIDEWALK
- BRICK
- CRUSHED STONE
- WOODEN BOARDWALK
- PROPOSED CONTOUR

Kindly be advised that this Permit is not equivalent to a verification of the type or extent of freshwater wetlands on site.

DEPARTMENT OF ENVIRONMENTAL MANAGEMENT
OFFICE OF WATER RESOURCES
FRESHWATER WETLANDS PROGRAM
APPROVED WITH CONDITIONS
AS SPECIFIED IN THE LETTER OF APPROVAL
DATED **OCT 05 2021** FILE # **20-0207**
NO CHANGES ALLOWED WITHOUT PRIOR APPROVAL
APPROVED PLANS MUST BE AT CONSTRUCTION SITE

Tina D. Somack

**PERMITTING ONLY
NOT FOR CONSTRUCTION**

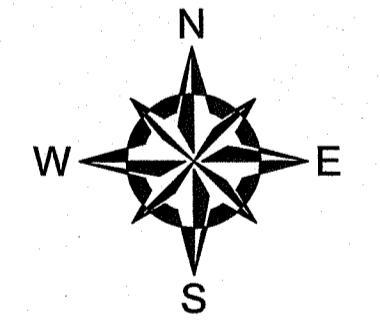

0 5' 10' 20' 30'
SCALE IN FEET 1" = 10'

NO.	ISSUE/DESCRIPTION	BY	DATE
1	RESPONSE TO COMMENTS	RAD	8/16/2021

UNLESS SPECIFICALLY STATED BY WRITTEN AGREEMENT, THIS DRAWING IS THE SOLE PROPERTY OF GZA GEOENVIRONMENTAL, INC. (GZA). THE INFORMATION SHOWN ON THE DRAWING IS SOLELY FOR USE BY GZA'S CLIENT OR THE CLIENT'S DESIGNATED REPRESENTATIVE FOR THE SPECIFIC PROJECT AND LOCATION IDENTIFIED ON THE DRAWING. THE DRAWING SHALL NOT BE TRANSFERRED, REUSED, COPIED, OR ALTERED IN ANY MANNER FOR USE AT ANY OTHER LOCATION OR FOR ANY OTHER PURPOSE WITHOUT THE PRIOR WRITTEN CONSENT OF GZA. ANY TRANSFER, REUSE, OR MODIFICATION TO THE DRAWING BY THE CLIENT OR OTHERS, WITHOUT THE PRIOR WRITTEN EXPRESS CONSENT OF GZA, WILL BE AT THE USER'S SOLE RISK AND WITHOUT ANY RISK OR LIABILITY TO GZA.

**EMBANKMENT BRIDGE REPLACEMENT DESIGN
SLATER MILL RESIDENCES
SLATERSVILLE, RHODE ISLAND**

SITE RESTORATION PLAN

TODD R. GREENE
No. 8567
REGISTERED
PROFESSIONAL ENGINEER
CIVIL

PREPARED BY: GZA GeoEnvironmental, Inc. Engineers and Scientists www.gza.com	PREPARED FOR: RESIDENCES AT SLATER MILL, LLC
PROJ MGR: AH REVIEWED BY: TRG CHECKED BY: EAS SHEET DESIGNED BY: RAD DRAWN BY: CMC SCALE: AS NOTED 6 DATE: AUGUST 2021 PROJECT NO. 33918.07 REVISION NO. 0 SHEET NO. 6 OF 7	

Environmental Management
 AUG 20 2021
 Office of Water Resources

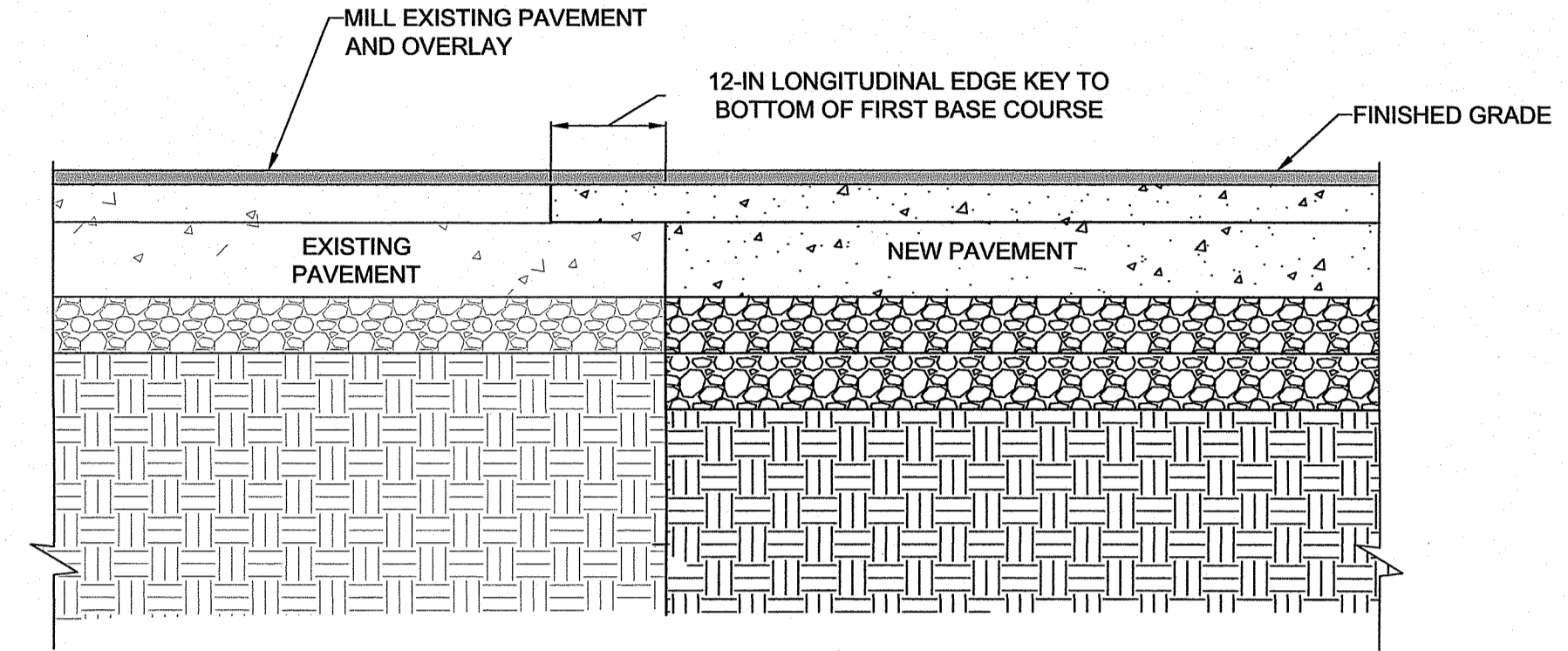
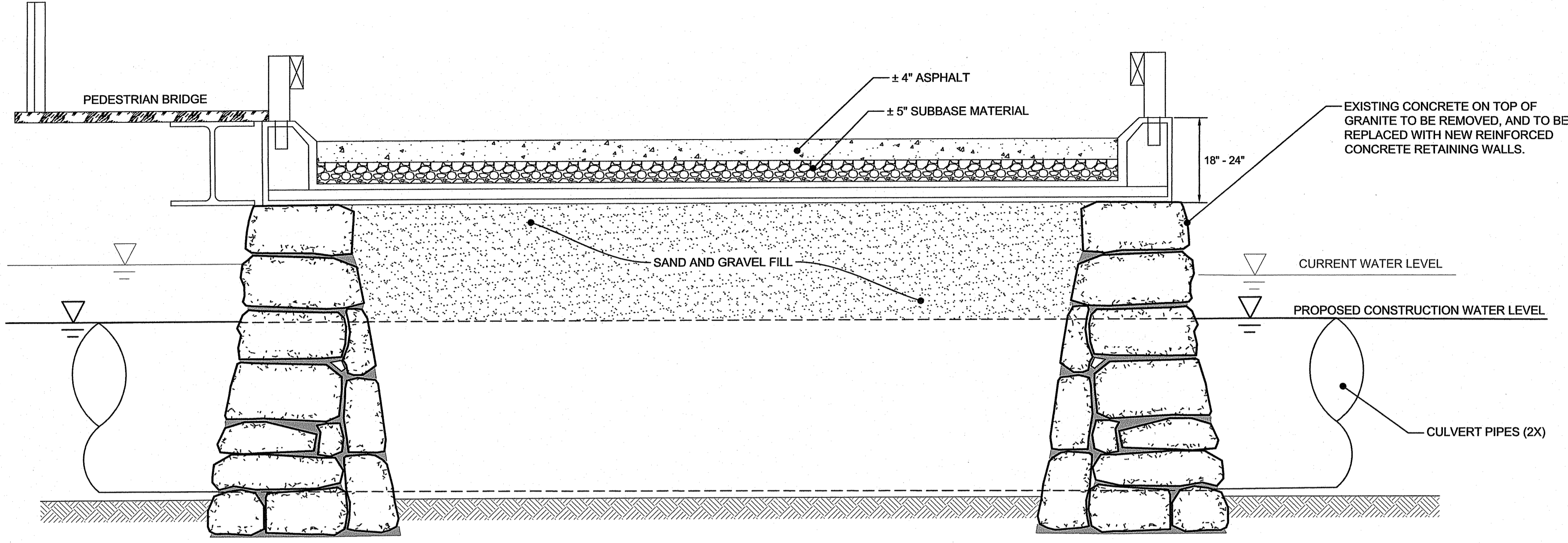

TYPICAL PAVEMENT KEY DETAIL
 NOT TO SCALE

SCHEMATIC REPAIR - TYPICAL SECTION

REPAIR PROCEDURE:

1. EXCAVATE AND REMOVE ALL MATERIALS TO APPROXIMATE TOP OF WATER
2. REVIEW SUBGRADE CONDITIONS
3. FILL ANY VOIDS OR WEAK AREAS WITH PROCESSED GRAVEL. OR PERFORM COMPACTION GROUTING PER ENGINEERS REVIEW. THEN SURFACE-COMPACT THE INTERIM SUBGRADE. PLACE NEW BACKFILL AND COMPACT MATERIAL UP TO BOTTOM OF CONCRETE
4. INSTALL REINFORCED CONCRETE SLAB
5. INSTALL REINFORCED CONCRETE SIDEWALLS WITH EMBEDDED GUARDRAIL ANCHOR BOLTS

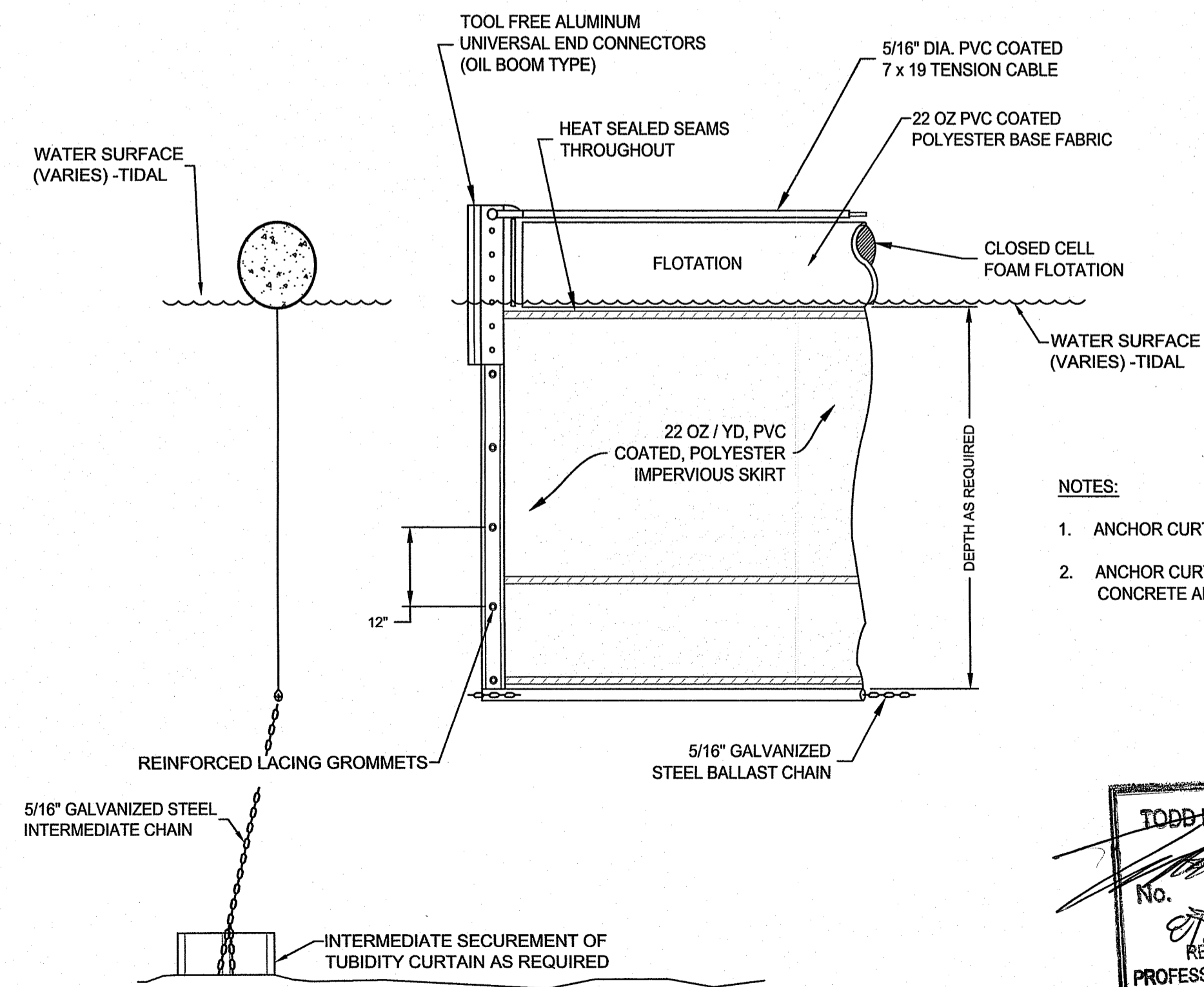

TURBIDITY CURTAIN DETAIL
 NOT TO SCALE

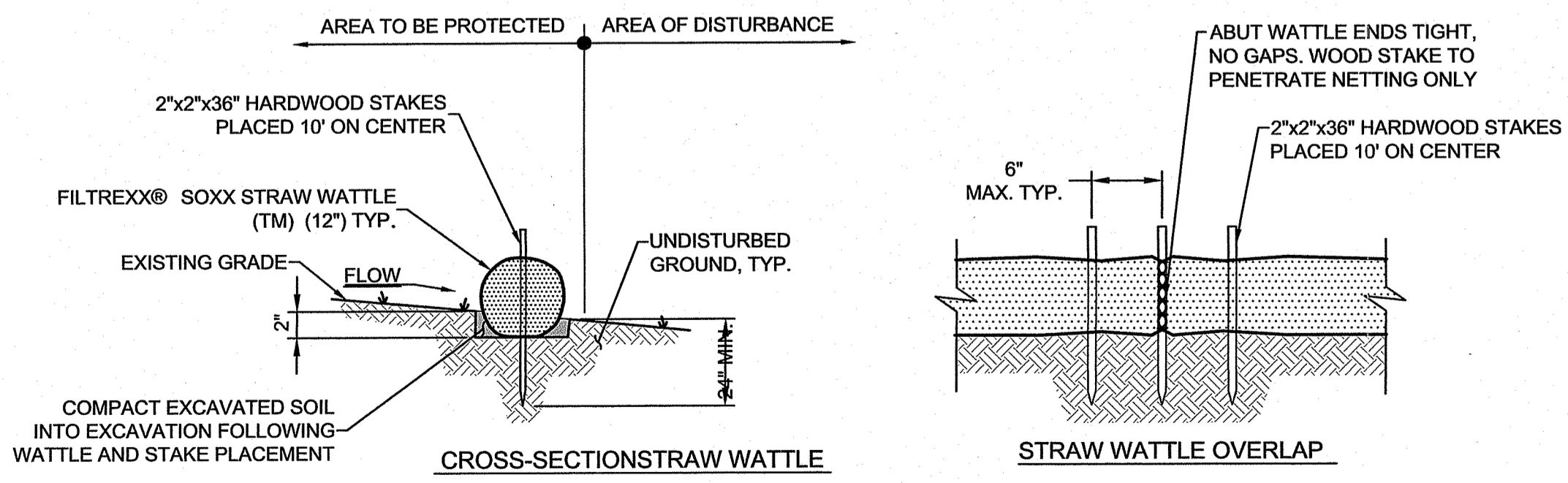

STRAW WATTLE DETAIL
 NOT TO SCALE

DEPARTMENT OF ENVIRONMENTAL MANAGEMENT
 OFFICE OF WATER RESOURCES
 FRESHWATER WETLANDS PROGRAM
 APPROVED WITH CONDITIONS
 AS SPECIFIED IN THE LETTER OF APPROVAL
 DATED OCT 05 2021 FILE # 20-0207
 NO CHANGES ALLOWED WITHOUT PRIOR APPROVAL
 APPROVED PLANS MUST BE AT CONSTRUCTION SITE
Martin D. Senczek

PERMITTING ONLY
 NOT FOR CONSTRUCTION

- NOTES:
1. ANCHOR CURTAIN ENDS AS INDICATED ON PL
 2. ANCHOR CURTAIN AT INTERMEDIATE POINTS 1 CONCRETE ANCHOR BLOCKS. SEE PLAN VIEW

TODD R. GREENE
 No. 8567
 REGISTERED
 PROFESSIONAL ENGINEER
 CIVIL

NO.	RESPONSE TO COMMENTS	ISSUE/DESCRIPTION	RAD	8/16/2021

UNLESS SPECIFICALLY STATED BY WRITTEN AGREEMENT, THIS DRAWING IS THE SOLE PROPERTY OF GZA GEOENVIRONMENTAL, INC. (GZA). THE INFORMATION SHOWN ON THE DRAWING IS SOLELY FOR USE BY GZA'S CLIENT OR THE CLIENT'S DESIGNATED REPRESENTATIVE FOR THE SPECIFIC PROJECT AND LOCATION IDENTIFIED ON THE DRAWING. THE DRAWING SHALL NOT BE TRANSFERRED, REUSED, COPIED, OR ALTERED IN ANY MANNER FOR USE AT ANY OTHER LOCATION OR FOR ANY OTHER PURPOSE WITHOUT THE PRIOR WRITTEN CONSENT OF GZA. ANY TRANSFER, REUSE, OR MODIFICATION TO THE DRAWING BY THE CLIENT OR OTHERS, WITHOUT THE PRIOR WRITTEN EXPRESS CONSENT OF GZA, WILL BE AT THE USER'S SOLE RISK AND WITHOUT ANY RISK OR LIABILITY TO GZA.

**EMBANKMENT BRIDGE REPLACEMENT DESIGN
 SLATER MILL RESIDENCES
 SLATERSVILLE, RHODE ISLAND**

CONSTRUCTION DETAILS AND SPECIFICATIONS

PREPARED BY: GZA GeoEnvironmental, Inc. Engineers and Scientists www.gza.com	PREPARED FOR: RESIDENCES AT SLATER MILL, LLC
PROJ MGR: AH DESIGNED BY: RAD DATE: JUNE 2021	REVIEWED BY: TRG DRAWN BY: CMC PROJECT NO. 33918.07
CHECKED BY: EAS SCALE: AS NOTED REVISION NO. 0	SHEET 7 SHEET NO. 7 OF 7