

- PLAN NOTES:**
- EXISTING CONDITIONS AND TOPOGRAPHY ARE THE RESULT OF A FIELD SURVEY BY SOUTH COUNTY SURVEY COMPANY, LLC BETWEEN JULY AND NOVEMBER 2019.
 - NORTH ARROW REFERENCES GRID NORTH (RI SPC ZONE 3800).
 - ELEVATIONS REFERENCE THE NORTH AMERICAN VERTICAL DATUM OF 1988 (NAVD 88).
 - HORIZONTAL AND VERTICAL DATUMS ESTABLISHED BY GNSS STATIC OBSERVATIONS ON JULY 12, 2019, AND OPUS SOLUTIONS FOR POST-PROCESSING (EPOCH 2019-5279).
 - WETLAND EDGES DELINEATED AND FLAGGED BY NATURAL RESOURCE SERVICES, INC. IN MARCH, 2019 AND FIELD LOCATED BY SOUTH COUNTY SURVEY COMPANY, LLC.
 - SUBJECT PARCEL IS LOCATED IN THE RESIDENTIAL A (RA) ZONING DISTRICT.
 - FEMA SPECIAL FLOOD HAZARD AREA (SFHA) DELINEATION BY GRAPHIC PLOTTING ONLY. LINE TAKEN FROM RIGIS DATA AND OVERLAID ON COMMON COORDINATE SYSTEM (RI SPC ZONE 3800).
 - THIS COMPILATION PLAN HAS BEEN PREPARED FROM SOURCES OF INFORMATION AND DATA WHOSE POSITIONAL ACCURACY AND RELIABILITY HAS NOT BEEN VERIFIED. THE PROPERTY LINES DEPICTED HEREON DO NOT REPRESENT A BOUNDARY OPINION, AND OTHER INFORMATION DEPICTED IS SUBJECT TO SUCH CHANGES AS AN AUTHORITY FIELD SURVEY MAY DISCLOSE.
 - ALL UNDERGROUND UTILITIES SHOWN ON THIS PLAN HAVE BEEN LOCATED FROM FIELD SURVEY INFORMATION AND EXISTING PLANS. THE SURVEYOR MAKES NO GUARANTEE THAT THE UNDERGROUND UTILITIES COMPRISE ALL SUCH UTILITIES IN THE AREA, EITHER IN SERVICE OR ABANDONED. THE SURVEYOR DOES NOT WARRANT THAT THE UNDERGROUND UTILITIES SHOWN ARE IN THE EXACT LOCATION INDICATED ALTHOUGH THEY ARE LOCATED AS ACCURATELY AS POSSIBLE FROM AVAILABLE INFORMATION. PLEASE CONTACT DIGSAFE PRIOR TO CONSTRUCTION AT 1-888-344-7233, AND/OR ALL LOCAL UTILITY COMPANIES.

- PLAN REFERENCES:**
- SEE "PLAN OF LAND PREPARED FOR SHERMAN M. & PEGGY R. BULL ASSESSOR'S PLAT 3 LOT 86-1 OFF CORN NECK ROAD NEW SHOREHAM, RHODE ISLAND. SCALE: 1"=40' LAST REVISED MARCH 6, 1998, BY RICHARD A. GREENE & ASSOCIATES, INC.
 - SEE "PLAN OF SUBDIVISION ON NEW SHOREHAM, FOR SIDNEY D. JR. AND SARAH S. PINNEY PREPARED BY STANLEY ENGINEERING, INC. SCALE: 1"=40' NOVEMBER, 1980".

DEPARTMENT OF ENVIRONMENTAL MANAGEMENT
 OFFICE OF WATER RESOURCES
 FRESHWATER WETLANDS PROGRAM
 REVIEWED SITE PLAN APPLICATION NO.: 21-023
 DATED SEP 22 2021
 SEE LETTER OF SAME DATE.

Nancy L. Freeman

Kindly be advised that this
 Permit is not equivalent to a
 verification of the type or extent
 of freshwater wetlands on site.

EROSION AND SEDIMENT CONTROL NOTES

- TEMPORARY AND/OR PERMANENT EROSION CONTROL DEVICES SUCH AS BAILED HAY, SILT FENCING, ETC. SHALL BE INSTALLED PRIOR TO ANY CLEARING OR EXCAVATION. HAY BALES OR SILT FENCING SHALL BE PLACED IMMEDIATELY DOWN SLOPE AND ADJOINING AREAS OF SOIL DISTURBANCE AND STOCK PILES. INSTALLATION OF ALL EROSION CONTROL DEVICES SHALL BE CONDUCTED IN ACCORDANCE TO DETAIL SPECIFICATIONS.
- CLEARING OF EXISTING VEGETATION SHALL BE DONE IN A CONTROLLED MANNER SO AS TO AVOID EXTENSIVE AREAS OF DEFOLIATED TERRAIN SUBJECT TO EROSION. AREAS SO DISTURBED SHALL BE BROUGHT TO FINAL GRADES AND STABILIZED AS SOON AS POSSIBLE.
- DURING CONSTRUCTION THE CONTRACTOR SHALL BE RESPONSIBLE FOR MAINTAINING DRAINAGE AND RUNOFF FLOW DURING STORMS AND PERIODS OF RAINFALL.
- ALL EROSION CONTROL DEVICES SHALL BE INSPECTED AND MAINTAINED ON A REGULAR BASIS DURING CONSTRUCTION, ESPECIALLY AFTER EACH RAINFALL.
- DUE TO CHANGING CHARACTERISTICS OF THE SITE CAUSED BY AND DURING CONSTRUCTION ADDITIONAL EROSION CONTROL MEASURES MAY BE REQUIRED AS CONDITIONS WARRANT.
- IF CONSTRUCTION IS SUSPENDED, ALL DISTURBED AREAS SHALL BE SEEDED AND ALL NECESSARY EROSION CONTROL DEVICES SHALL BE IN PLACE AND IN GOOD WORKING ORDER. IF SEEDING IS NOT POSSIBLE THEN EROSION CONTROL MATS SHALL BE PLACED OVER ALL DISTURBED SOIL. EROSION CONTROL BLANKETS (MATS) SHALL BE INSTALLED ACCORDING TO THE MANUFACTURER'S RECOMMENDATIONS, EROSION CONTROL BLANKETS (MATS) SHALL BE MANUFACTURED BY NORTH AMERICAN GREEN OR APPROVED EQUIVALENT AND INSTALLED ACCORDING TO THE MANUFACTURER'S RECOMMENDATIONS.
- ALL EROSION CONTROL METHODS, MATERIALS AND MAINTENANCE SHALL BE DONE IN ACCORDANCE WITH THE "RHODE ISLAND SOIL EROSION AND SEDIMENT CONTROL HANDBOOK".
- ALL AREAS WHICH ARE DISTURBED DURING CONSTRUCTION ARE TO BE BROUGHT TO FINISHED GRADE WITH AT LEAST 6" MINIMUM DEPTH OF GOOD QUALITY LOAM AND ALL SOIL AMENDMENTS DEEMED NECESSARY. THE AREA SHALL BE SEEDED WITH A QUICK GERMINATING GRASS SEED SUCH AS URI #2 OR APPROVED EQUIVALENT.
- THE CONTRACTOR SHALL PROVIDE FOR ALL SEEDED AREAS TO BE WATERED AND IN GOOD CONDITIONS UNTIL A GOOD HEALTHY AND UNIFORM GROWTH IS ESTABLISHED OVER THE ENTIRE AREA.

SURVEYOR'S CERTIFICATION
 THIS SURVEY HAS BEEN CONDUCTED AND THE PLAN PREPARED PURSUANT TO SECTION 9 OF THE RULES AND REGULATIONS ADOPTED BY THE RHODE ISLAND STATE BOARD OF REGISTRATION FOR PROFESSIONAL LAND SURVEYORS ON NOVEMBER 25, 2015, AS FOLLOWS:

TYPE OF BOUNDARY SURVEY: NOT A BOUNDARY SURVEY DATA ACCUMULATION	MEASUREMENT SPECIFICATION: N/A CLASS III
OTHER TYPE OF SURVEY: COMPILATION PLAN (SEE NOTE 6)	CLASS IV

STATEMENT OF PURPOSE:
 THE PURPOSE FOR THE CONDUCT OF THE SURVEY AND FOR THE PREPARATION OF THE PLAN IS AS FOLLOWS:
 TO SHOW THE REDEVELOPMENT OF A SINGLE FAMILY RESIDENTIAL PROPERTY.

BY: *James T. Caldaroni*
 JAMES T. CALDARONI, P.L.S. NO. 2507
 COA NO. 722

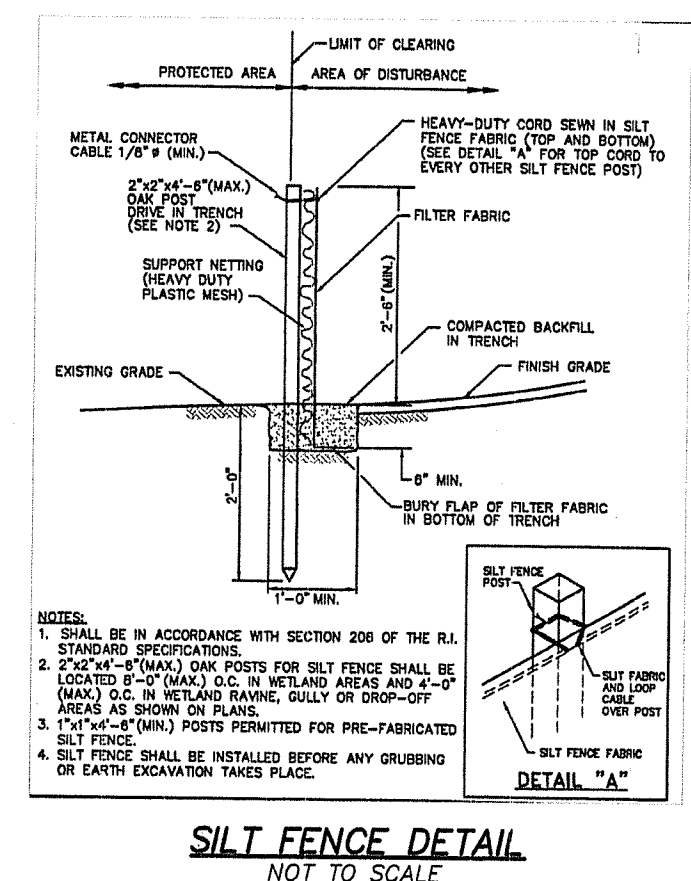
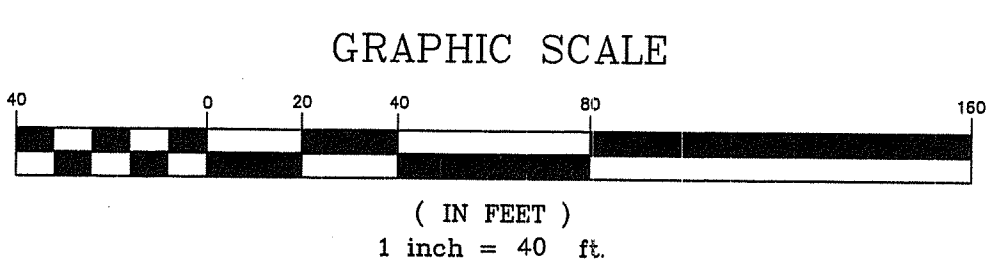
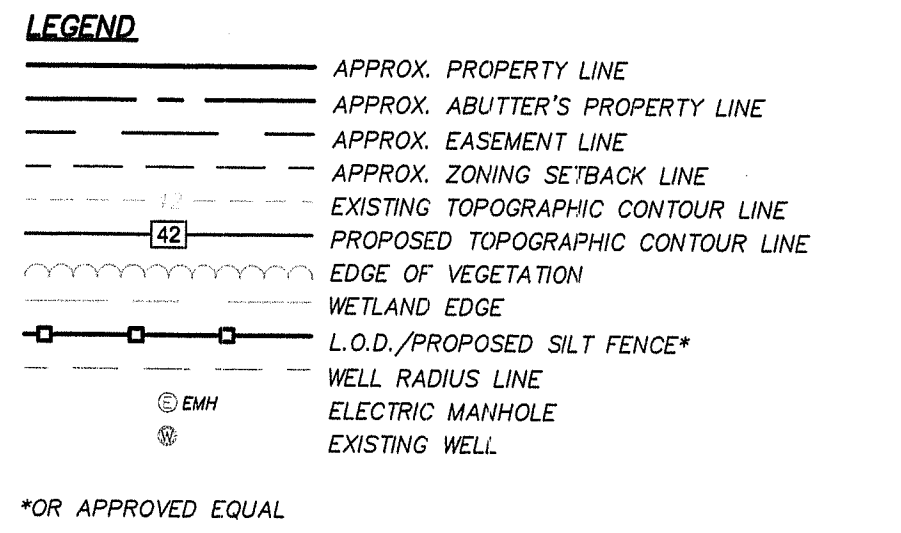
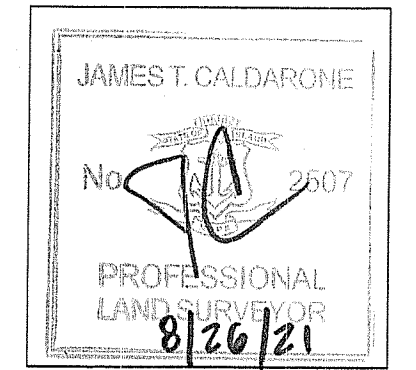

**PRELIMINARY DETERMINATION
 SITE PLAN**
 IN THE TOWN OF NEW SHOREHAM, RHODE ISLAND
 A.P. 3, LOT 86-1 ~ (1181) OFF CORN NECK ROAD
 PREPARED FOR: FAB FIVE, LLC
 AUGUST 26, 2021 SCALE: 1"=40'

SOUTH COUNTY SURVEY Co
 Environmental Management
 382B MAIN ST. WAKEFIELD, RI 02879
 (401) 783-2300
 www.SouthCountySurvey.com
 AUG 30 2021
 Office of Water Resources