

Kindly be advised that this Permit is not equivalent to a verification of the type or extent of freshwater wetlands on site.

**LOCUS MAP**  
NOT TO SCALE

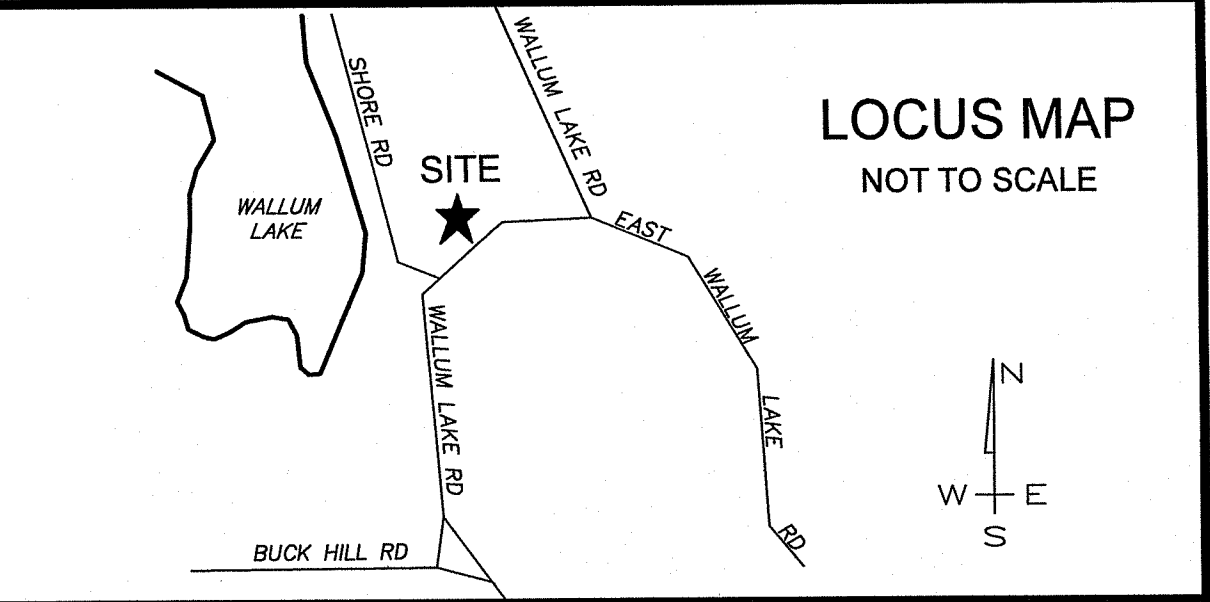

**DISTRIBUTION BOX (D-BOX)**  
NOT TO SCALE

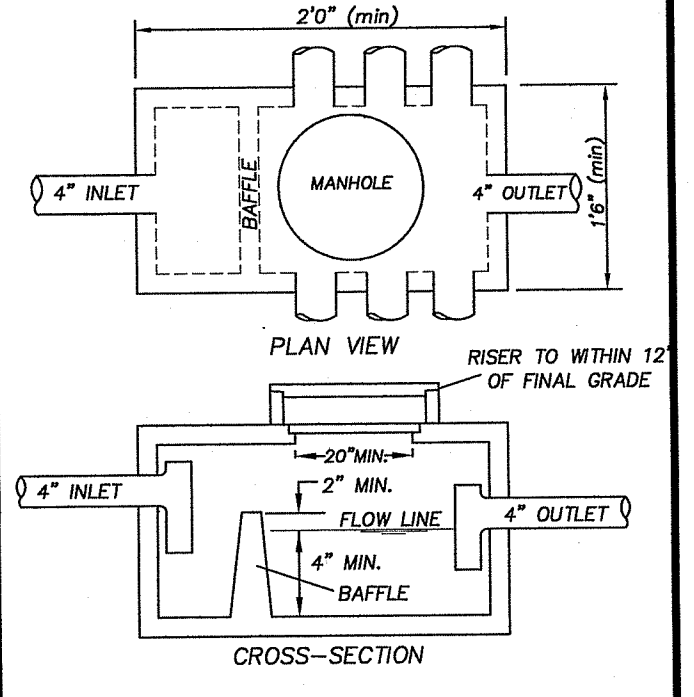

**1,000 GALLON TWO COMPARTMENT SEPTIC TANK**  
NOT TO SCALE

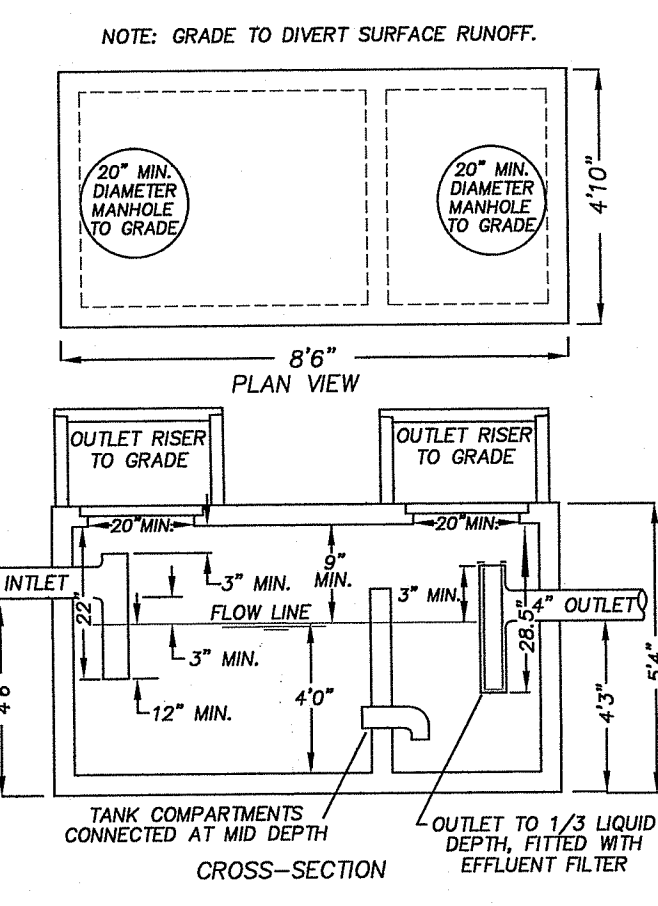

**SYSTEM PROFILE**  
NOT TO SCALE

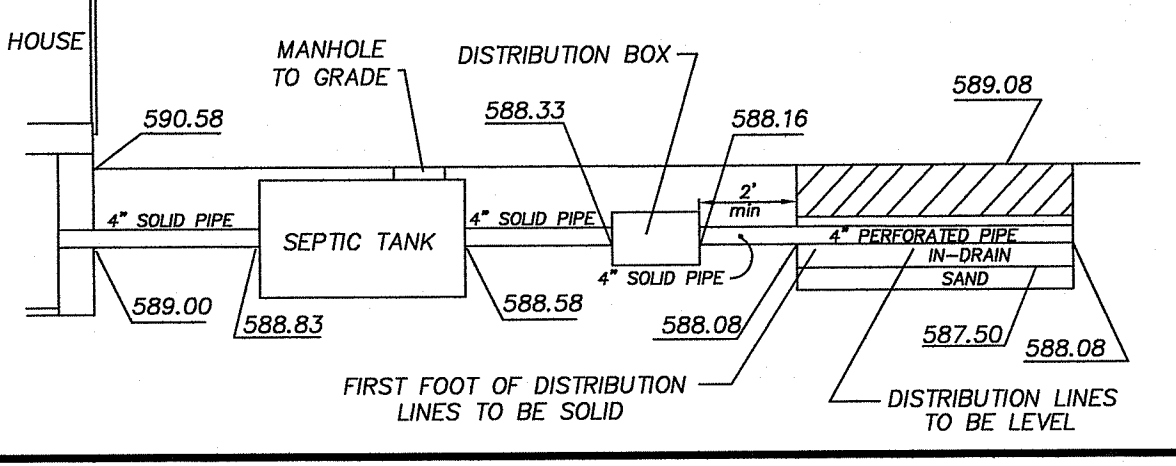

**LEACHING SYSTEM CROSS-SECTION**  
NOT TO SCALE

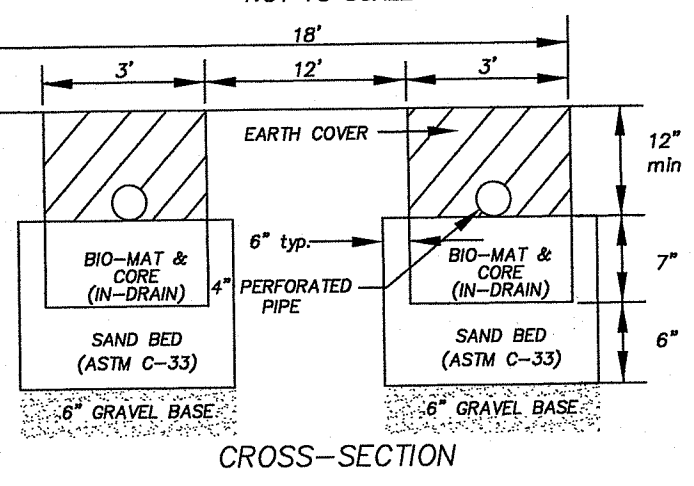

- LEACHING SYSTEM NOTES**
- 1) LEACHING TRENCHES TO BE EXCAVATED IN ACCORDANCE WITH RIDEM REGULATION 6.33(J). TREES, BRUSH AND STUMPS WITHIN AND EXTENDING 10 FEET BEYOND LEACHFIELD TO BE REMOVED. 5" STRIP REQUIRED.
  - 2) USE SDR #35 PVC PIPING OR EQUIVALENT THROUGHOUT SYSTEM.
  - 3) NO WELL EXISTS WITHIN 100' OF THE PROPOSED LEACHING SYSTEM.
  - 4) ZABEL EFFLUENT FILTER TO BE INSTALLED AT SEPTIC TANK OUTLET.
  - 5) NO WELLS, EXISTING OR PROPOSED, ARE WITHIN 200' FEET OF OWTS. NO PUBLIC WELLS, EXISTING OR PROPOSED, ARE WITHIN 500' OF THE OWTS UNLESS SHOWN.
  - 6) BRING SEPTIC TANK MANHOLE TO GRADE AND D-BOX MANHOLE TO WITHIN 12" OF GRADE.
  - 7) SEPTIC TANK TO BE A MINIMUM OF 75' FROM ALL WELLS.
  - 8) ENDS OF LINES IN TRENCH TO BE INTERCONNECTED.
  - 9) D-BOX TO HAVE A MINIMUM BOTTOM AREA OF 3 SQUARE FEET AND MEET H-20 WHEEL LOADS WITH MARKER SET TO GRADE.
  - 10) SANITARY TEES TO BE INSTALLED IN SEPTIC TANK.
  - 11) NO DRAINS OF ANY KIND SHALL BE WITHIN 25' UP OR SIDE GRADIENT OR 50' DOWN GRADIENT OF THE LEACHING SYSTEM.
  - 12) 10' FROM LEACHING AREA NOT TO BE LOWER THAN ELEV.: 588.08.
  - 13) COVER OVER SEPTIC TANK TO BE GRADED TO DIVERT SURFACE RUNOFF.
  - 14) SYSTEM INSTALLATION TO BE SUPERVISED BY THE DESIGNER.
  - 15) WASHING MACHINE LINT FILTER IS STRONGLY RECOMMENDED TO PREVENT PREMATURE FAILURE OF ELJEN SYSTEM.
  - 16) D-BOX TO HAVE TEES OR BAFFLE.

TEST HOLE DATA	DESIGN DATA
DATE: 4/7/21	SOIL CATEGORY: 9
TH 1 & 2	LOADING RATE: 0.40
0"-4" A, SL, 10YR 3/3	FIELD SIZE: ELJENS
4"-24" Bw, SL, 10YR 5/6	2 LINES
24"-66" C, CB, G, FSL, 5YR 6/2	31 ELJENS
66"-108" C2, G, FSL, 10YR 6/2	868 SF
ESHW: 24"	
NO LEDGE AT 108"	
TH 3	
0"-4" A, SL, 10YR 3/3	
4"-24" Bw, SL, 10YR 5/6	
24"-72" C, CB, G, FSL, 5YR 6/2	
72"-108" C2, G, FSL, 10YR 6/2	
ESHW: 24"	
NO LEDGE AT 108"	

ZONING DISTRICT: F5	LEGEND
FRONT - 40'	100 --- 100 EXISTING CONTOURS
SIDE - 15'	1000 --- 1000 PROPOSED CONTOURS
REAR - 40'	TH1B TEST HOLE
	A6 ▲ WETLAND FLAG
	☼ MOUNTAIN LAUREL
	--- STRAW WATTLE

**ONSITE WASTEWATER TREATMENT SYSTEM and WETLANDS PLAN**  
for  
**SEMINOLE DEVELOPMENT LLC**  
PLAT 34, LOT 38  
WALLUM LAKE ROAD, BURRILLVILLE, RI  
DATE: AUGUST, 2021  
REVISED: 10-14-21  
10-29-21  
SCALE: 1" = 30'  
GRAPHIC SCALE

DEPARTMENT OF ENVIRONMENTAL MANAGEMENT  
OFFICE OF WATER RESOURCES  
FRESHWATER WETLANDS PROGRAM  
APPROVED WITH CONDITIONS  
AS SPECIFIED IN THE LETTER OF APPROVAL  
DATED 11/9/2021 FILE # 21-0245  
NO CHANGES ALLOWED WITHOUT PRIOR APPROVAL  
APPROVED PLANS MUST BE AT CONSTRUCTION SITE

PAUL D. CARLSON  
No. 7142  
REGISTERED PROFESSIONAL ENGINEER  
CIVIL

*Nancy L. Freeman*

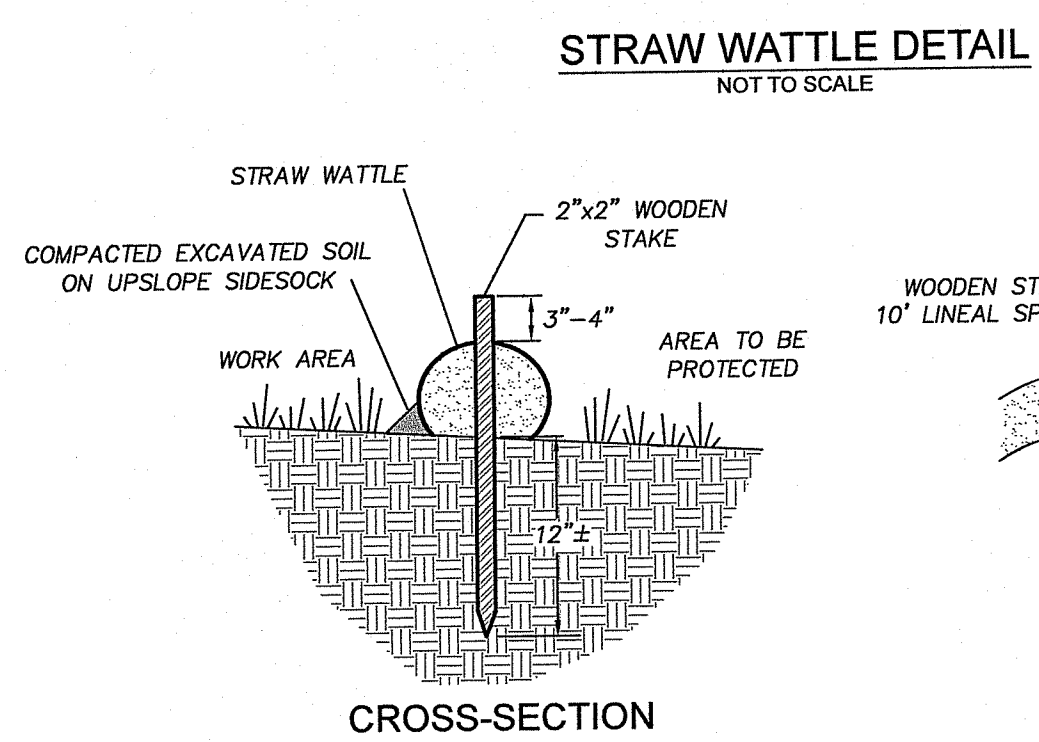

**RAIN GARDEN TREATMENT**  
Rain garden to be 8" deep with a 2-4 inch amended soil layer (50/50 mixture of the excavated native soils and mature organic compost) and a 2-3 inch layer of non-dyed aged shredded hardwood mulch.

**CONSTRUCTION**

1. A crushed stone entrance should be installed at the inflow to prevent channeling.
2. A berm to detain stormwater should be constructed along the downhill side of the rain garden, perpendicular to the slope of the lawn.
3. Be sure that the soil within the rain garden area does not become compacted by construction activities (i.e. heavy machinery). If soil becomes severely compacted it may need to be tilled and amended to maintain proper

**MAINTENANCE**

1. The rain garden shall be inspected following at least the first two precipitation events of at least 1.0 inch to ensure that the system is functioning properly.
2. Eroded side slopes and channel bottom shall be stabilized as necessary.
3. If the surface of the dry swale becomes clogged to the point that standing water is observed on the surface 48 hours after precipitation events, the bottom shall be roto-tilled or cultivated to break up any hard-packed sediment, and then reseeded.
4. Vegetation in dry swales shall be mowed as required to maintain minimum grass heights in the 4-6 inch range.
5. Every five years, the channel bottom of dry swales should be scraped to remove sediment and to restore original cross section and infiltration rate, and should be seeded to restore ground cover, where necessary.

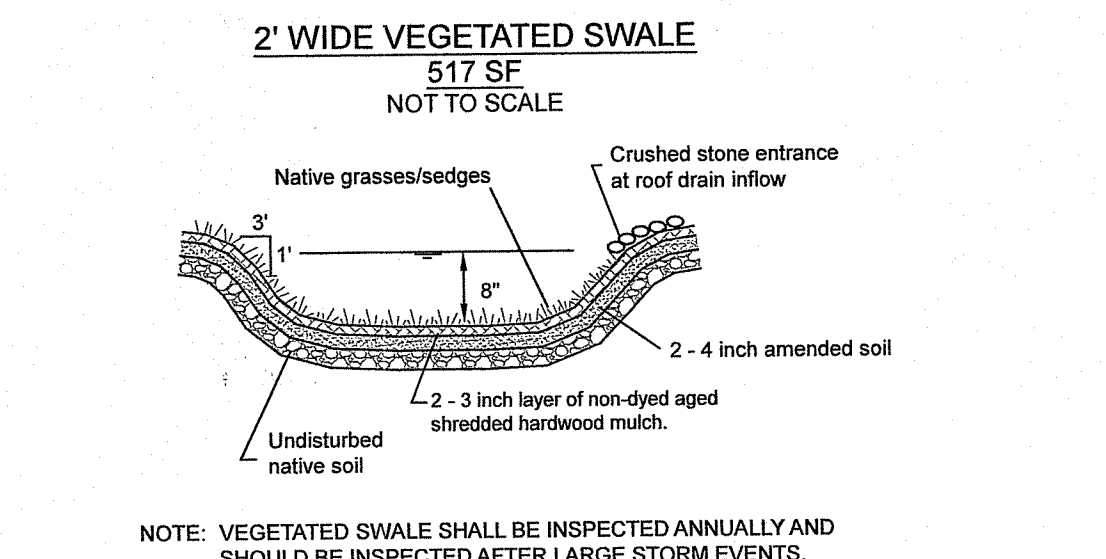
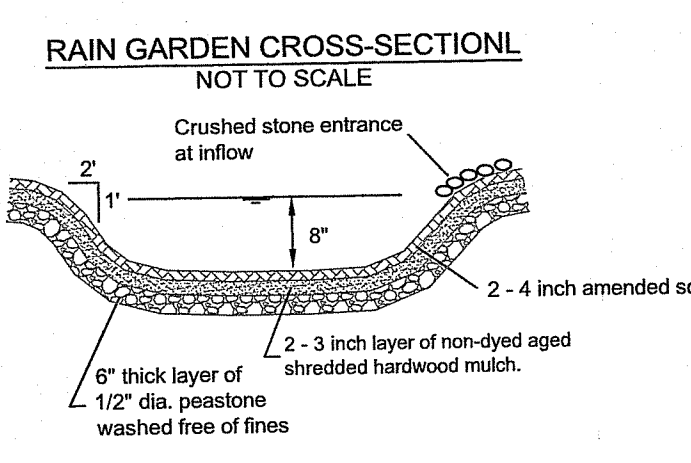
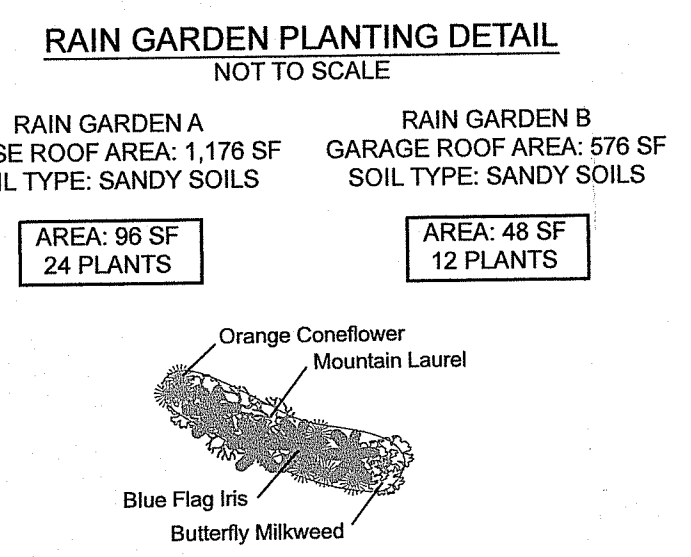

**VEGETATIVE SWALE MAINTENANCE**

1. The vegetated swale shall be inspected annually and after large storm events.
2. Eroded side slopes and channel bottom shall be stabilized as necessary.
3. If the surface of the dry swale becomes clogged to the point that standing water is observed on the surface 48 hours after precipitation events, the bottom shall be roto-tilled or cultivated to break up any hard-packed sediment, and then reseeded.
4. Vegetation in dry swales shall be mowed as required to maintain minimum grass heights in the 4-6 inch range.
5. Every five years, the channel bottom of dry swales should be scraped to remove sediment and to restore original cross section and infiltration rate, and should be seeded to restore ground cover, where necessary.

