

Environmental Management
MAR 04 2022
Office of Water Resources

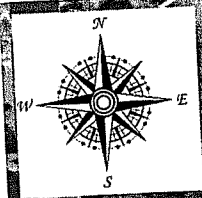

Legend

- NBS Welcome Center
- Third Beach Road
- Boardwalk Location

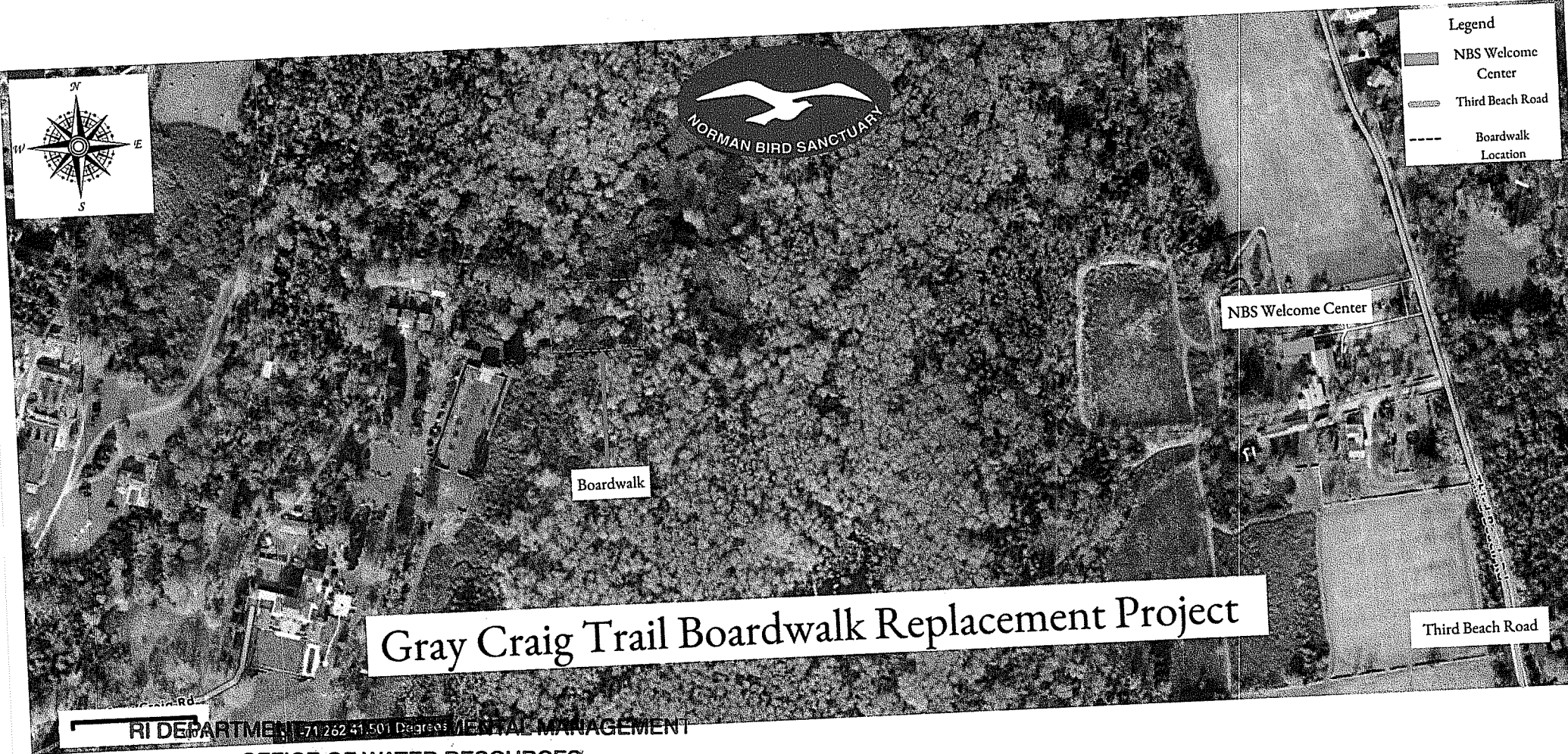

Gray Craig Trail Boardwalk Replacement Project

RI DEPARTMENT OF ENVIRONMENTAL MANAGEMENT

OFFICE OF WATER RESOURCES
FRESHWATER WETLANDS PROGRAM

APPROVED WITH CONDITIONS AS

SPECIFIED IN THE LETTER OF APPROVAL

DATED: JUN 17 2022 FILE #: 22-0086

NO CHANGES ALLOWED WITHOUT PRIOR APPROVAL
APPROVED PLANS MUST BE AT CONSTRUCTION SITE

Nancy L. Freeman

Sheet 1 of 4



Legend

- Third Beach Road
- Parking Lot
- Boardwalk
- Streams
- Cemetary

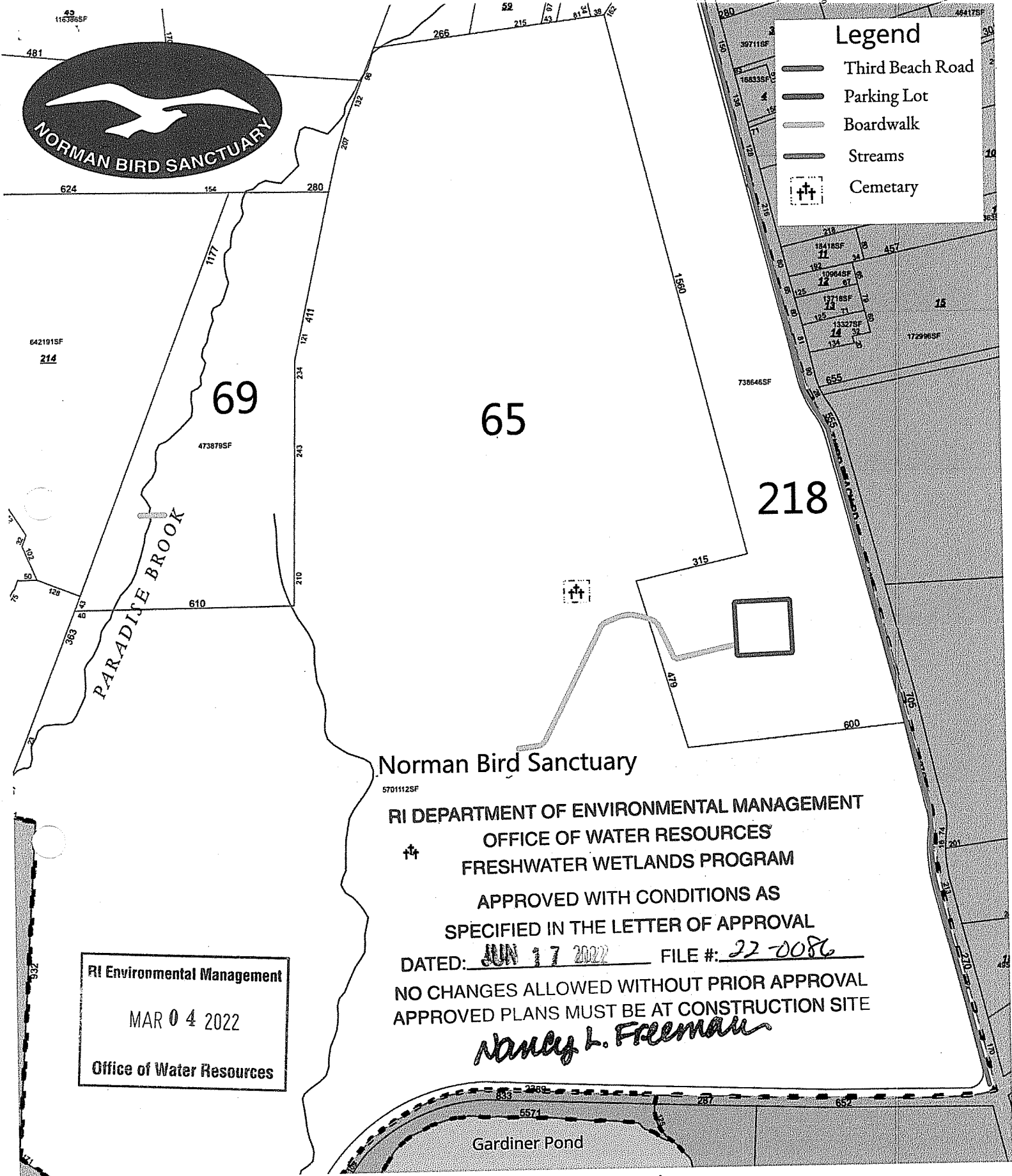

Norman Bird Sanctuary

5701112SF

RI DEPARTMENT OF ENVIRONMENTAL MANAGEMENT
 OFFICE OF WATER RESOURCES
 FRESHWATER WETLANDS PROGRAM

APPROVED WITH CONDITIONS AS
 SPECIFIED IN THE LETTER OF APPROVAL

DATED: JUN 17 2022 FILE #: 22-0086

NO CHANGES ALLOWED WITHOUT PRIOR APPROVAL
 APPROVED PLANS MUST BE AT CONSTRUCTION SITE

Nancy L. Freeman

RI Environmental Management
 MAR 04 2022
 Office of Water Resources



TOWN OF
 MIDDLETOWN
 RHODE ISLAND

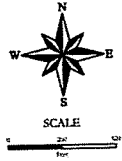

Updated 1/1/2022 RL
 This map is for planning purposes only and is not
 valid for a legal description or conveyance. It is not
 the product of a professional land survey.

- 122A Parcel Lot Number
- Parcel Boundary Lines
- 100 Plat Boundary
- Roads
- Streams
- Cemetery
- Portsmouth / Newport



Plat 126

Sheet 2 of 4

Construction Notes:

- Remove existing wooden boardwalk and replace 105 ft entirety with Wickcraft boardwalk. Extend Southwest side by 8ft and Southeast side by 12ft. Extension of 25ft to the South on muddy trail
- Staging area #1 dimensions: 20 ft by 20ft
- Staging area #2 dimensions: 20ft by 10ft
- Clear brush from staging areas, but DO NOT disturb trees
- Existing Boardwalk: 3ft wide
- New Boardwalk: 4ft wide
- Limit of Disturbance: 3.5ft wide on either side of existing boardwalk totaling 10ft wide.



Legend:

	Staging Area
	Limit of disturbance (3.5ft on each side of boardwalk)
	Existing Boardwalk
	Wetland Boundary (approximate)
	New Boardwalk

RI DEPARTMENT OF ENVIRONMENTAL MANAGEMENT
 OFFICE OF WATER RESOURCES
 FRESHWATER WETLANDS PROGRAM
 APPROVED WITH CONDITIONS AS



SPECIFIED IN THE LETTER OF APPROVAL

DATED: JUN 17 2022 FILE #: 22-0086

NO CHANGES ALLOWED WITHOUT PRIOR APPROVAL
 APPROVED PLANS MUST BE AT CONSTRUCTION SITE

Nancy L. Freeman

Sheet 3 of 4

RI Environmental Management
 MAY 23 2022
 Office of Water Resources

RI DEPARTMENT OF ENVIRONMENTAL MANAGEMENT
 OFFICE OF WATER RESOURCES
 FRESHWATER WETLANDS PROGRAM

APPROVED WITH CONDITIONS AS
 SPECIFIED IN THE LETTER OF APPROVAL

DATED: JUN 17 2022 FILE #: 22-0086

NO CHANGES ALLOWED WITHOUT PRIOR APPROVAL
 APPROVED PLANS MUST BE AT CONSTRUCTION SITE

Nancy L. Freeman

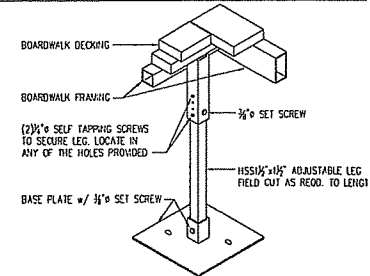
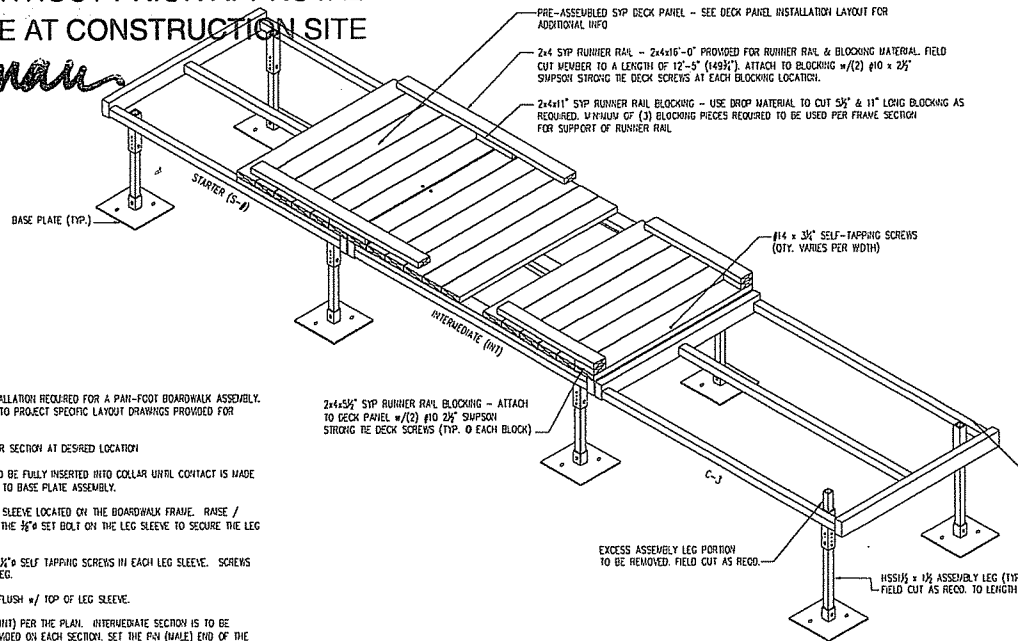

2 ADJUSTABLE LEG DETAIL
 5 SCALE: N.T.S.

INSTALLATION INSTRUCTIONS:

NOTES: BOARDWALK LAYOUT SHOWN IS INTENDED TO PROVIDE AN OVERALL CONCEPT OF THE INSTALLATION REQUIRED FOR A PAN-FOOT BOARDWALK ASSEMBLY. ACTUAL PROJECT LAYOUT & PART MARK NUMBERS / GEOMETRY WILL VARY BY PROJECT. REFER TO PROJECT SPECIFIC LAYOUT DRAWINGS PROVIDED FOR LOCATION & PART MARK NUMBERS OF BOARDWALK SECTIONS TO INSTALL.

- SEE PLAN FOR STARTER SECTION PART MARK NUMBER (S-P). LOCATE AND PLACE STARTER SECTION AT DESIRED LOCATION
- INSERT LEG MATERIAL (HSS1 1/2 x 1 1/2) INTO COLLAR ON BASE PLATE ASSEMBLY. LEG SHOULD BE FULLY INSERTED INTO COLLAR UNTIL CONTACT IS MADE WITH BASE PLATE. TIGHTEN 3/8" SET BOLT ON SIDE OF COLLAR TO SECURE LEG IN PLACE TO BASE PLATE ASSEMBLY.
- ONCE BASE PLATE IS ATTACHED TO HSS LEG, INSERT OPPOSITE END OF THE LEG INTO THE SLEEVE LOCATED ON THE BOARDWALK FRAME. RAISE / LOWER FRAME UNTIL DESIRED ELEVATION IS OBTAINED. LEVEL FRAME AS NEEDED. TIGHTEN THE 3/8" SET BOLT ON THE LEG SLEEVE TO SECURE THE LEG IN PLACE. REPEAT THIS PROCESS FOR ALL SLEEVE LOCATIONS ON STARTER FRAME.
- ONCE FINAL ELEVATION OF FRAME IS DETERMINED SECURE LEG IN PLACE BY INSERTING (2) 1/4" SELF TAPPING SCREWS IN EACH LEG SLEEVE. SCREWS MAY BE PLACED IN ANY OF THE PRE-DRILLED HOLES PROVIDED IN SLEEVE INTO THE HSS LEG.
- ONCE SECURED, CUT OFF EXCESS HSS1 1/2 x 1 1/2 LEG SECTION AS REQUIRED. LEG IS TO BE FLUSH w/ TOP OF LEG SLEEVE.
- ONCE STARTER FRAME IS IN PLACE LOCATE AND INSTALL THE FIRST INTERMEDIATE FRAME (INT) PER THE PLAN. INTERMEDIATE SECTION IS TO BE ATTACHED TO THE STARTER SECTION VIA THE MALE / FEMALE HINGE PIN CONNECTION PROVIDED ON EACH SECTION. SET THE PIN (MALE) END OF THE FRAME INTO THE FEMALE RECEIVER LOCATED ON THE STARTER FRAME. ONCE THE PINS ARE IN PLACE AT THE HINGED CONNECTION POINT, REPEAT THE STEPS ABOVE FOR CONNECTING THE HSS LEG SUPPORT. LOCK THE FRAMES TOGETHER AT THE HINGE CONNECTION BY INSERTING (1) 3/8" SET BOLT BELOW THE HINGE. THIS WOULD BE TYPICAL EACH SIDE OF THE FRAME.
- REPEAT PROCESS ABOVE FOR ALL INTERMEDIATE FRAMES.
- ONCE FRAMES ARE INSTALLED, PLACE DECK PANEL ONTO FIRST FRAME AND SECURE PANEL IN PLACE. REFER TO DECK PANEL INSTALLATION DRAWING FOR ADDITIONAL INFORMATION.
- ONCE FRAMING AND DECKING PANEL INSTALLATION IS COMPLETE, INSTALL 2x4 SYP RUNNER RAIL SYSTEM AS REQUIRED FOR THE PROJECT. REFER TO 2x4 SYP RUNNER RAIL INSTALLATION DRAWING FOR ADDITIONAL INFORMATION.

RI Environmental Management
 MAR 04 2022
 Office of Water Resources

PRELIMINARY
 NOT FOR CONSTRUCTION

1 TYPICAL PAN FOOT BOARDWALK INSTALLATION w/ 2x4 RUNNER RAIL
 SCALE: N.T.S.

#	DATE	DESCRIPTION	BY:	#	DATE	DESCRIPTION	BY:
△	-	-	-	△	-	-	-
△	-	-	-	△	-	-	-

WICKCRAFT BOARDWALKS		WICKCRAFT BOARDWALKS	
		2317 DANIELS ST MADISON, WI 53718 (608) 244-9177	
TITLE			
NORMAN BIRD SANCTUARY MIDDLETOWN, RHODE ISLAND TYP. INSTALLATION - PAN FOOT			
DRAWN BY JLL	DATE 08/19/21	DWG. NO.	5
APPROVED BY ###	DATE ##/##/##	PROJECT NO.	RI-18-0248

THIS DRAWING AND THE INFORMATION CONTAINED IS CONFIDENTIAL AND IS THE PROPERTY OF WICKCRAFT CO. INC. USE, REPRODUCTION OR DISCLOSURE OF THE CONTENT OF THIS DRAWING (OR ANY PORTION) MUST BE APPROVED BY WICKCRAFT.

UNLESS OTHERWISE SPECIFIED DIMENSIONS ARE IN INCHES. THE FOLLOWING TOLERANCES APPLY:
 DECIMAL DIMENSIONS: ± .1"
 FRACTIONAL DIMENSIONS: ± 1/16"
 ANGULAR DIMENSIONS: ± 0.25°