

**PLAN VIEW**  
SCALE: 1" = 30'

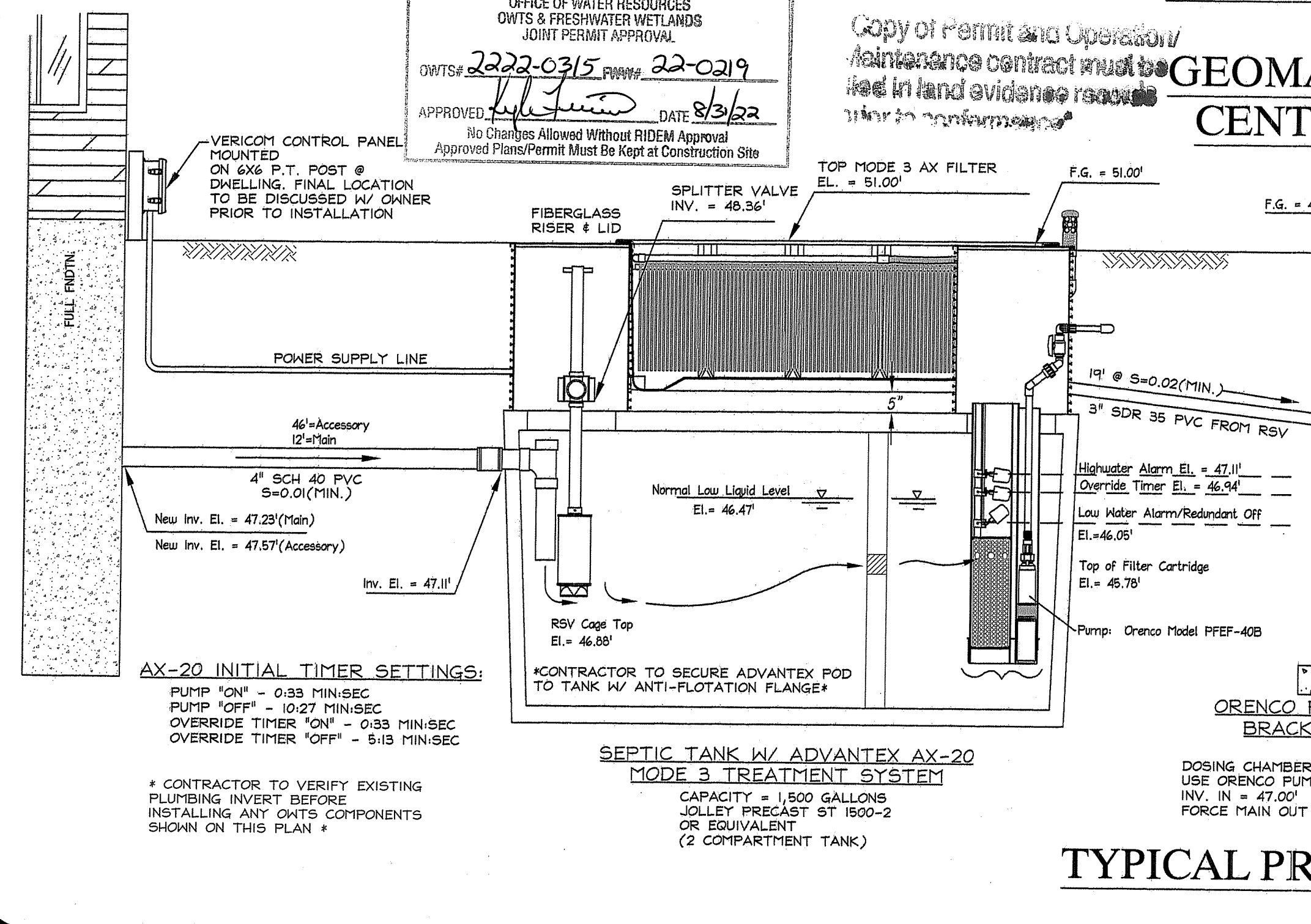

**TYPICAL PROFILE OF SYSTEM**  
N.T.S.

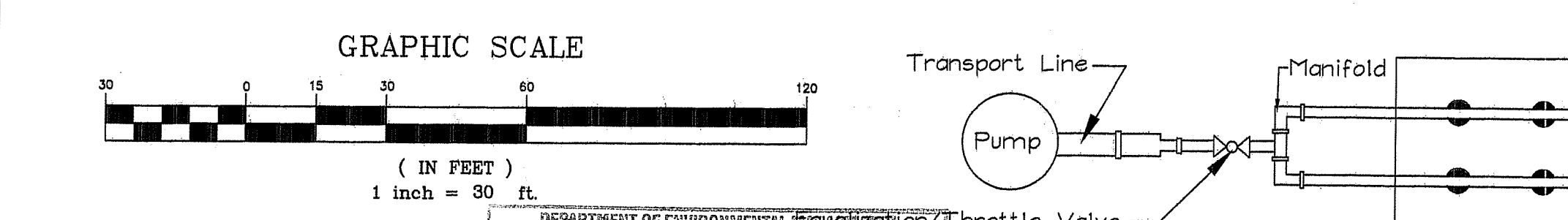
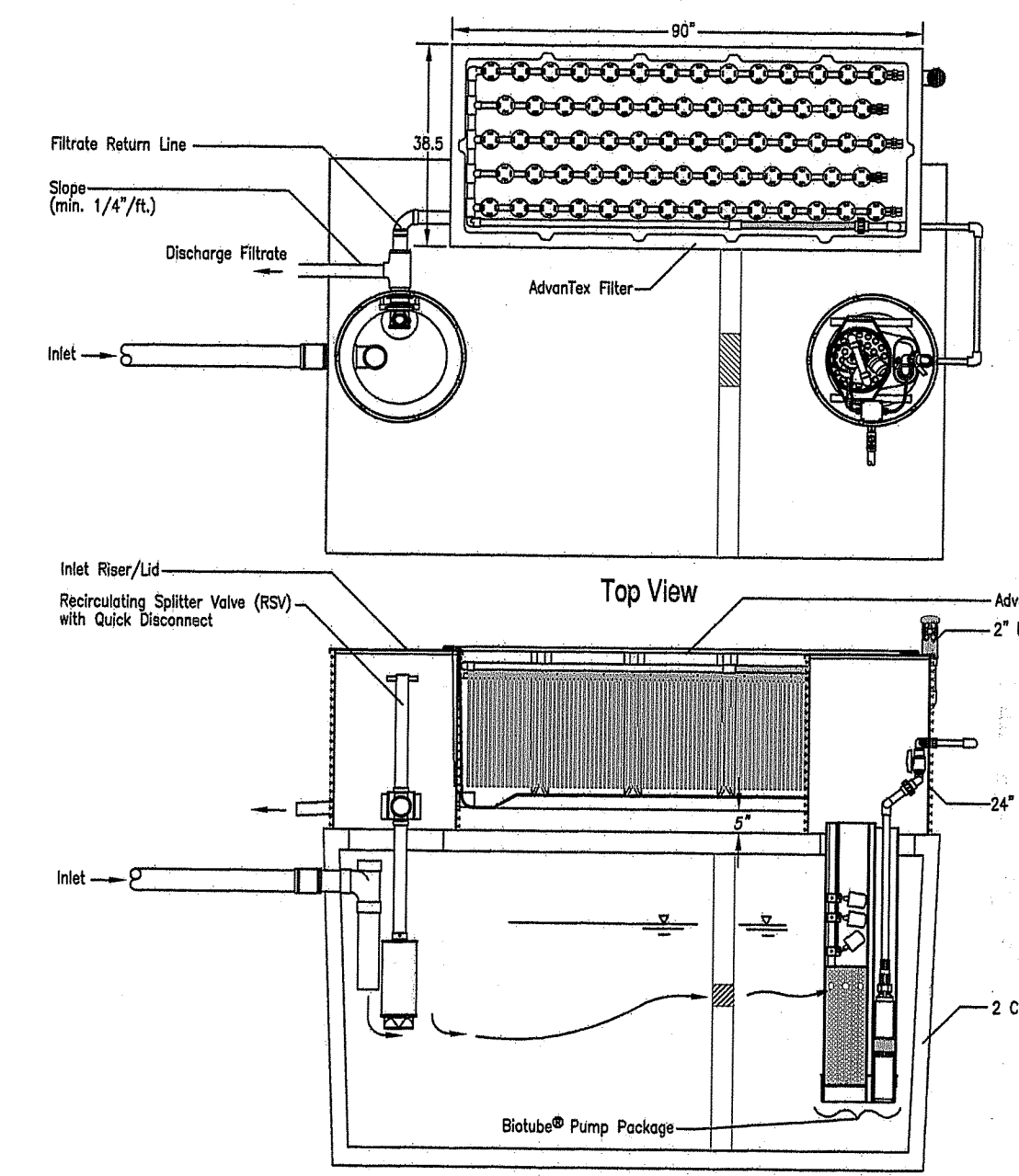

**COLD WEATHER ORIFICE SHIELD DETAIL**  
N.T.S.

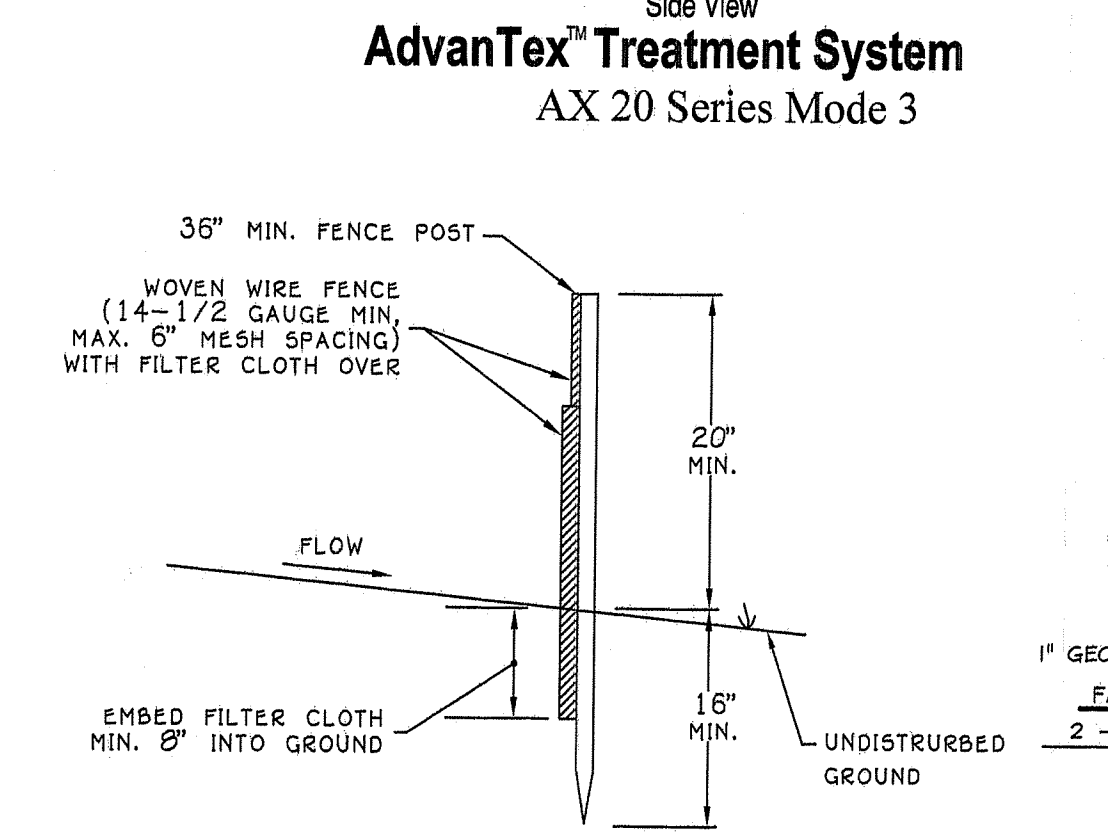

**AdvanTex™ Treatment System**  
AX 20 Series Mode 3

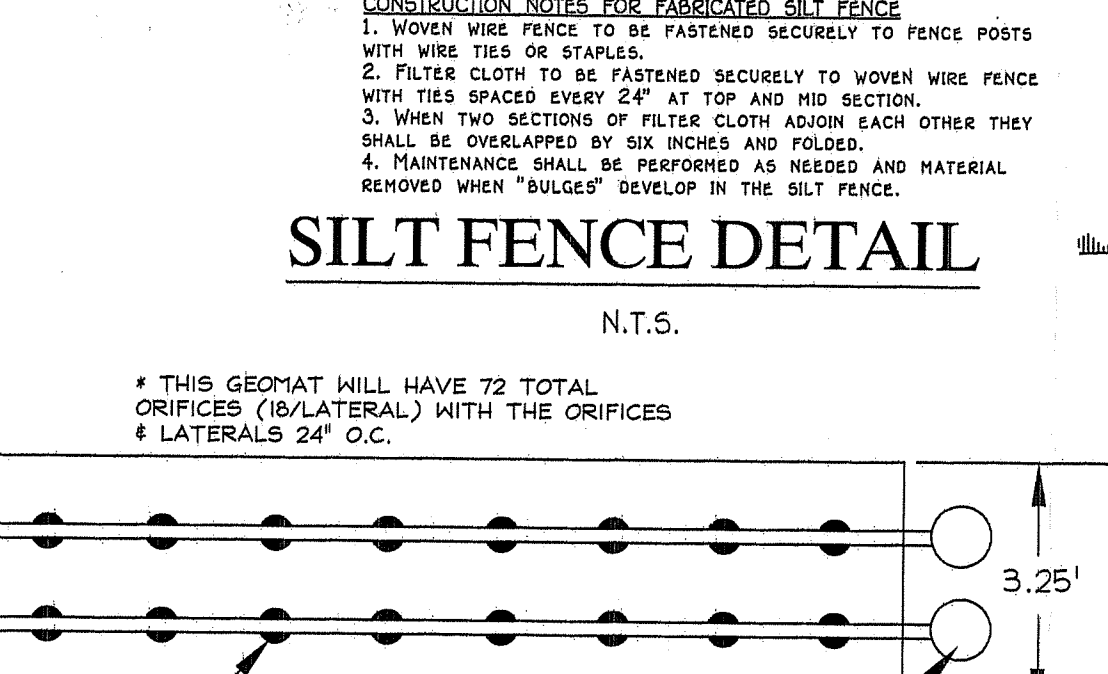

**SILT FENCE DETAIL**  
N.T.S.

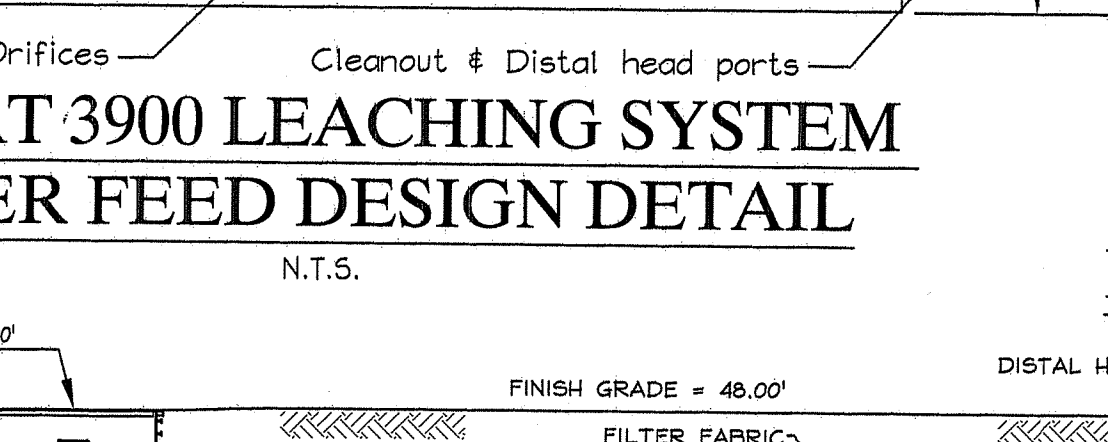

**GEOMAT 3900 LEACHING SYSTEM**  
CENTER FEED DESIGN DETAIL  
N.T.S.

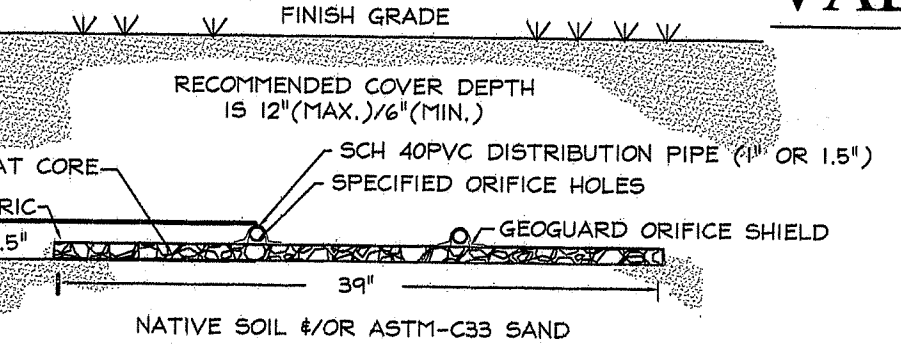

**FLOW EQUALIZATION VALVE DETAIL**  
N.T.S.

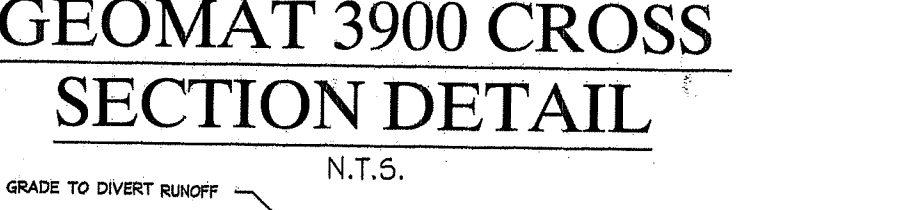

**GEOMAT 3900 CROSS SECTION DETAIL**  
N.T.S.

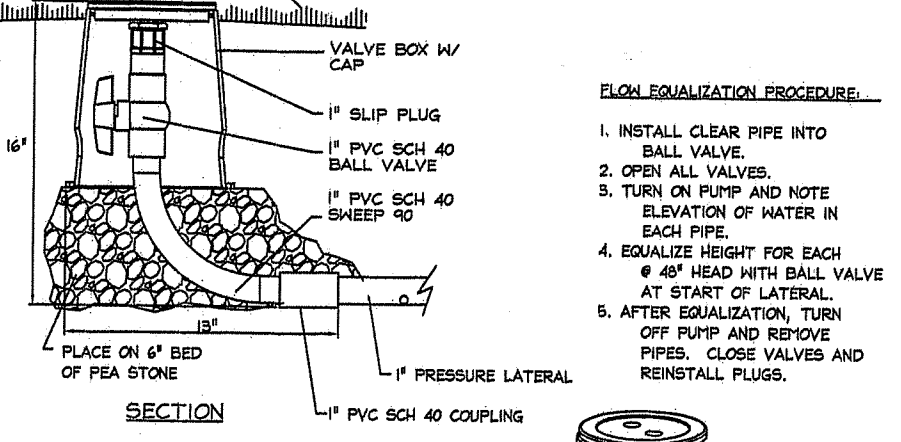

**DISTAL HEAD PORT DETAIL**  
N.T.S.

**LEGEND**

- RI Highway Bound Found
- CBDF Concrete Bound Drillhole Found
- IRF Iron Rod Found
- UP Utility Pole
- WS Water Shutoff
- DH Drillhole Found
- ST Septic Tank Lid
- W Well
- SW Stone Wall
- PL Property Line
- APX Approx. Property Line
- X Vehicle Parking or Traffic Over the Opts Components is Prohibited
- PROP. SILT FENCE
- CONTOUR (NAVD 1988 DATUM)
- EXISTING WATERLINE
- EXISTING ELECTRICLINE
- EXISTING TREELINE
- SOIL EVALUATION
- PROPOSED WATERLINE
- PROPOSED DRAINLINE
- PROPOSED CONTOUR

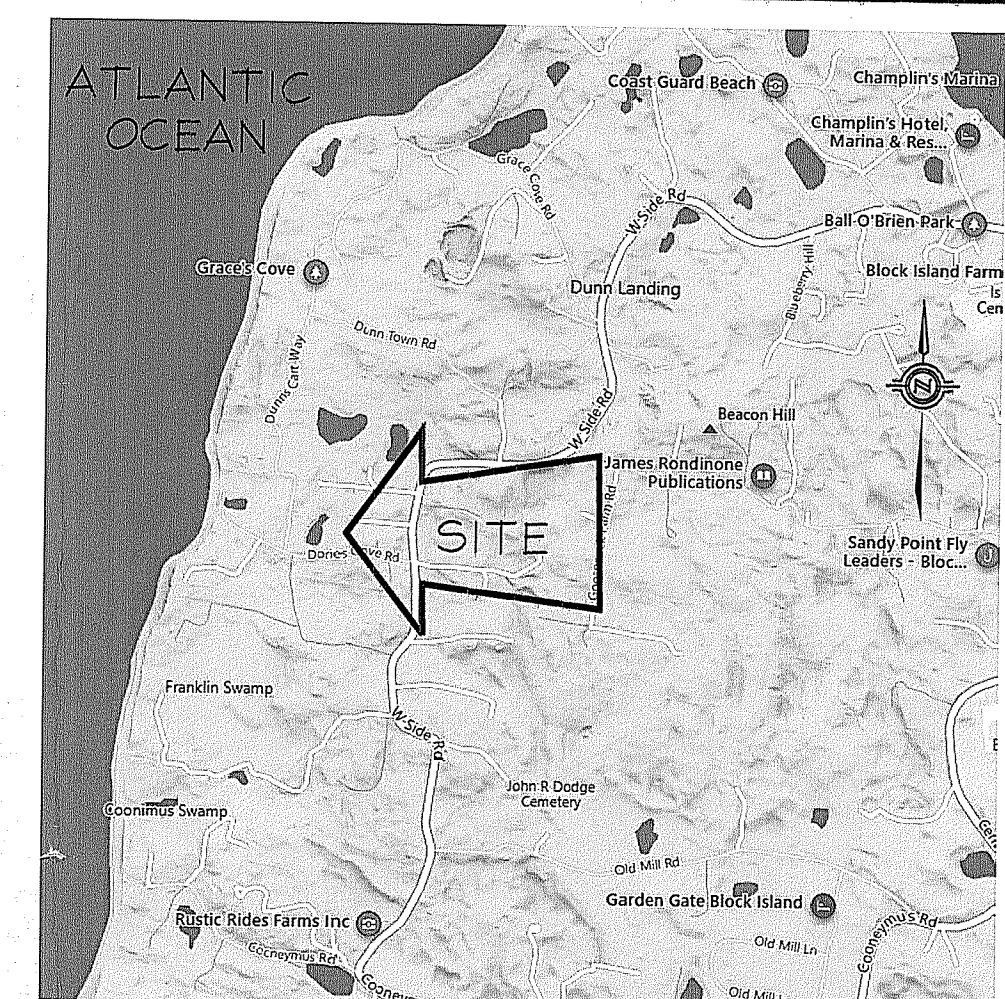

**LOCUS MAP**

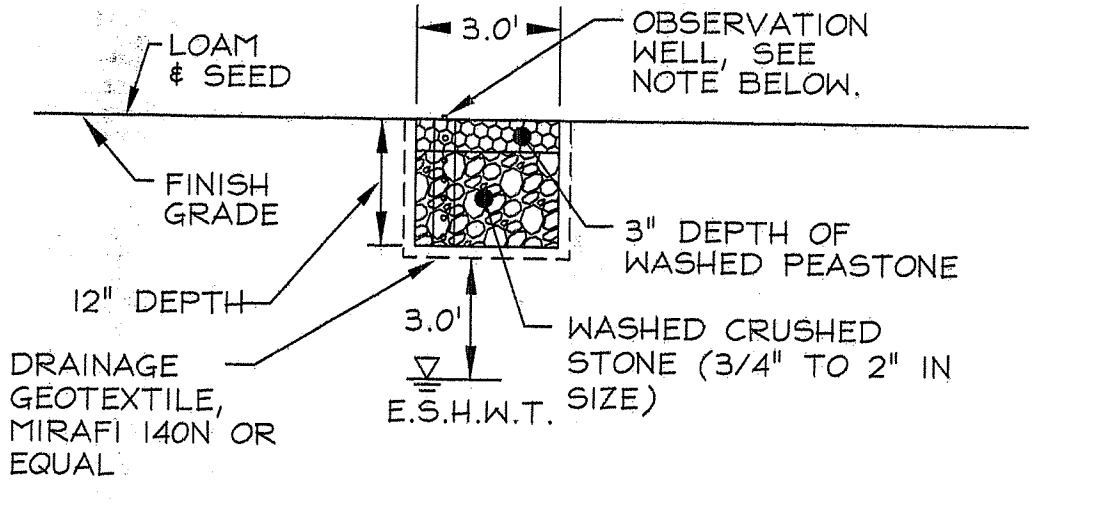

**INFILTRATION TRENCH DETAIL**  
NOT TO SCALE

**OWTS GENERAL NOTES:**

1. THE PROPERTY IS NOT SUBJECT TO RHODE ISLAND COASTAL RESOURCES MANAGEMENT COUNCIL REVIEW.
2. ALL PRIVATE AND PUBLIC DRINKING WATER LINES WITHIN 50 FEET OF THE PROPOSED ONSITE WASTEWATER TREATMENT SYSTEM (OWTS) ARE SHOWN, UNLESS OTHERWISE NOTED ON SITE PLAN.
3. THERE ARE NO PUBLIC SEWERS AVAILABLE TO THE PROPERTY WITHIN 200 FEET UNLESS NOTED ON SITE PLAN.
4. ALL EXISTING AND PROPOSED PRIVATE DRINKING WATER WELLS, 4/0R THERE RADI, ARE SHOWN WITHIN 200' OF THE PROPOSED OWTS COMPONENTS SHOWN ON THIS PLAN.
5. ALL EXISTING AND PROPOSED WELLS SERVING NON-POTABLE USES WITHIN 100 FEET OF THE OWTS ARE SHOWN, UNLESS OTHERWISE NOTED ON THIS SITE PLAN.
6. ALL EXISTING AND PROPOSED PUBLIC DRINKING WATER WELLS WITHIN 500 FEET OF THE PROPOSED OWTS ARE SHOWN, UNLESS OTHERWISE NOTED ON THIS SITE PLAN. THE CONSTRUCTION DETERMINATION OF SAID WELLS IS IDENTIFIED ON THE SITE PLAN, UNLESS OTHERWISE NOTED.
7. ALL WATERCOURSES, WETLANDS, AND DRAINS WITHIN 200 FEET OF THE PROPOSED OWTS ARE SHOWN, UNLESS OTHERWISE NOTED ON SITE PLAN.
8. ALL STORM AND SUBSURFACE DRAINS WITHIN 200 FEET OF THE PROPOSED OWTS ARE SHOWN, UNLESS OTHERWISE NOTED ON SITE PLAN. THE ULTIMATE DISCHARGE OF SAID DRAINS ARE IDENTIFIED ON THE SITE PLANS.
9. THE OWTS IS NOT LOCATED WITHIN THE WATERSHED OF A PUBLIC WATER SUPPLY OR OTHER CRITICAL RESOURCE AREA.
10. ALL EXISTING OWTS ON ADJUTING PROPERTIES WITHIN 200 FEET OF A PROPOSED WELL TO SERVICE THE SUBJECT PROPERTY ARE IDENTIFIED ON THIS SITE PLAN, UNLESS OTHERWISE NOTED.
11. THE SUBJECT PROPERTY IS NOT LOCATED WITHIN AN IDENTIFIED FLOOD ZONE.
12. IF A PROPOSED WELL IS REQUIRED TO SERVICE THE WATER REQUIREMENTS FOR THE SUBJECT PROPERTY, SAID WELL DOES NOT REQUIRE A VARIANCE FROM RIDEN'S RULES AND REGULATIONS GOVERNING THE ENFORCEMENT OF CHAPTER 46-13.2 RELATING TO THE DRILLING OF DRINKING WATER WELLS.
13. OWTS DESIGN DATA:
  - 4 BEDROOM DESIGN - 115 GALLONS PER BEDROOM - TOTAL DESIGN FLOW = 460 GPD
  - BASED ON THE SOIL EVALUATION, THE MOST RESTRICTIVE CATEGORY IS 17.
  - THE SOIL APPLICATION RATE = 2.1 GAL/50 FT<sup>2</sup>/DAY
  - TOTAL REQUIRED LEACHING AREA = 219.04 SQUARE FEET
  - TOTAL PROVIDED LEACHING AREA = 227.5 SQUARE FEET
  - LEACHFIELD: 3.25' W x 70' L GEOMAT 3900.
14. OWTS GENERAL CONSTRUCTION NOTES:
  - ALL PIPING SHALL BE 4" PVC SCH 40 OR EQUIVALENT, UNLESS OTHERWISE NOTED
  - THE SEPTIC TANK SHALL BE A CONCRETE TANK WITH THE CAPACITY AS STATED ON THE SITE PLAN
  - THE SEPTIC TANK INLET SHALL EXTEND 1' BELOW THE FLOW LINE AND THE OUTLET TEE SHALL EXTEND 1/3 THE DEPTH BELOW THE FLOW LINE.
  - THE SEPTIC TANK SHALL BE FITTED WITH TWO ACCESS MANHOLE RISERS NOT LESS THAN 20" CARRYING A MINIMUM 300 PSF LOAD WITH MINIMAL SIDEWALL DEFLECTION.
  - LEACHFIELD STONE, IF USED, SHALL BE 3/4" TO 2" DOUBLE WASHED STONE, FREE OF ALL DEBRIS.
  - SURFACE GRADES WITHIN 5 FEET OF THE LEACHFIELD SHALL NOT BE LOWER THAN ELEVATION 47.00'. AT THE 10 FEET DISTANCE FROM THE LEACHFIELD, THE SLOPE SHALL BE A MINIMUM OF SHIV TO MATCH INTO EXISTING GRADES.
  - THE LEACHFIELD AND THE AREA WITHIN 10 FEET FOR THE LEACHFIELD SHALL BE STRIPPED OF ALL TREES, BRUSH, STUMPS AND BouldERS. THE SIDES AND BOTTOM OF THE EXCAVATION SHALL NOT BE CONTACTED OR SHEARED AND THE BOTTOM SHALL BE SCARIFIED PRIOR TO LEACHFIELD PLACEMENT TO A MINIMUM DEPTH OF 46.92'.
  - THE FINISH GRADE OVER THE SEPTIC TANK SHALL BE GRADED TO DIVERT SURFACE WATER RUNOFF AWAY FROM THE TANK.
  - IF A DRIVEWAY OR PAVEMENT IS TO BE LOCATED NEAR THE PROPOSED OWTS, A FENCE OR CURBING SHALL BE INSTALLED AROUND THE SYSTEM IN THE AREA OF THE PAVEMENT TO PREVENT VEHICULAR TRAFFIC FROM DRIVING ONTO THE SYSTEM.
  - CONTRACTOR TO OBSERVE & CONFIRM ALL EXISTING PLUMBING INSIDE THE DWELLING SHALL BE TIED INTO THE PROPOSED SEPTIC TANK SHOWN ON THIS PLAN. IT IS THE CONTRACTOR'S RESPONSIBILITY TO VERIFY WHERE ALL EXISTING PLUMBING EXISTS THE BUILDING(S), SHOWN ON THIS PLAN, PRIOR TO INSTALLING ANY OWTS COMPONENTS. NEW PLUMBING, INSIDE THE BUILDING(S) SHOWN ON THIS PLAN, MAY BE REQUIRED AS PART OF THIS OWTS INSTALLATION.
15. THIS PLAN CONFORMS TO A CLASS "M" PROPERTY LINE & A CLASS "M" TOPOGRAPHY AS ADOPTED BY THE RI BOARD OF REGISTRATION FOR PROFESSIONAL LAND SURVEYORS. THIS SURVEY IS NOT VALID FOR ANY OTHER PURPOSE, OTHER THAN SHOWN ON THIS PLAN, WITHOUT WRITTEN CONSENT.
16. GENERAL OWNER NOTES:
  - FOOD/GARBAGE GRINDERS INSIDE DWELLING AND DISPOSAL OF GREASES, OILS, AND OR FATS ARE PROHIBITED.
  - VEHICLE PARKING OR TRAFFIC OVER THE OWTS COMPONENTS IS PROHIBITED.
  - BACKWASH WATER FROM A WATER TREATMENT SYSTEM SHALL NOT BE TAKEN INTO CONSIDERATION WITH THE DESIGN OF THIS OWTS. WATER TREATMENT SYSTEM DISCHARGE TO THIS OWTS IS PROHIBITED.
  - THE SEPTIC TANK SHALL BE PUMPED WHEN DEEMED NECESSARY BY OPERATIONS & MAINTENANCE PERSONNEL OR LICENSED SEPTIC INSPECTOR.
17. INSTALLER TO PROVIDE DESIGNER W/ ALL COPIES OF MATERIALS PURCHASED & USED ON INSTALLING THIS OWTS PRIOR TO ISSUANCE OF CERTIFICATE OF CONSTRUCTION.
18. THERE ARE NO EXISTING OR PROPOSED SUBSURFACE DRAINS WITHIN 25' OF THE PROPOSED OWTS COMPONENTS SHOWN ON THIS PLAN.
19. WETLAND DELINEATION PROVIDED BY NINIGRET ENVIRONMENTAL, LLC IN MARCH 2022.
20. THE PROPOSED STORMWATER MANAGEMENT PRACTICES SHOWN ON THIS PLAN WERE DESIGNED AS FOLLOWS: INFILTRATION TRENCH DESIGN DATA - MAXIMUM OF 388 SO. FT. OF ROOFLINE PROPOSED, USING TABLES 10 & 11 FROM THE RISD MANUAL & DESIGNING ON SILTY SOILS. 1/2" DEPTH OF STONE, 85 SO. FT. IS REQUIRED, 40 SO. FT. OF TOTAL INFILTRATION AREA HAS BEEN PROVIDED WITH THE 12" DEEP, 36" WIDE, 30' LONG INFILTRATION TRENCH SHOWN ON THIS PLAN. SEE DETAIL FOR MORE INFO.

**ONSITE WASTEWATER TREATMENT SYSTEM ALTERATION DESIGN**  
A.P. 15, LOT 50  
962 DORRY'S COVE ROAD  
NEW SHOREHAM, RHODE ISLAND  
Prepared For:  
KRISTIN CARBONE

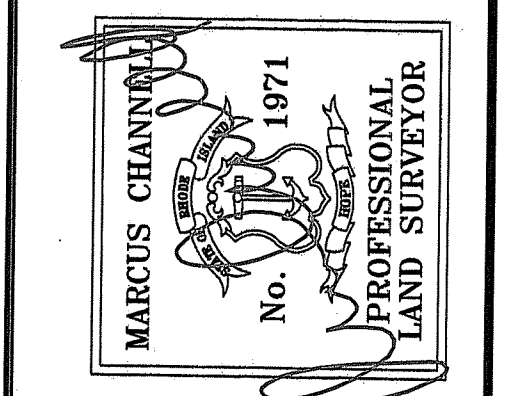

**ATLAS LAND SURVEYING, LLC**  
PROPERTY & CONSTRUCTION SURVEYING & MAPPING  
91 Parkway Drive ~ Warwick, RI 02886  
401-737-4407  
WWW.ATLASLANDSURVEYING.COM

REVISION: JULY 2022  
DATE: MAY 2022  
DRAWN BY: KRC  
SCALE: 1" = 30'  
SHEET 1 OF 1 SHEETS 1  
JOB NO. CARBONE  
DWG. NO. CARBONE-OWTS