

Alice M. Waddington Elementary School

AP 612, Block 13, Lot 011

101 Legion Way

Riverside, Rhode Island

OWNER:



CITY OF EAST PROVIDENCE
SCHOOL DEPARTMENT
145 TAUNTON AVENUE
EAST PROVIDENCE, RI 02914



101 LEGION WAY
RIVERSIDE, RI 02915

CIVIL ENGINEER:



PARE CORPORATION
ENGINEERS - SCIENTISTS - PLANNERS
8 BLACKSTONE VALLEY PLACE
LINCOLN, RI 02865
401-334-4100

ARCHITECT:



526 BOSTON POST ROAD
WAYLAND, MA 01778

LANDSCAPE ARCHITECT:



150 Chestnut Street, 4th Floor
Providence, RI 02903

OWNER PROJECT MANAGER:

Peregrine Group LLC
20 Newman Avenue, Suite 1005
Rumford, RI 02916



Scale : N.T.S.

INDEX OF DRAWINGS

SHEET No.	DRAWING No.	DESCRIPTION
1	-	COVER SHEET
2	C1.1	NOTES
3	C1.2	LEGEND
4	C2.1	DEMOLITION & EROSION CONTROL PLAN
5	C3.1	GENERAL PLAN
6	C4.1	GRADING, DRAINAGE & UTILITY PLAN
7	C5.1	DETAILS 1
8	C5.2	DETAILS 2
9	LP1.1	OVERALL PLANTING PLAN

**RIDEM FRESHWATER WETLAND PERMIT SUBMISSION
SEPTEMBER 1, 2023**

RI DEPARTMENT OF ENVIRONMENTAL MANAGEMENT
OFFICE OF WATER RESOURCES
FRESHWATER WETLANDS PROGRAM
APPROVED WITH CONDITIONS AS
SPECIFIED IN THE LETTER OF APPROVAL
DATED: OCT 16 2023 FILE #: 23-0190
NO CHANGES ALLOWED WITHOUT PRIOR APPROVAL
APPROVED PLANS MUST BE AT CONSTRUCTION SITE

RI Environmental Management
SEP 01 2023
Office of Water Resources

Randy Clapton

REFERENCE

- 1. PROJECT LOCATION: A.M. WADDINGTON ELEMENTARY SCHOOL, 101 LEGION WAY, EAST PROVIDENCE, RI 02915. ASSESSOR'S MAP 612, BLOCK 13, LOT 011.
2. EXISTING CONDITIONS MAPPING TAKEN FROM PLAN ENTITLED "BOUNDARY SURVEY & EXISTING CONDITIONS PLAN FOR CITY OF EAST PROVIDENCE ASSESSORS PLATS 612 & 613 LOTS 13-11 & 2-30, 101 LEGION WAY, CITY OF EAST PROVIDENCE, PREPARED BY PRINCIPE COMPANY, INC. DATED MAY 18, 2023
3. EXISTING CONDITIONS PLAN SUPPLEMENTED BY TOWN OF EAST PROVIDENCE GIS DATA, STATE LIDAR, AND LIMITED FIELD MEASUREMENTS TAKEN BY PARE CORPORATION ON JUNE 29, 2022.
3. WETLAND RESOURCES ARE SHOWN BASED ON THE RIDEM ENVIRONMENTAL RESOURCE MAP WETLAND RESOURCE LAYER AND A FIELD REVIEW CONDUCTED BY PARE CORPORATION ON JULY 7, 2022. THE WETLAND EDGE WAS NOT FIELD DELINEATED AND IS APPROXIMATE.

GENERAL NOTES

- 1. PER AVAILABLE RIDEM MAPPING, THE PROJECT SITE IS LOCATED OUTSIDE A NATURAL HERITAGE AREA.
2. THE STATE OF RHODE ISLAND STANDARD SPECIFICATIONS FOR ROAD AND BRIDGE CONSTRUCTION, AMENDED MARCH 2018 WITH ALL REVISIONS AND ADDENDA, AND THE RHODE ISLAND STANDARD DETAILS ARE MADE A PART HEREOF AS FULLY AND COMPLETELY AS IF ATTACHED HERETO. ALL WORK SHALL MEET OR EXCEED THE RHODE ISLAND STANDARD SPECIFICATIONS FOR ROAD AND BRIDGE CONSTRUCTION, WITH LATEST REVISIONS. THE LATEST REVISION OF THE STANDARD SPECIFICATIONS MAY BE OBTAINED AT THE RHODE ISLAND DEPARTMENT OF TRANSPORTATION.
3. THE CONTRACTOR SHALL MAKE ALL NECESSARY CONSTRUCTION NOTIFICATIONS AND APPLY FOR AND OBTAIN ALL NECESSARY CONSTRUCTION PERMITS, PAY ALL FEES AND POST ALL BONDS ASSOCIATED WITH THE SAME, AND COORDINATE WITH THE ENGINEER AND OWNER'S REPRESENTATIVE AS REQUIRED.
4. THE CONTRACTOR SHALL BE SOLELY RESPONSIBLE FOR JOB SITE SAFETY. THE CONTRACTOR SHALL PROVIDE TEMPORARY FENCING AND/OR BARRIERS AROUND ALL OPEN EXCAVATED AREAS IN ACCORDANCE WITH OSHA FEDERAL, STATE, AND LOCAL REQUIREMENTS.
5. THE CONTRACTOR SHALL BE RESPONSIBLE FOR VERIFYING THAT THE PROPOSED IMPROVEMENTS SHOWN ON THE PLANS DO NOT CONFLICT WITH ANY KNOWN EXISTING OR OTHER PROPOSED IMPROVEMENTS. IF ANY CONFLICTS ARE DISCOVERED, THE CONTRACTOR SHALL NOTIFY THE OWNER AND THE ENGINEER PRIOR TO INSTALLATION OF ANY PORTION OF THE SITE WORK WHICH WOULD BE AFFECTED. NO FIELD ADJUSTMENTS IN THE LOCATION OF SITE ELEMENTS SHALL BE MADE WITHOUT THE ENGINEER'S APPROVAL.
6. IF ANY DEVIATION OR ALTERATION OF THE WORK PROPOSED ON THESE DRAWINGS IS REQUIRED, THE CONTRACTOR SHALL IMMEDIATELY CONTACT AND COORDINATE ANY DEVIATIONS WITH THE ENGINEER AND OWNER.
7. ANY AREA OUTSIDE OF THE LIMIT OF WORK THAT IS DISTURBED SHALL BE RESTORED TO ITS ORIGINAL CONDITION AT NO ADDITIONAL COST TO THE OWNER.
8. ALL SITE WORK SHALL MEET OR EXCEED THE SITE WORK SPECIFICATIONS PREPARED FOR THIS PROJECT.
9. ALL SIGNS SHALL BE REFLECTORIZED TYPE III SHEETING AND CONFORM WITH THE MANUAL OF UNIFORM TRAFFIC CONTROL DEVICES (MUTCD), LATEST REVISION.
10. ALL UTILITIES (LOCATION AND ELEVATION) DEPICTED SHALL BE CONSIDERED APPROXIMATE ONLY. BEFORE COMMENCING SITE WORK IN ANY AREA, CONTACT "DIG SAFE" AT 1-888-DIG-SAFE (1-888-344-7233) TO ACCURATELY LOCATE UNDERGROUND UTILITIES. ANY DAMAGE TO EXISTING UTILITIES OR STRUCTURES AND THE COST TO REPAIR THE DAMAGES TO INITIAL CONDITIONS, AS DEPICTED ON THE PLANS, SHALL BE THE CONTRACTOR'S RESPONSIBILITY.
11. NO EXCAVATION SHALL BE DONE UNTIL UTILITY COMPANIES ARE PROPERLY NOTIFIED IN ADVANCE. NOTE THAT NOT ALL EXISTING UNDERGROUND UTILITIES ARE SHOWN. IT IS THE CONTRACTOR'S RESPONSIBILITY TO CONTACT ALL RESPECTIVE UTILITY COMPANIES TO VERIFY AND LOCATE EXISTING UTILITIES.

LAYOUT NOTES

- 1. ALL LINES ARE PERPENDICULAR OR PARALLEL TO THE LINES FROM WHICH THEY ARE MEASURED UNLESS OTHERWISE INDICATED.
2. ACCESSIBLE RAMPS SHALL BE PER THE AMERICANS WITH DISABILITIES ACT (ADA) ACCESSIBILITY GUIDELINES.
3. PRIOR TO COMMENCING WORK, THE CONTRACTOR SHALL PERFORM BENCHMARK FIELD LEVEL VERIFICATION AND COORDINATE LAYOUT CHECK. THE CONTRACTOR SHALL CONTACT PARE CORPORATION IF ANY DISCREPANCIES ARE FOUND.
4. DIMENSIONS OF PARKING SPACES AND DRIVEWAYS ARE FROM FACE OF CURB TO FACE OF CURB. DIMENSIONS FROM BUILDING ARE FROM FACE OF BUILDING TO FACE OF CURB.
5. ALIGN WALKWAYS ON DOORWAYS THEY SERVE TO PROVIDE MINIMUM REQUIRED MANEUVERING CLEARANCE IN ACCORDANCE WITH THE AMERICAN WITH DISABILITIES ACT (ADA) ACCESSIBILITY GUIDELINES.

DEMOLITION NOTES

- 1. THE CONTRACTOR SHALL COORDINATE ALL DEMOLITION OF STRUCTURES, PAVEMENT AND CONCRETE MATERIALS, AND UTILITIES WITH APPROPRIATE PROPOSED SITE GENERAL, GRADING, UTILITY, AND LANDSCAPING DRAWINGS.
2. ALL NOTED UTILITIES TO BE REMOVED AND DISPOSED OF, RELOCATED OR CAPPED REPRESENT ALL KNOWN SITE CONDITIONS TO BE DEMOLISHED. THE CONTRACTOR SHALL COORDINATE ALL UNFORESEEN CONDITIONS WITH THE PROJECT ENGINEER, OWNER AND/OR RESPECTIVE UTILITY COMPANIES PRIOR TO PROCEEDING WITH WORK.
3. WATER, SEWER, DRAINAGE, GAS, AND OTHER SITE UTILITIES SERVICING THE EXISTING FACILITIES ARE TO REMAIN ACTIVE THROUGHOUT CONSTRUCTION. THERE SHALL BE NO INTERRUPTION OF UTILITY SERVICES DURING THE CONSTRUCTION OPERATION WITHOUT APPROVAL FROM THE OWNER.

GRADING AND UTILITY NOTES

- 1. UNDERGROUND UTILITIES DEPICTED WERE COMPILED FROM AVAILABLE RECORD PLANS AND SHALL BE CONSIDERED APPROXIMATE ONLY. BEFORE COMMENCING SITE WORK IN ANY AREA, CONTACT "DIG SAFE" AT 1-888-DIG-SAFE (1-888-344-7233) TO ACCURATELY LOCATE UNDERGROUND UTILITIES. ANY DAMAGE TO EXISTING UTILITIES OR STRUCTURES DEPICTED OR NOT DEPICTED ON THE PLANS SHALL BE THE CONTRACTOR'S RESPONSIBILITY. COSTS TO REPAIR SUCH DAMAGES SHALL BE THE CONTRACTOR'S RESPONSIBILITY. NO EXCAVATION SHALL BE DONE UNTIL UTILITY COMPANIES ARE PROPERLY NOTIFIED.
2. ALL WORK PERFORMED AND ALL MATERIALS FURNISHED SHALL CONFORM WITH THE LINES AND GRADES ON THE PLANS AND SITE WORK SPECIFICATIONS.
3. AT ALL LOCATIONS WHERE EXISTING CURBING OR PAVEMENT ABUT NEW CONSTRUCTION, THE EDGE OF THE EXISTING CURB OR PAVEMENT SHALL BE SAWCUT TO A CLEAN, SMOOTH EDGE. BLEND NEW PAVEMENT AND CURBS SMOOTHLY INTO EXISTING BY MATCHING LINES, GRADES AND JOINTS.
4. ALL UTILITY COVERS, GRATES, ETC. SHALL BE ADJUSTED TO BE FLUSH WITH THE SURROUNDING SURFACE OR PAVEMENT FINISH GRADE. RIM ELEVATIONS OF STRUCTURES AND MANHOLES ARE APPROXIMATE. FINAL ELEVATIONS ARE TO BE SET FLUSH AND CONSISTENT WITH THE GRADING PLANS.
5. THE CONTRACTOR SHALL MAKE ALL ARRANGEMENTS FOR THE ALTERATION OF PRIVATE UTILITIES BY THE UTILITY COMPANIES, AS REQUIRED.
6. WHERE AN EXISTING UTILITY IS FOUND TO CONFLICT WITH THE PROPOSED WORK, THE LOCATION, ELEVATION AND SIZE OF THE UTILITY SHALL BE ACCURATELY DETERMINED WITHOUT DELAY BY THE CONTRACTOR AND THE INFORMATION SHALL BE PROVIDED ON A SKETCH TO SCALE OF THE EXISTING UTILITY WITH TIES TO KNOWN POINTS, PHOTOS AND FURNISHED TO THE ENGINEER FOR RESOLUTION.
7. THE CONTRACTOR SHALL PROTECT ALL UNDERGROUND DRAINAGE, SEWER AND UTILITY FACILITIES FROM EXCESSIVE VEHICULAR LOADS DURING CONSTRUCTION. ANY DAMAGE TO THESE FACILITIES RESULTING FROM CONSTRUCTION LOADS SHALL BE RESTORED TO ORIGINAL CONDITION AT NO ADDITIONAL COST TO THE OWNER.
8. DURING CONSTRUCTION OPERATIONS, THE CONTRACTOR SHALL PROTECT EXISTING UTILITIES BY PROVIDING TEMPORARY SUPPORTS OR SHEETING AS REQUIRED AT NO ADDITIONAL COST TO THE OWNER.
9. ALL GRAVITY SANITARY PIPING SHALL BE SDR-35 PVC. ALL SEWER CONSTRUCTION SHALL CONFORM TO THE CITY OF EAST PROVIDENCE SEWER DEPARTMENT.
10. ALL WATER LINE BENDS AND TEES SHALL BE REINFORCED WITH THRUST BLOCKS. ALL WATER DISTRIBUTION PIPING AND FITTINGS MUST ADHERE TO THE EAST PROVIDENCE WATER UTILITIES DIVISION SPECIFICATIONS AND SHALL BE INSPECTED BEFORE, DURING, AND AFTER CONSTRUCTION PRIOR TO TAPPING THE SERVICE MAIN. THE CONTRACTOR SHALL COORDINATE AND CONFIRM ALL WATER DISTRIBUTION MATERIAL PRODUCTS WITH THE EAST PROVIDENCE WATER UTILITIES DIVISION PRIOR TO ORDERING OR PURCHASING PRODUCTS.
11. EXCAVATION REQUIRED WITHIN THE PROXIMITY OF EXISTING UTILITY LINES SHALL BE DONE BY HAND. CONTRACTOR SHALL REPAIR ANY DAMAGE TO EXISTING UTILITY LINES OR STRUCTURES INCURRED DURING CONSTRUCTION OPERATIONS AT NO ADDITIONAL COST TO THE OWNER.
12. PITCH EVENLY BETWEEN SPOT GRADES. ALL PAVED AREAS MUST PITCH TO DRAIN AT A MIN. OF 1/8" PER FOOT UNLESS SPECIFIED OTHERWISE.
13. THE PROPOSED WALKWAYS SHALL HAVE A MAXIMUM CROSS SLOPE OF 2% AND A MAXIMUM RUNNING SLOPE OF 5% AS SHOWN ON CONSTRUCTION DETAILS AND GRADING PLAN.

EROSION AND SEDIMENTATION CONTROL NOTES - RHODE ISLAND

- 1. THE CONTRACTOR AND RELEVANT SUBCONTRACTORS SHALL READ AND UNDERSTAND THE FRESHWATER WETLANDS PERMIT. ALL EROSION CONTROLS SHALL BE IN ACCORDANCE WITH THE RHODE ISLAND SOIL EROSION AND SEDIMENT CONTROL HANDBOOK, LATEST REVISION.
2. THE CONTRACTOR SHALL BECOME FAMILIAR WITH THE CONDITIONS ISSUED FOR THE PROJECT BY RIDEM AND BE RESPONSIBLE FOR CONFORMANCE WITH ALL PERMIT REQUIREMENTS AND CONSTRUCTION DOCUMENTS.
3. THE CONTRACTOR SHALL BE RESPONSIBLE FOR ESTABLISHING OR INSTALLING ALL TEMPORARY SEDIMENT AND EROSION CONTROLS AS SHOWN ON THESE PLANS AND SHALL MAINTAIN ALL EROSION CONTROL MEASURES AS NECESSARY DURING THE ENTIRE CONSTRUCTION PERIOD.
4. ANTI-TRACKING PADS (R.I. STD. DETAIL 9.9.0) SHALL BE PROVIDED AT ALL POINTS OF VEHICULAR INGRESS AND EGRESS ON THE CONSTRUCTION SITE AND SHALL BE MAINTAINED TO LIMIT TRACKING OR FLOWING OF SEDIMENT ONTO PUBLIC ROADS.
5. EROSION CONTROL BARRIERS SHALL BE INSTALLED AS SHOWN ON THE EROSION CONTROL PLAN PRIOR TO COMMENCEMENT OF CONSTRUCTION OPERATIONS.
6. SOIL EROSION AND SEDIMENTATION CONTROL MEASURES SHALL BE INSPECTED AND MAINTAINED ON A WEEKLY BASIS AND AFTER EACH STORM EVENT OF 0.25 INCH OR GREATER DURING CONSTRUCTION TO ENSURE THAT CHANNELS, DITCHES AND PIPES ARE CLEAR OF DEBRIS AND THAT THE EROSION CONTROL BARRIERS ARE INTACT. IDENTIFIED DEFICIENCIES SHALL BE CORRECTED IMMEDIATELY.
7. DUST SHALL BE CONTROLLED BY WATERING OR OTHER APPROVED METHODS AS NECESSARY, OR AS DIRECTED BY THE OWNER OR OWNER'S REPRESENTATIVE.
8. THE CONTRACTOR SHALL CLEAN AND MAINTAIN EROSION CONTROL BARRIER WHEN SEDIMENT ACCUMULATES TO ONE HALF THE HEIGHT OF THE BARRIER. MATERIAL COLLECTED FROM THE SEDIMENTATION BARRIERS SHALL BE REMOVED AS NECESSARY AND DISPOSED IN AN UPLAND AREA.
9. THE CONTRACTOR SHALL SCHEDULE HIS WORK TO ALLOW THE FINISHED SUBGRADE ELEVATIONS TO DRAIN PROPERLY WITHOUT PONDING. SPECIFICALLY, ALLOW WATER TO ESCAPE WHERE PROPOSED CURB MAY RETAIN RUNOFF PRIOR TO APPLICATION OF SURFACE PAVING. PROVIDE TEMPORARY POSITIVE DRAINAGE, AS REQUIRED, TO STABILIZED DISCHARGE POINTS.
10. INSTALLATION OF THE EROSION CONTROL BARRIERS AS ILLUSTRATED IS INTENDED TO REPRESENT THE MINIMUM SEDIMENTATION CONTROL FACILITIES NECESSARY TO MEET ANTICIPATED SITE CONDITIONS. ADDITIONAL EROSION CONTROL MEASURES SHALL BE IMPLEMENTED AS CONDITIONS WARRANT OR AS DIRECTED BY THE OWNER OR OWNER'S REPRESENTATIVE.
11. REQUIRED SEDIMENTATION CONTROL FACILITIES MUST BE PROPERLY ESTABLISHED, CLEARLY VISIBLE AND IN OPERATION PRIOR TO INITIATING ANY LAND CLEARING ACTIVITY AND/OR OTHER CONSTRUCTION RELATED WORK. SUCH FACILITIES SHALL REPRESENT THE LIMIT OF WORK. WORKERS SHALL BE INFORMED THAT NO CONSTRUCTION ACTIVITY IS TO OCCUR BEYOND THE LIMIT OF WORK AT ANY TIME THROUGHOUT THE CONSTRUCTION PERIOD.
12. THE CONTRACTOR SHALL MAINTAIN A SUFFICIENT RESERVE OF VARIOUS EROSION CONTROL MATERIALS ONSITE AT ALL TIMES FOR EMERGENCY PURPOSES OR ROUTINE MAINTENANCE.
13. EXISTING AND NEWLY INSTALLED CATCH BASINS AND STORM DRAIN INLETS SHALL BE PROTECTED WITH APPROPRIATE TEMPORARY INLET PROTECTION IN ACCORDANCE WITH THE RHODE ISLAND SOIL EROSION AND SEDIMENT CONTROL HANDBOOK.
14. DEWATERING WASTE WATERS PUMPED FROM EXCAVATIONS SHALL BE CONVEYED BY HOSE TO AN UPLAND AREA AND DISCHARGED INTO STRAW BALE CORRALS OR SEDIMENTATION BAGS.
15. THE CONTRACTOR SHALL NOT REMOVE ANY TEMPORARY SEDIMENT CONTROL BARRIERS UNTIL THE CONTRIBUTING DRAINAGE AREA HAS BEEN PERMANENTLY STABILIZED.
16. CONSTRUCTION SITE WASTE MATERIALS SHALL BE PROPERLY CONTAINED ONSITE AND DISPOSED OFF SITE AT A LOCATION IN ACCORDANCE WITH THE LOCAL AND STATE REGULATIONS.
17. RIP-RAP OR OTHER ENERGY DISSIPATORS SHALL BE USED WHERE NECESSARY TO PREVENT SCOUR.
18. ALL DISTURBED AREAS SHALL BE STABILIZED WITHIN 14 DAYS UPON COMPLETION OF WORK IN THAT AREA.
19. ALL DRAINAGE STRUCTURES SHALL BE CLEARED OF ACCUMULATED SEDIMENT PRIOR TO ACCEPTANCE OF FINAL PROJECT.
20. NEWLY VEGETATED AREAS SHALL BE MAINTAINED REGULARLY TO ENSURE STABLE VEGETATED SURFACES.
21. EROSION AND SEDIMENTATION CONTROLS SHALL BE UTILIZED AS SHOWN ON THE PLANS. POTENTIAL EROSION AND SEDIMENTATION PROBLEMS ASSOCIATED WITH THE CONSTRUCTION OF THE PROJECT SHALL BE AVOIDED THROUGH THE PROJECT SCHEDULING AND THE USE OF APPROPRIATE STANDARD CONTROLS (RHODE ISLAND SOIL EROSION AND SEDIMENTATION CONTROL HANDBOOK) AS ILLUSTRATED ON THE PROJECT PLANS.
22. WHERE EROSION CONTROLS ARE NEEDED ON IMPERVIOUS SURFACES, THE CONTRACTOR SHALL PROVIDE SAND BAG EROSION CONTROL BARRIER.
23. TEMPORARY DIVERSION (TD) MAY CONSIST OF A DITCH OR SWALE, OR MAY BE ACHIEVED USING WOOD CHIPS, COIR LOGS, OR SIMILAR MATERIALS.
24. TEMPORARY SEDIMENT TRAPS (TST) AND TEMPORARY SWALES (TSW) SHALL BE SIZED BY THE CONTRACTOR USING THE PARAMETERS CONTAINED IN THE RHODE ISLAND SOIL EROSION AND SEDIMENT CONTROL HANDBOOK.

STORMWATER MANAGEMENT SYSTEM INSPECTION AND MAINTENANCE NOTES

DURING CONSTRUCTION (CONTRACTOR'S RESPONSIBILITY)

- 1. THE CONTRACTOR SHALL REMOVE SEDIMENT AND DEBRIS FROM ALL CATCH BASINS, MANHOLES, AND THE DRAINAGE SYSTEM ON A ROUTINE BASIS, IMMEDIATELY FOLLOWING SITE STABILIZATION, AND PRIOR TO PROJECT COMPLETION AND ACCEPTANCE.
2. THE CLOSED DRAINAGE SYSTEM AND ASSOCIATED STRUCTURES SHALL BE CLEANED AND FLUSHED BY THE CONTRACTOR AT THE COMPLETION OF CONSTRUCTION, AND THE CONTRACTOR SHALL BE RESPONSIBLE FOR INSPECTION AND MAINTENANCE OF THE DRAINAGE SYSTEM UNTIL ACCEPTANCE OF THE SYSTEM BY THE ENGINEER AND THE CITY OF EAST PROVIDENCE. FOLLOWING ACCEPTANCE OF THE PROPOSED DRAINAGE SYSTEM, THE OWNER OF THE SITE SHALL BE RESPONSIBLE FOR THE LONG-TERM INSPECTION AND MAINTENANCE OF THE DRAINAGE SYSTEM.
3. ANY ACCUMULATION OF PONDING WATER IN AREAS WITHIN THE LIMITS OF DISTURBANCE, OTHER THAN DESIGNATED AREAS, SHALL BE REMOVED ACCORDINGLY AND PREVENTED IN THE FUTURE.

POST CONSTRUCTION (OWNER'S RESPONSIBILITY)

- 1. TRASH, LITTER, SEDIMENT AND OTHER DEBRIS SHALL BE REMOVED FROM ANY STORMWATER MANAGEMENT SYSTEM FACILITY (INCLUDING BUT NOT LIMITED TO CATCH BASINS, MANHOLES, INLET, OUTLET AND DIVERSION STRUCTURES, AND STORMWATER BEST MANAGEMENT PRACTICES (BMPs)) A MINIMUM OF TWO TIMES PER YEAR, PREFERABLY IN THE SPRING AND FALL.
2. THE PARKING LOT AND ENTRY DRIVE SHALL BE SWEEP BY THE OWNER AS EARLY AS POSSIBLE EVERY SPRING AND ONCE IN THE FALL TO REMOVE SEDIMENTS.
3. ALL CLEANING AND MAINTENANCE OF STORMWATER MANAGEMENT SYSTEMS POST-CONSTRUCTION SHALL BE THE RESPONSIBILITY OF THE OWNER.

QUALIFYING PVIOUS AREA INSPECTION, MAINTENANCE, AND REPAIR NOTES

FOLLOWING CONSTRUCTION, THE COMPLETION OF THE INSPECTION AND MAINTENANCE REQUIREMENTS BELOW SHALL BE THE RESPONSIBILITY OF THE OWNER.

- 1. THE QUALIFYING PVIOUS AREAS (QPA'S) MUST BE INSPECTED A MINIMUM OF TWO TIMES PER YEAR FOR SEDIMENT, PONDING, EROSION, AND VEGETATION.
2. REMOVE ACCUMULATED SEDIMENT FROM THE QPA'S IF SEDIMENT EXCEEDS 1".
3. OWNER SHALL REPAIR ANY SLOPES THAT HAVE BEEN DAMAGED DUE TO EROSION OR OTHER MEANS. OWNER SHALL REPLACE ANY VEGETATION THAT HAS DIED OR BEEN DAMAGED.
4. OWNER SHALL MOW GRASS WITHIN THE QPA A MINIMUM OF TWO TIMES ANNUALLY TO MAINTAIN A MINIMUM GRASS HEIGHT OF 6".
5. TRASH AND DEBRIS SHALL BE REMOVED FROM THE QPA'S AS NECESSARY.

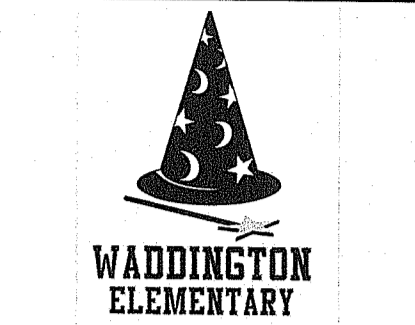

Alice M. Waddington Elementary
101 Legion Way
Riverside, Rhode Island, 02915
Map 612, Block 13, Lot 011

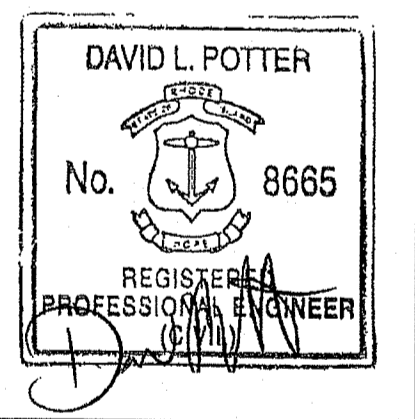

REVISIONS:

Table with 2 columns: Description, Date. Contains revision entries.

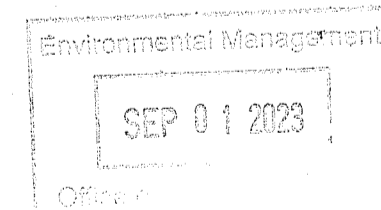

RI DEPARTMENT OF ENVIRONMENTAL MANAGEMENT

OFFICE OF WATER RESOURCES
FRESHWATER WETLANDS PROGRAM

APPROVED WITH CONDITIONS AS SPECIFIED IN THE LETTER OF APPROVAL

DATE: OCT 16 2023 FILE #: 23-0190

NO CHANGES ALLOWED WITHOUT PRIOR APPROVAL
APPROVED PLANS MUST BE AT CONSTRUCTION SITE

Signature of David L. Potter

PROJECT NO.: 22037.04
DATE: SEPTEMBER 1, 2023
SCALE: NOT TO SCALE
DESIGNED BY: NPC/CVH
CHECKED BY: NPC
DRAWN BY: SETB
APPROVED BY: DLP
DRAWING TITLE:

NOTES

DRAWING NO.: C1.1
SHEET NO. 2 OF 9

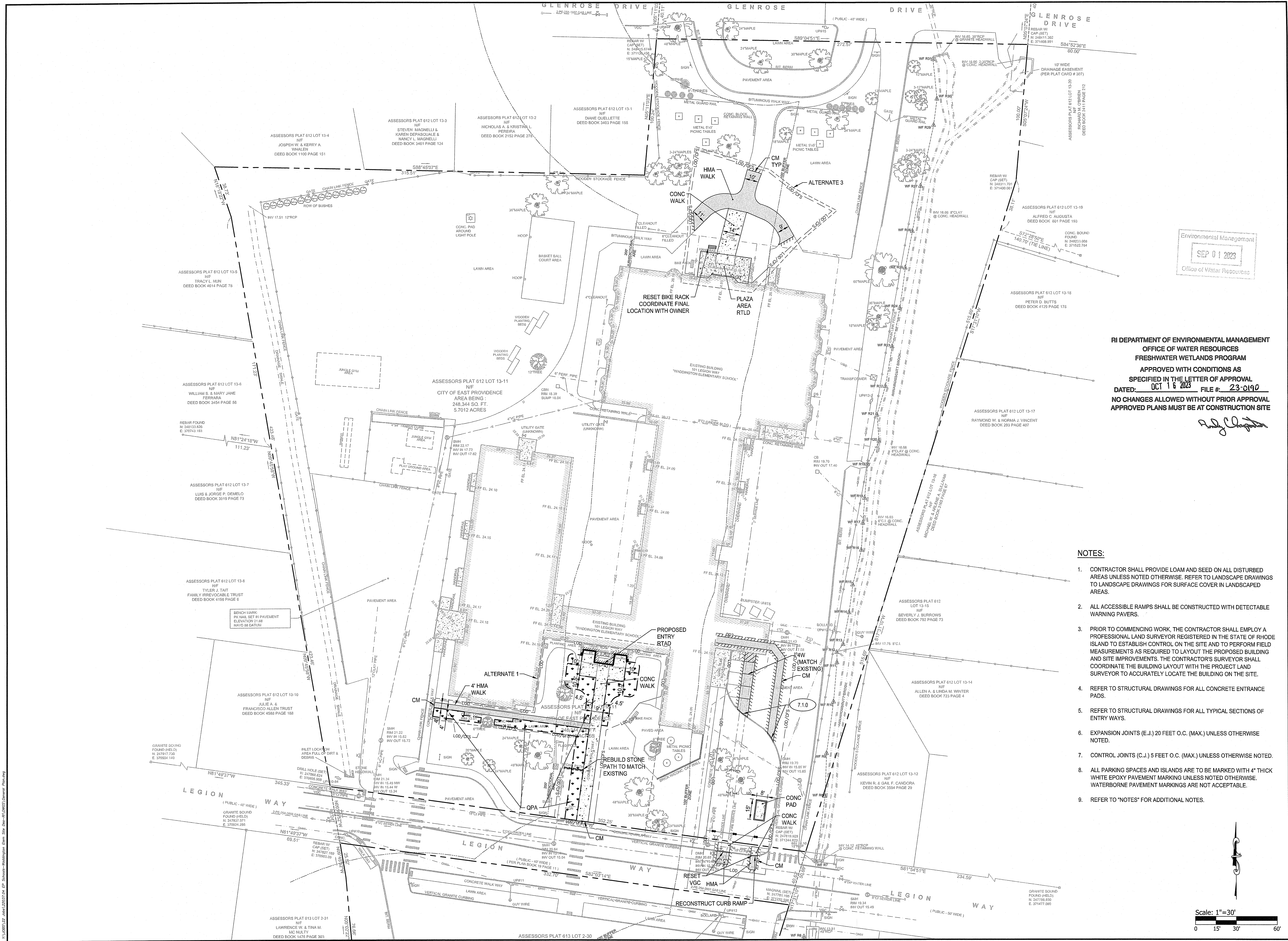

Environmental Management
 SEP 01 2023
 Office of Water Resources

RI DEPARTMENT OF ENVIRONMENTAL MANAGEMENT
 OFFICE OF WATER RESOURCES
 FRESHWATER WETLANDS PROGRAM
 APPROVED WITH CONDITIONS AS
 SPECIFIED IN THE LETTER OF APPROVAL
 DATED: OCT 16 2023 FILE # 23-0190
 NO CHANGES ALLOWED WITHOUT PRIOR APPROVAL
 APPROVED PLANS MUST BE AT CONSTRUCTION SITE

Paul Cloutier

NOTES:

1. CONTRACTOR SHALL PROVIDE LOAM AND SEED ON ALL DISTURBED AREAS UNLESS NOTED OTHERWISE. REFER TO LANDSCAPE DRAWINGS TO LANDSCAPE DRAWINGS FOR SURFACE COVER IN LANDSCAPED AREAS.
2. ALL ACCESSIBLE RAMPS SHALL BE CONSTRUCTED WITH DETECTABLE WARNING PAVERS.
3. PRIOR TO COMMENCING WORK, THE CONTRACTOR SHALL EMPLOY A PROFESSIONAL LAND SURVEYOR REGISTERED IN THE STATE OF RHODE ISLAND TO ESTABLISH CONTROL ON THE SITE AND TO PERFORM FIELD MEASUREMENTS AS REQUIRED TO LAYOUT THE PROPOSED BUILDING AND SITE IMPROVEMENTS. THE CONTRACTOR'S SURVEYOR SHALL COORDINATE THE BUILDING LAYOUT WITH THE PROJECT LAND SURVEYOR TO ACCURATELY LOCATE THE BUILDING ON THE SITE.
4. REFER TO STRUCTURAL DRAWINGS FOR ALL CONCRETE ENTRANCE PADS.
5. REFER TO STRUCTURAL DRAWINGS FOR ALL TYPICAL SECTIONS OF ENTRY WAYS.
6. EXPANSION JOINTS (E.J.) 20 FEET O.C. (MAX.) UNLESS OTHERWISE NOTED.
7. CONTROL JOINTS (C.J.) 5 FEET O.C. (MAX.) UNLESS OTHERWISE NOTED.
8. ALL PARKING SPACES AND ISLANDS ARE TO BE MARKED WITH 4" THICK WHITE EPOXY PAVEMENT MARKINGS UNLESS NOTED OTHERWISE. WATERBORNE PAVEMENT MARKINGS ARE NOT ACCEPTABLE.
9. REFER TO "NOTES" FOR ADDITIONAL NOTES.

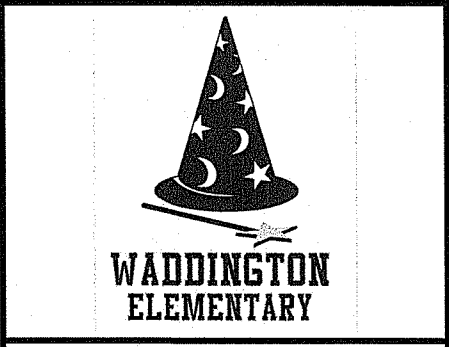

Alice M. Waddington Elementary
 101 Legion Way
 Riverside, Rhode Island, 02915
 Map 612, Block 13, Lot 011

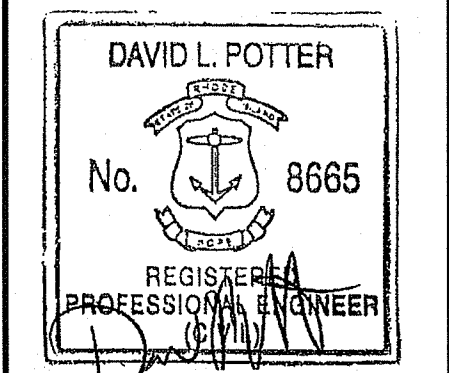

REVISIONS:

NO.	DATE	DESCRIPTION

PROJECT NO.: 22037.04
 DATE: SEPTEMBER 1, 2023
 SCALE: 1" = 30'
 DESIGNED BY: NPC/CVH
 CHECKED BY: NPC
 DRAWN BY: SETB
 APPROVED BY: DLP
 DRAWING TITLE: GENERAL PLAN

DRAWING NO.: C3.1
 SHEET NO. 5 OF 9

