

NOTES:

- EXISTING CONDITIONS INFORMATION WAS COMPILED FROM AN ON THE GROUND SURVEY PERFORMED BY LAND DEVELOPMENT ENGINEERING & CONSULTING, LLC BETWEEN SEPTEMBER 5, 2023 AND SEPTEMBER 7, 2023. PROPERTY LINES ARE APPROXIMATE.
- THE SITE IS NOT LOCATED WITHIN ANY KNOWN SPECIAL FLOOD HAZARD AREAS AS DETERMINED FROM THE TOWN OF MIDDLETOWN FEDERAL EMERGENCY MANAGEMENT AGENCY FLOOD INSURANCE RATE MAP COMMUNITY-PANEL NUMBER 44005 C 0091 J (MAP EFFECTIVE DATE SEPTEMBER 4, 2013).
- THIS PLAN AND ANY ACCOMPANYING CERTIFICATIONS DO NOT CONSTITUTE A CERTIFICATION OF TITLE TO THE PROPERTY DISPLAYED HEREON. THE OWNER OF LOCUS AND ABUTTING PROPERTIES ARE SHOWN ACCORDING TO CURRENT TOWN ASSESSORS RECORDS.
- RIVER BANK DELINEATED ON 7/20/2023 BY NATURAL RESOURCE SERVICES, INC. AND SHOWN IN WETLANDS REPORT TITLED "FRESHWATER WETLAND DELINEATION" BY NATURAL RESOURCE SERVICES, INC. DATED JULY 25, 2023. THIS DELINEATION ENCOMPASSES FLAGS SB-1 TO SB-2 & SB-5 TO SB-10.
- SUBSEQUENT RIVER BANK DELINEATION PERFORMED ON 3/8/2023 BY NATURAL RESOURCE SERVICES, INC. THIS DELINEATION ENCOMPASSES FLAGS SB-3, SB-3A & SB-4.
- THE APPLICANT SHALL SEEK THE REQUIRED PERMITS FROM RIDEM AS NECESSARY PRIOR TO SEEKING A BUILDING PERMIT.

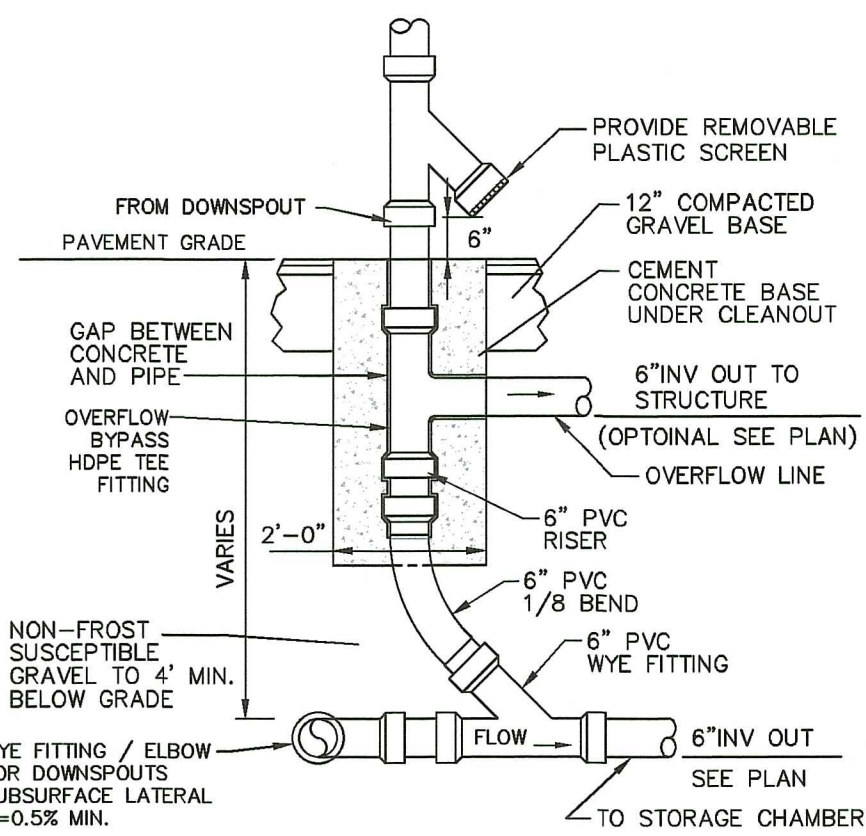

DOWNSPOUT CONNECTION & OVERFLOW DETAIL
NOT TO SCALE

R-20 RESIDENTIAL ZONING DISTRICT		
REGULATION	REQUIREMENT	PROPOSED
MIN. LOT AREA	20,000 SQ. FT.	30,715± SF
LOT FRONTAGE	120'	120'±
FRONT SETBACK	40'	111.8'±
SIDE SETBACK	20'	*15.0'±
REAR SETBACK	50'	96.7'±
BUILDING COVERAGE	20%	6.5%±
BUILDING HEIGHT	35'	-

*APPLICANT RECEIVED SUMMARY RELIEF FROM THE TOWN OF MIDDLETOWN FOR SIDE YARD SETBACK

LEGEND

BIT. CONC.	BITUMINOUS CONCRETE		HYDRANT
BM	BITUMINOUS BERM		LANDSCAPED AREAS
B	BUSH		LIGHT POLE
CC	CONCRETE CURB		MANHOLE
CONC.	CONCRETE		RIP RAP
CB	CATCH BASIN		SPOT ELEVATION
EH#	ELECTRIC HAND HOLE		STONE WALL
EM	ELECTRIC METER		TOPOGRAPHIC CONTOUR
X	FENCE (CHAIN LINK)		TREE
W	FENCE (WOODEN)		TREE LINE
G	GAS METER		UTILITY POLE
HP	HANDICAP PARKING		UNDERGROUND DRAIN

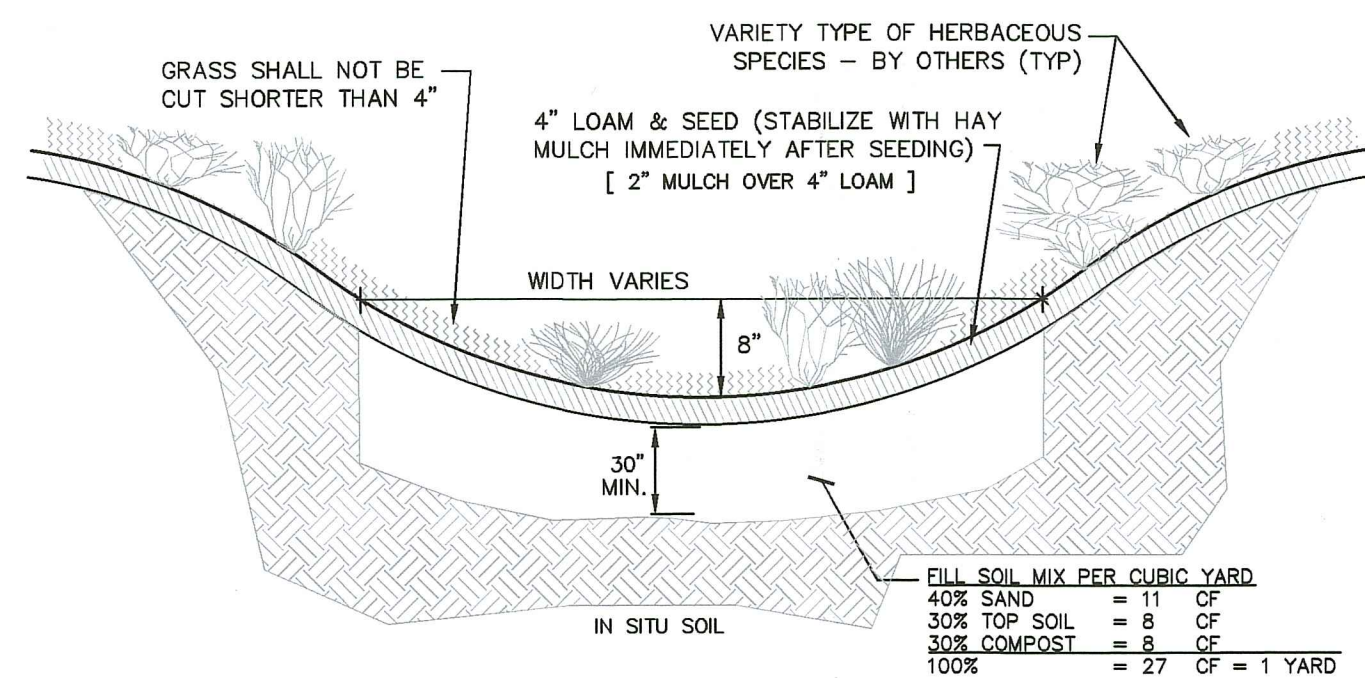

TYPICAL RAIN GARDEN DETAIL
NOT TO SCALE

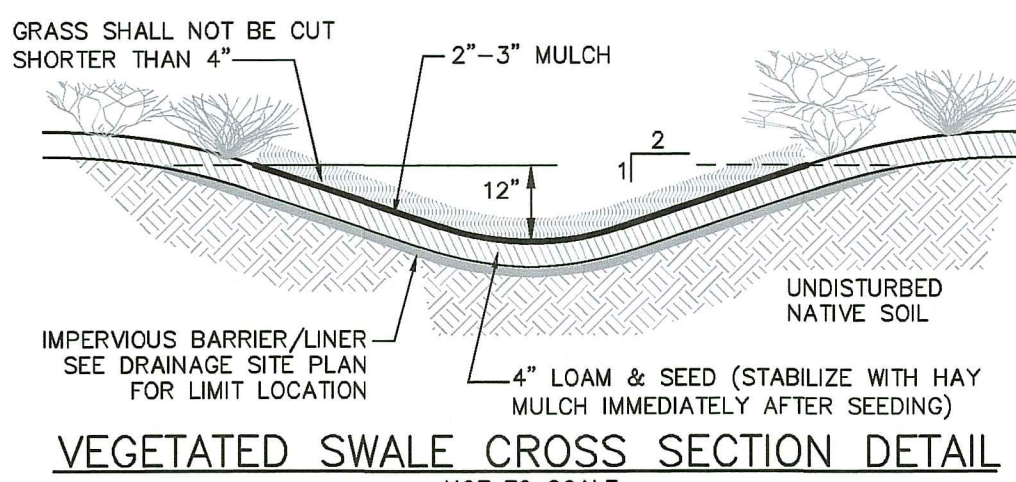

VEGETATED SWALE CROSS SECTION DETAIL
NOT TO SCALE

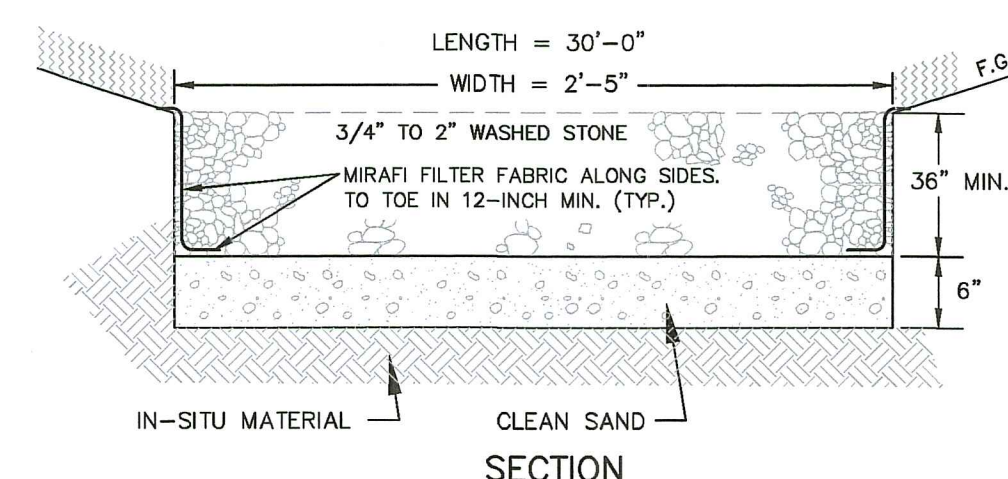

STONE-LINED INFILTRATION TRENCH DETAIL
NOT TO SCALE

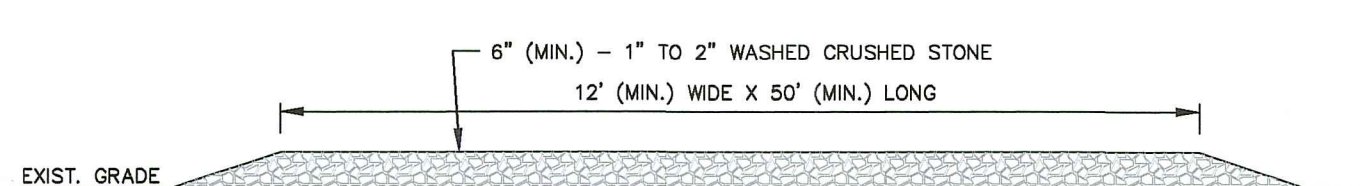

CONSTRUCTION ENTRANCE/EXIT PAD DETAIL
NOT TO SCALE

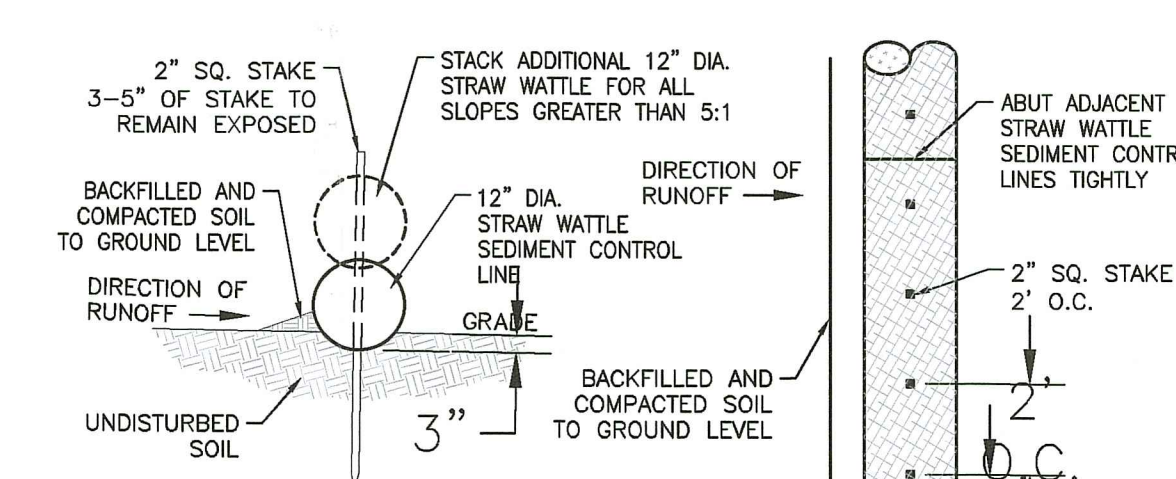

TYPICAL EROSION/SEDIMENT CONTROL STRAW WATTLE DETAIL
NOT TO SCALE

CURRENT OWNERS

ST BENEDICTS PREPARATORY SCHOOL INC
520 DR MARTIN LUTHER KING JR BLVD
NEWARK, NJ 07102

TITLE REFERENCE:
DEED BK.1752/Pg.1

SITE LOCATION:
7 J H DWYER DR
MIDDLETOWN, RHODE ISLAND

ASSESSORS REFERENCE:
MAP 105 PARCELS 432

(WQV) WATER QUALITY VOLUME CALCULATIONS:

TOTAL WQV

IMPERVIOUS AREA (ROOF)= 2,090 SF
WQV = 2,090 X (1/12) = 174.2 CF

INFILTRATION CHAMBER = 175.7 CF
STONE STORAGE = 179 CF
TOTAL STORAGE = 354.7 CF

IMPERVIOUS AREA (DRIVEWAY)= 960 SF
WQV = 960 X (1/12) = 80 CF

INFILTRATION TRENCH (30'L X 2.5'W X 3.5'D) X (33% VOID) = 86.6 CF

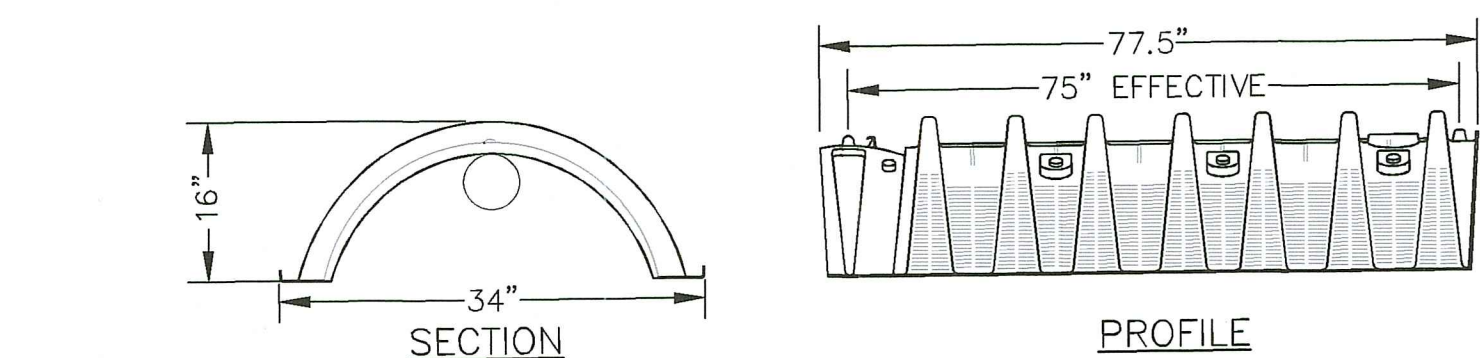

HIGH CAPACITY INFILTRATOR CHAMBER ROOF RECHARGE CHAMBER
NOT TO SCALE

NOTE:
CONTRACTOR TO SET CHAMBERS 2' (MIN) ABOVE SEASONAL HIGH GROUNDWATER AND PROVIDE A MINIMUM OF 18-INCHES OF COVER. CONSULT ENGINEER AS NECESSARY.
ALL ROOF DRAIN PIPE SHALL BE 4-INCH PVC SOH 40.
RECHARGE CHAMBERS TO BE PLACED ON 6\"/>

SOIL EROSION AND SEDIMENTATION CONTROL NOTES

- PRIOR TO INITIATING CONSTRUCTION, ALL SEDIMENTATION AND EROSION CONTROL MEASURES SHALL BE INSTALLED AS SHOWN ON THE PLANS, AS DIRECTED BY THE ENGINEER AND/OR AS NECESSITATED BY FIELD CONDITIONS. THE CONTRACTOR SHALL MAINTAIN THESE MEASURES UNTIL ALL WORK IS COMPLETED AND ALL AREAS HAVE BEEN STABILIZED.

INSTALLATION SEQUENCE

 - INSTALL SILT FENCE AND HAYBALES AS SHOWN ON PLAN.
 - CLEAR AND GRUB SITE.
 - CONSTRUCT SITE INFRASTRUCTURE AS SHOWN ON PLANS.
 - THE FOLLOWING ACTIVITIES SHALL TAKE PLACE IMMEDIATELY FOLLOWING CONSTRUCTION OF EMBANKMENTS AND FILL SLOPES: PLACEMENT OF LOAM AND GRASS SEED, INSTALLATION OF GEOWEB SLOPE STABILIZATION.
 - THE CONTRACTOR SHALL INSPECT ALL FILL SLOPES AND EMBANKMENTS ON A WEEKLY BASIS AND FOLLOWING ALL RAINFALL EVENTS UNTIL A MINIMUM 75% GRASS COVER IS ESTABLISHED SUFFICIENT TO PREVENT EROSION FROM OCCURRING.
- ACCUMULATED SEDIMENT SHALL BE REMOVED AND DISPOSED OF BY THE CONTRACTOR OR AS DIRECTED BY THE ENGINEER.
- AFTER THE INSTALLATION OF DRAINAGE STRUCTURES, HAYBALES OR OTHER APPROVED MATERIALS SHALL BE PLACED TO PROTECT THE INTEGRITY OF THE STRUCTURES.
- DISTURBED AREAS SHALL BE STABILIZED WITH THE APPLICATION OF A MINIMUM OF FOUR INCHES (4) OF LOAM AND SHALL BE SEEDING WITH AN APPROVED GRASS MIX OR SHALL BE RIPRAPPED AS SOON AS POSSIBLE AFTER THE FINISHED GRADE HAS BEEN MET. IF FINAL GRADING DOES NOT OCCUR DURING THE GROWING SEASON, THESE AREAS SHALL BE MULCHED WITH HAY AND SECURED BY JUTE NETTING WITH STAPLES. SLOPES EXCEEDING 2:1 SHALL BE LOAMED AND STABILIZED WITH PEGGED SOD OR APPROVED EROSION CONTROL BLANKETS UNLESS OTHERWISE NOTED.
- THE MOUTHS OF ALL CATCH BASINS SHALL BE FITTED WITH SILTSACK OR FILTER FABRIC DURING THE ENTIRE CONSTRUCTION PROCESS TO RETARD SILTATION.
- WHERE APPLICABLE, PROPER DUST CONTROL MEASURES SHALL APPLY TO REDUCE THE SURFACE AND AIR TRANSPORT OF DUST GENERATED DURING CONSTRUCTION. THE FOLLOWING METHODS SHALL BE USED:
 - WET SUPPRESSION WITHOUT WETTING AGENT SHALL BE APPLIED DURING LOAD IN / LOAD OUT AND EARTH MOVING CONSTRUCTION ACTIVITIES, SPECIALLY ON STOCKPILES.
 - INACTIVE STOCKPILES SHALL BE STABILIZED THROUGH APPLICATION OF SOIL STABILIZERS OR SEEDING.
 - WIND SCREENS OR BARRIERS AND PLASTIC TARP COVERS SHALL BE SECURED TO PREVENT WIND DISLODGE AND DAMAGE. ANY DAMAGES SHALL BE REPAIRED OR REPLACED IMMEDIATELY.
- CONTRACTOR SHALL CONSTRUCT A TEMPORARY CRUSHED STONE CONSTRUCTION ENTRANCE APPROXIMATELY DRIVEWAY WIDTH WIDE BY 50' LONG BY 6" DEEP FOR USE DURING CONSTRUCTION ACTIVITIES AS NECESSARY TO REMOVE SEDIMENT FROM VEHICLES. THE CONSTRUCTION ENTRANCE IS TO BE LOCATED AT THE ENTRANCE TO THE SITE FROM EXISTING ACCESS DRIVEWAY.
- DEWATERING OPERATIONS SHALL BE PROVIDED, IF REQUIRED; ALL DISCHARGE SHALL PASS THROUGH SEDIMENTATION CONTROL DEVICES TO PREVENT IMPACTS UPON WATER BODIES, BORDERING VEGETATED WETLANDS, DRAINAGE SYSTEMS AND ABUTTING PROPERTIES.

RI DEPARTMENT OF ENVIRONMENTAL MANAGEMENT
OFFICE OF WATER RESOURCES
FRESHWATER WETLANDS PROGRAM

APPROVED WITH CONDITIONS AS SPECIFIED IN THE LETTER OF APPROVAL
DATED: APR 30 2024 FILE #: 23-0209

NO CHANGES ALLOWED WITHOUT PRIOR APPROVAL
APPROVED PLANS MUST BE AT CONSTRUCTION SITE

⊗ Regional Buffer Markers (Permit Condition No. B) Per RI DEM.

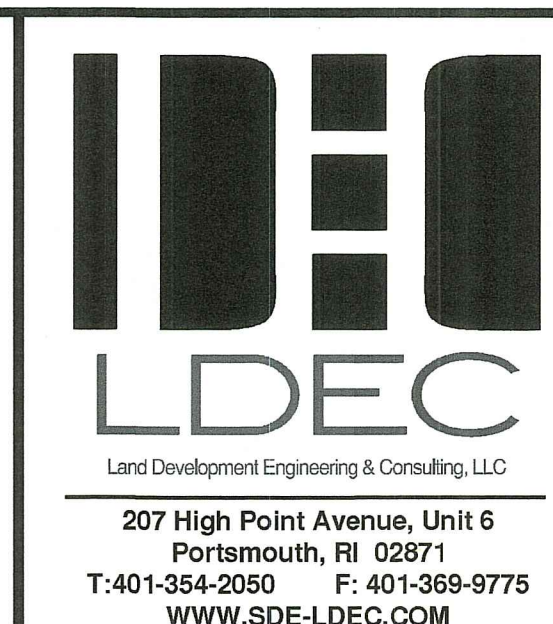
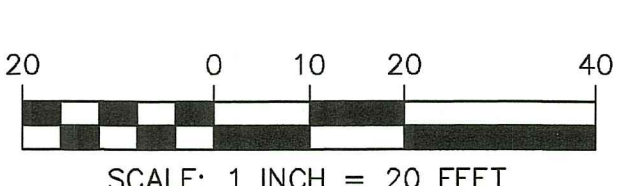
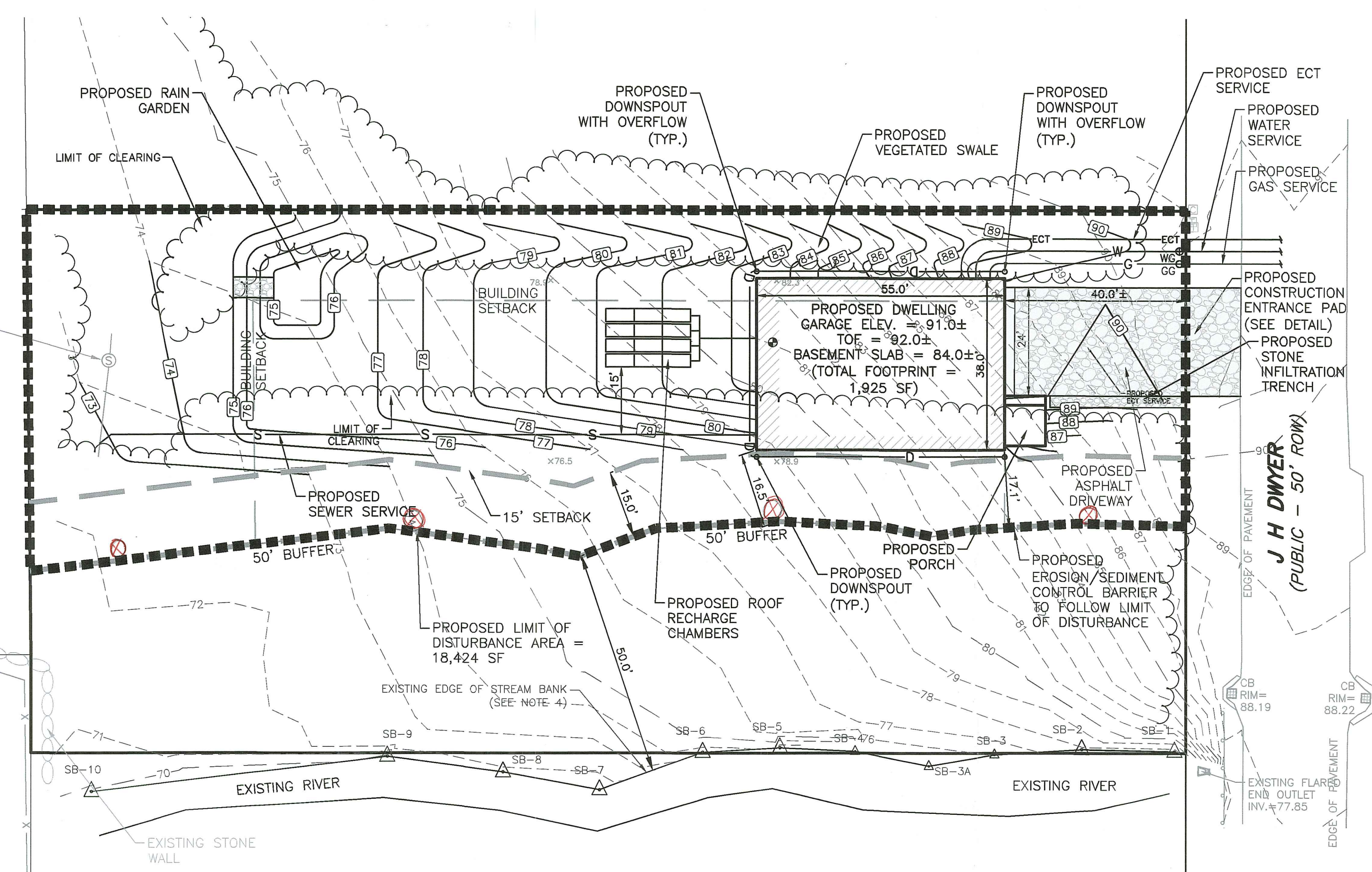

NO.	DATE	DESCRIPTION
1.	3/25/2024	GENERAL REVISIONS PER RIDEM COMMENTS

PLAN REVISIONS

DATE: NOVEMBER 16, 2023

DRAWN BY: SJE COMPS. BY: SJE CHECK BY: MER

PROJECT NO. 23057

ISSUED FOR: PERMITTING

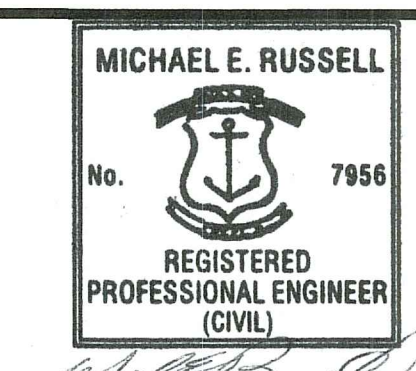

PROPOSED SITE PLAN
7 J H DWYER DRIVE
ASSESSOR'S MAP 105, PARCEL 432
MIDDLETOWN, RHODE ISLAND

APR - 4 2024

DRAWING TITLE:

PROPOSED SITE PLAN

SCALE: 1" = 20'

SHEET NO. 1 of 1

PREPARED FOR KIRK PICKELL