

STRAW WATTLE (OR SILT SOCK) DETAIL
NOT TO SCALE

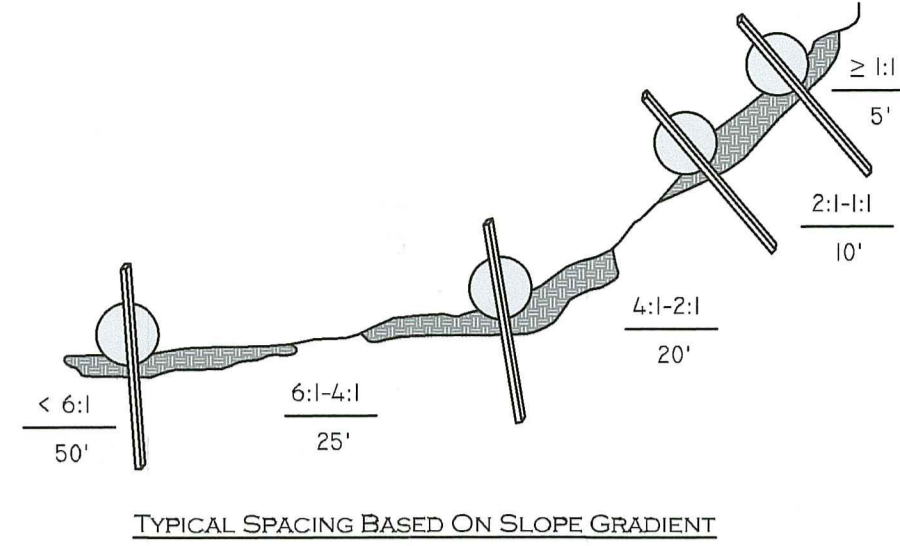

- EROSION & SEDIMENT STATION CONTROL:**
- BEGIN AT THE LOCATION WHERE WATTLE IS TO BE INSTALLED BY EXCAVATING 2-3" DEEP x 9" WIDE TRENCH ALONG THE CONTOUR OF THE SLOPE. EXCAVATED SOIL SHOULD BE PLACED UP SLOPE FROM THE ANCHOR TRENCH.
 - PLACE THE WATTLE IN THE TRENCH SO THAT IT CONTOURS TO THE SOIL SURFACE. COMPACT SOIL FROM THE EXCAVATED TRENCH AGAINST THE WATTLE ON THE UPHILL SIDE. ADJACENT WATTLES SHOULD TIGHTLY ABUT.
 - SECURE THE WATTLE WITH 18-24" STAKES EVERY 3-4' AND WITH A STAKE ON EACH END. STAKES SHOULD BE DRIVEN THROUGH THE MIDDLE OF THE WATTLE LEAVING AT LEAST 2-3" OF STAKE EXTENDING ABOVE THE STAKES SHOULD BE DRIVEN PERPENDICULAR TO SLOPE FACE.
 - CONTRACTOR IS RESPONSIBLE TO MAINTAIN INTEGRITY OF STRAW WATTLE FOR DURATION OF CONSTRUCTION.
 - EROSION CONTROLS TO REMAIN UNTIL SOIL CONDITIONS STABILIZE.
 - LOOSE HAY TO BE SPREAD ON AREAS OF EXPOSED LOAM & SEED UNTIL GERMINATION AND STABILIZATION OCCURS.

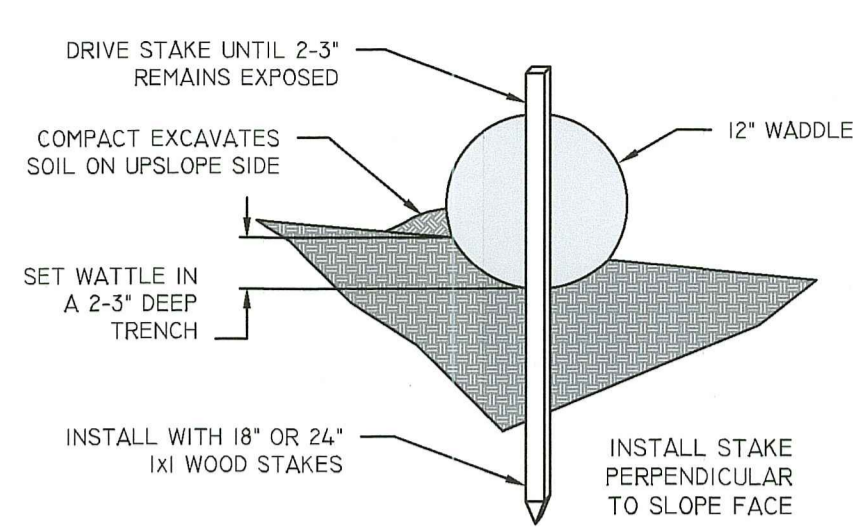

ACCESS ROUTE MAP
NOT TO SCALE

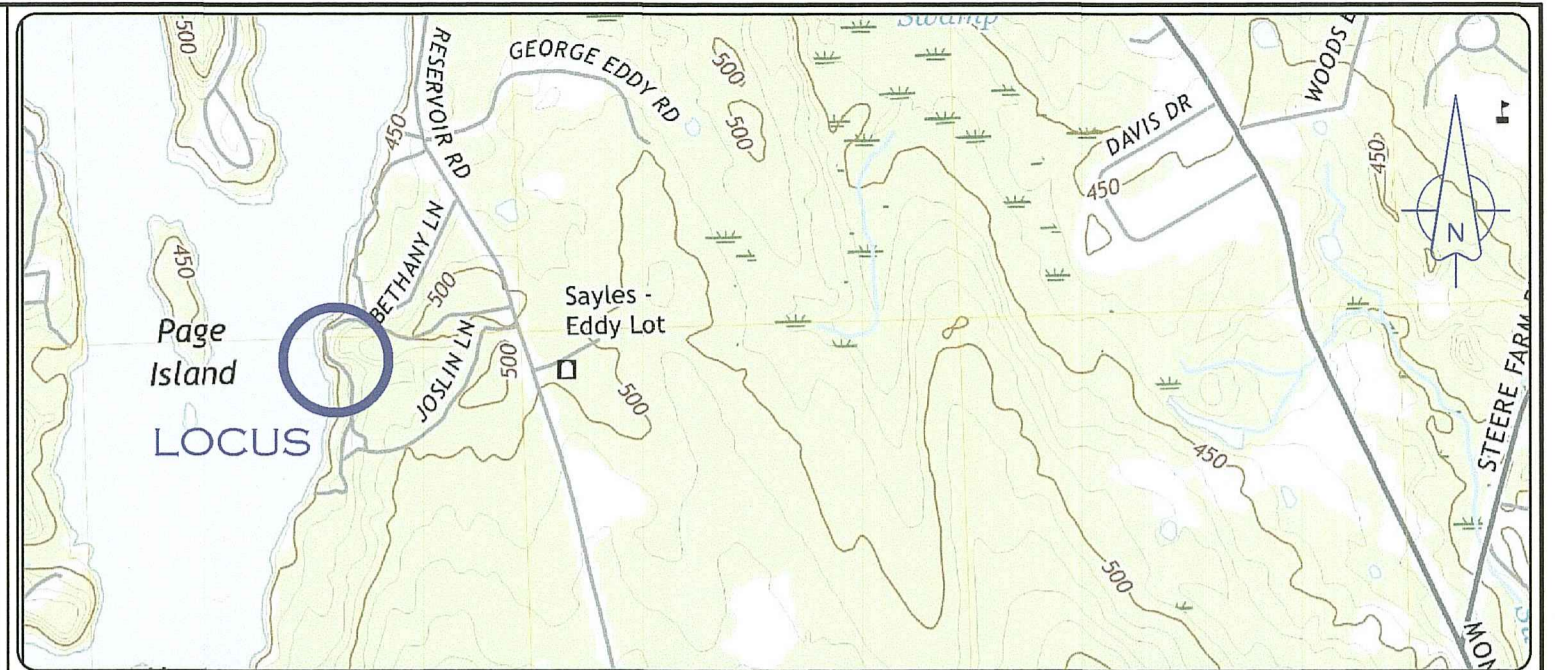

LOCATION MAP (NOT TO SCALE)

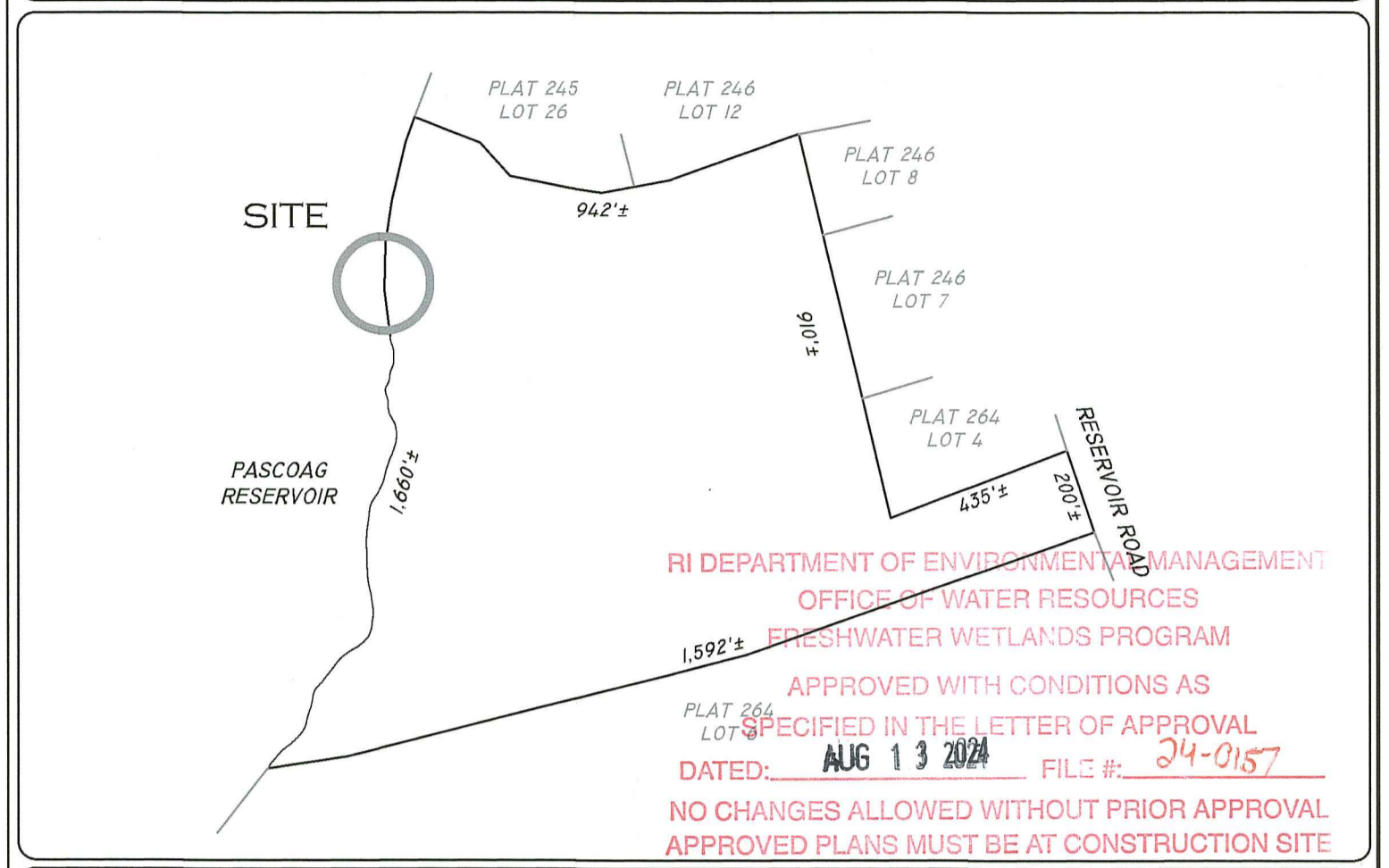

LOCUS MAP (NOT TO SCALE)

RI DEPARTMENT OF ENVIRONMENTAL MANAGEMENT
OFFICE OF WATER RESOURCES
FRESHWATER WETLANDS PROGRAM
APPROVED WITH CONDITIONS AS SPECIFIED IN THE LETTER OF APPROVAL
DATED: **AUG 13 2024** FILE #: **24-0157**
NO CHANGES ALLOWED WITHOUT PRIOR APPROVAL
APPROVED PLANS MUST BE AT CONSTRUCTION SITE

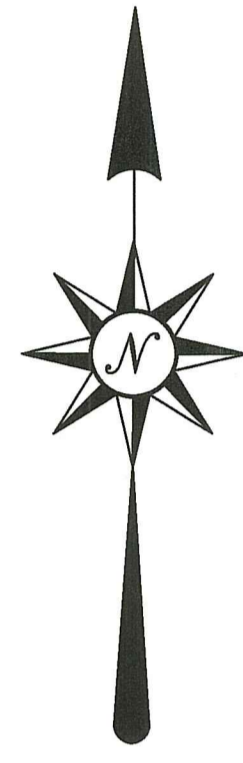

PASCOAG RESERVOIR
DAM SPILLWAY ELEV. 441.84

AP 209, LOT 143
N/F SEACONKE WAMPANOAG & TOWN OF BURRILLVILLE

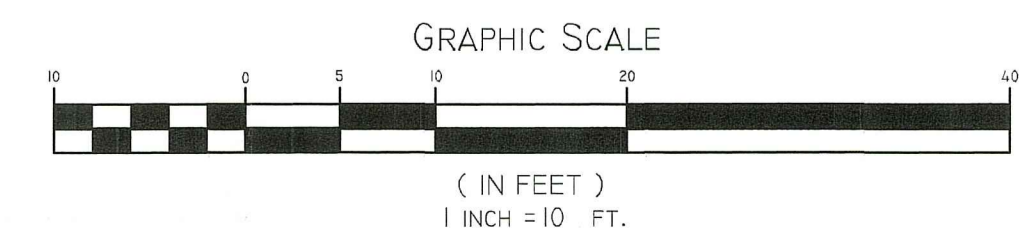

GENERAL NOTES:

- OWNER: TIKI VILLAGE HOMEOWNERS ASSOCIATION, INC. 23 HAWTHORNE COURT, NORTH KINGSTOWN, RI 02852
- WETLANDS FLAGGED BY NATURAL RESOURCE SERVICES, INC. ON APRIL, 2023.
- SITE IS PARTIALLY LOCATED IN FLOOD ZONE AE ELEV. 446 AS DEPICTED ON FIRM MAP 44007C0140G WITH AN EFFECTIVE DATE OF 3/2/2009. FLOOD ELEVATION IS CONTROLLED BY DAM SPILLWAY ELEV. 441.84.
- TOTAL NEW IMPERVIOUS AREA = 169 SF. PER COMMENT NO. 8 OF BIOLOGICAL COMMENTS BY RENE LEGAULT WITHIN THE DEFICIENCY LETTER DATED JANUARY II, 2023, A RAIN GARDEN IS NOT REQUIRED.

CONSTRUCTION NOTES:

- ALL FOUNDATION WORK TO BE PERFORMED AFTER OCTOBER 1ST, 2023 WHEN THE PASCOAG RESERVOIR/ECHO LAKE HAS BEEN LOWERED TO WINTER LEVELS. FOUNDATION WORK TO BE COMPLETED BY MAY 1ST, 2024, WHEN LAKE LEVELS BEGIN TO RISE.
- INSTALL SEDIMENT AND EROSION CONTROLS PRIOR TO ANY DEMOLITION OR EXCAVATION WORK. EROSION CONTROLS TO BE MAINTAINED DURING THE ENTIRE CONSTRUCTION PROCESS. DEMOLITION AND REMOVAL OF EXISTING STRUCTURE TO TAKE PLACE AFTER INSTALLATION OF EROSION CONTROLS. ALL DEMOLITION MATERIALS TO BE REMOVED FROM THE SITE DAILY.
- EXCAVATION FOR THE NEW FOUNDATION WILL BE COMPLETED USING NORMAL CONSTRUCTION METHODS, WITH THE EXCEPTION OF THE SOUTHEAST CORNER OF THE FOUNDATION. THE EXISTING STRUCTURE IS SUPPORTED ON A CONCRETE FOOTING THAT IS IN PLACE WHERE THE SOUTH AND EAST WALLS WOULD MEET IF EXTENDED OUT THE EIGHT FEET INSTEAD OF JOGGING IN THE EIGHT FEET. THIS EXISTING FOOTING WILL BE PRESERVED DURING THE DEMOLITION PROCESS, INSPECTED AND REUSED IF FOUND TO BE SUFFICIENT TO SUPPORT THE NEW STRUCTURE. IF THIS FOOTING NEEDS TO BE ENLARGED OR REPLACED, A 24-TO-36-INCH DIAMETER PLASTIC PIPE WILL BE INSTALLED AS A FORM AND PLACED INTO THE GROUND EXTENDING BELOW THE FROST LINE USING A VACUUM TRUCK TO EXCAVATE THE SOIL FROM INSIDE OF THE FORM AS THE FORM IS PLACED INTO THE GROUND TO THE DESIRED DEPTH.
- NO WORK IS TO BE STARTED IMMEDIATELY PRIOR TO OR DURING RAIN EVENTS.
- IMMEDIATELY AFTER FOUNDATION INSTALL AND BACKFILL THE EAST SIDE OF THE PROJECT BETWEEN THE FOUNDATION AND EROSION CONTROLS WILL BE COVERED WITH A THICK LAYER OF STRAW MULCH TO HELP STABILIZE THE SLOPE UNTIL THE SLOPE CAN BE RESTORED WITH NATIVE GRASSES AND GROUND COVER.
- ALL EXCAVATION EQUIPMENT WILL OPERATE FROM THE UPLAND/NORTHERN SIDE OF THE SITE OR FROM WITHIN THE FOUNDATION FOOTPRINT. ANY EXCAVATED MATERIALS WILL BE REMOVED FROM THE CONSTRUCTION SITE DAILY.
- ALL EROSION CONTROLS ARE TO BE MAINTAINED ON A DAILY BASIS DURING THE CONSTRUCTION PROCESS. EROSION CONTROLS TO BE REMOVED AFTER THE CONSTRUCTION IS COMPLETE AND ALL GRADING WORK, SEEDING, AND PLANTING HAVE BEEN INSTALLED.

*per RIDEM:
The edge of the larger pipe, if installed, must not be any closer to the stream than the edge of the current footing (condition #12)*

LEGEND

- 44.8 --- EXISTING CONTOUR
- 452 --- PROPOSED CONTOUR
- A2 ▲ WETLAND FLAG

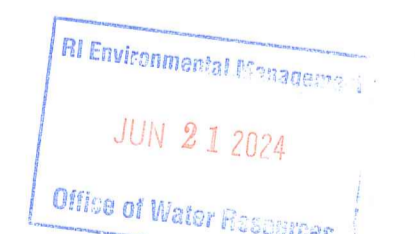

WETLANDS PLAN

PAUL D. CARLSON
No. 7142
REGISTERED PROFESSIONAL ENGINEER
CIVIL
PROFESSIONAL SEAL

A.P. 264 LOT 5-18
204 MOORE'S LANE, BURRILLVILLE, RHODE ISLAND

PREPARED FOR: STANLEY ZUBA
910 IRON MINE HILL ROAD, NORTH SMITHFIELD, RI 02896

JOB # 23-040	SCALE: 1" = 10'	DRAWN BY: LMB	DATE: 11-15-23
REVISED: 1-15-24, 5-13-24, 6-12-24			

INSITE Engineering Services, LLC
PROFESSIONAL ENGINEERS | LAND SURVEYORS
Precision. Clarity. Certainty.

501 Great Road, Unit 104
North Smithfield, Rhode Island
Phone: (401) 762-2870 Fax: (401) 762-2871
Web Address: insiteengineers.com

SHEET
1
OF 1