

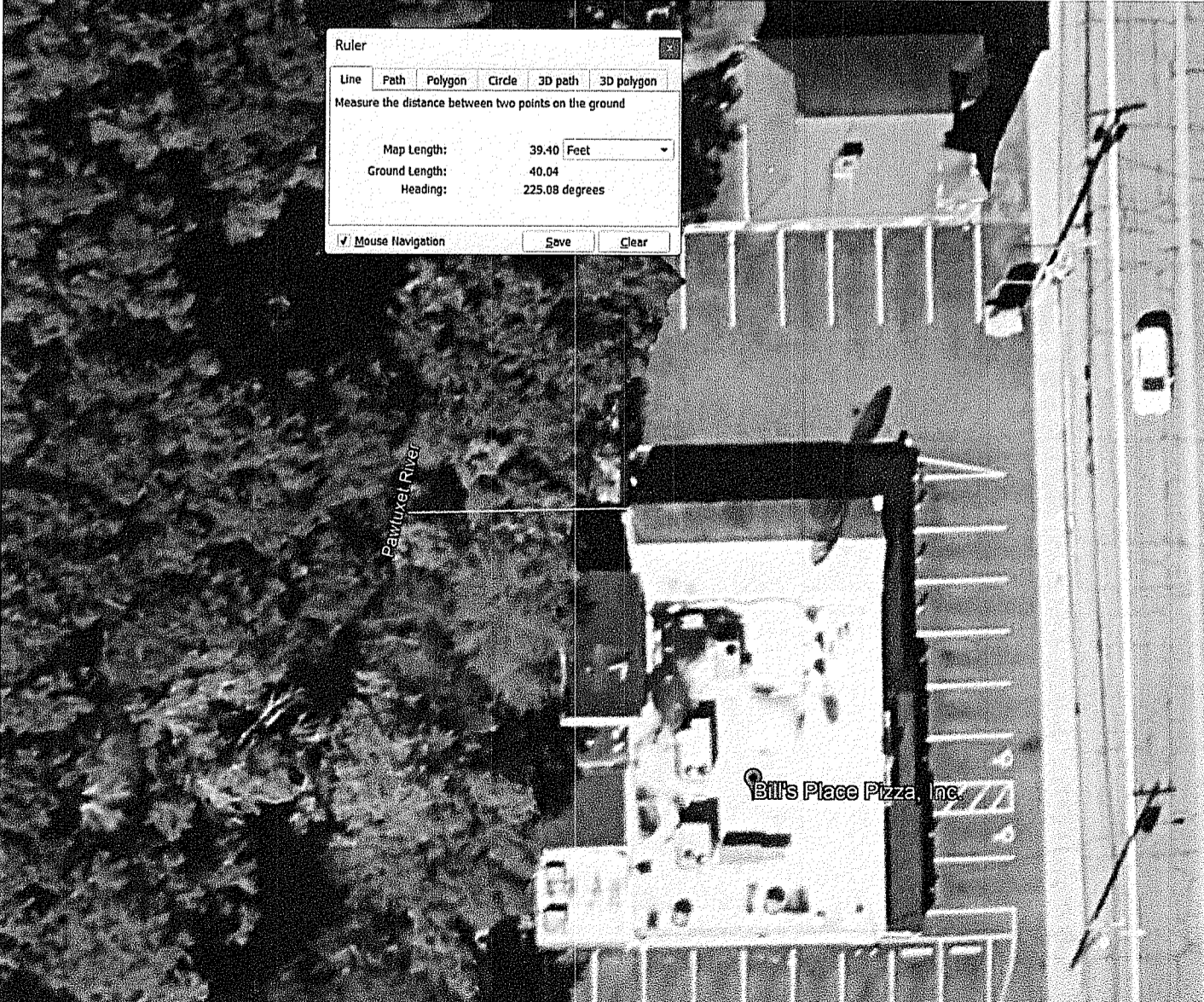

EXISTING AERIAL



PROPOSED AERIAL



GOOGLE EARTH ROUGH DISTANCE FROM RIVER TO EDGE OF EXISTING BUILDING WHERE PROPOSED ADDITION WILL ALIGN.  
MEASUREMENT IS AN APPROXIMATION USING GOOGLE EARTH

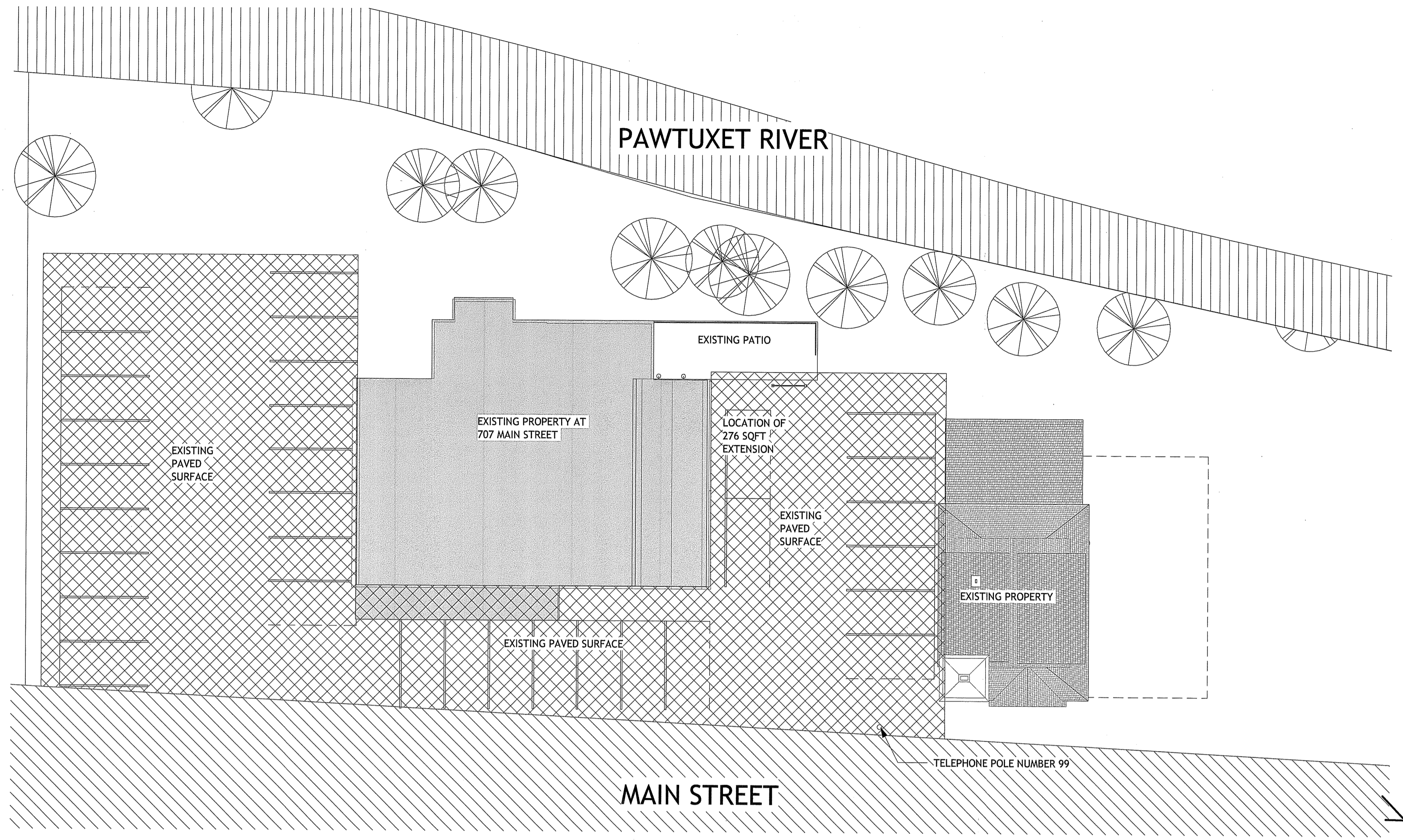

2 Existing Site Plan  
1/16" = 1'-0"

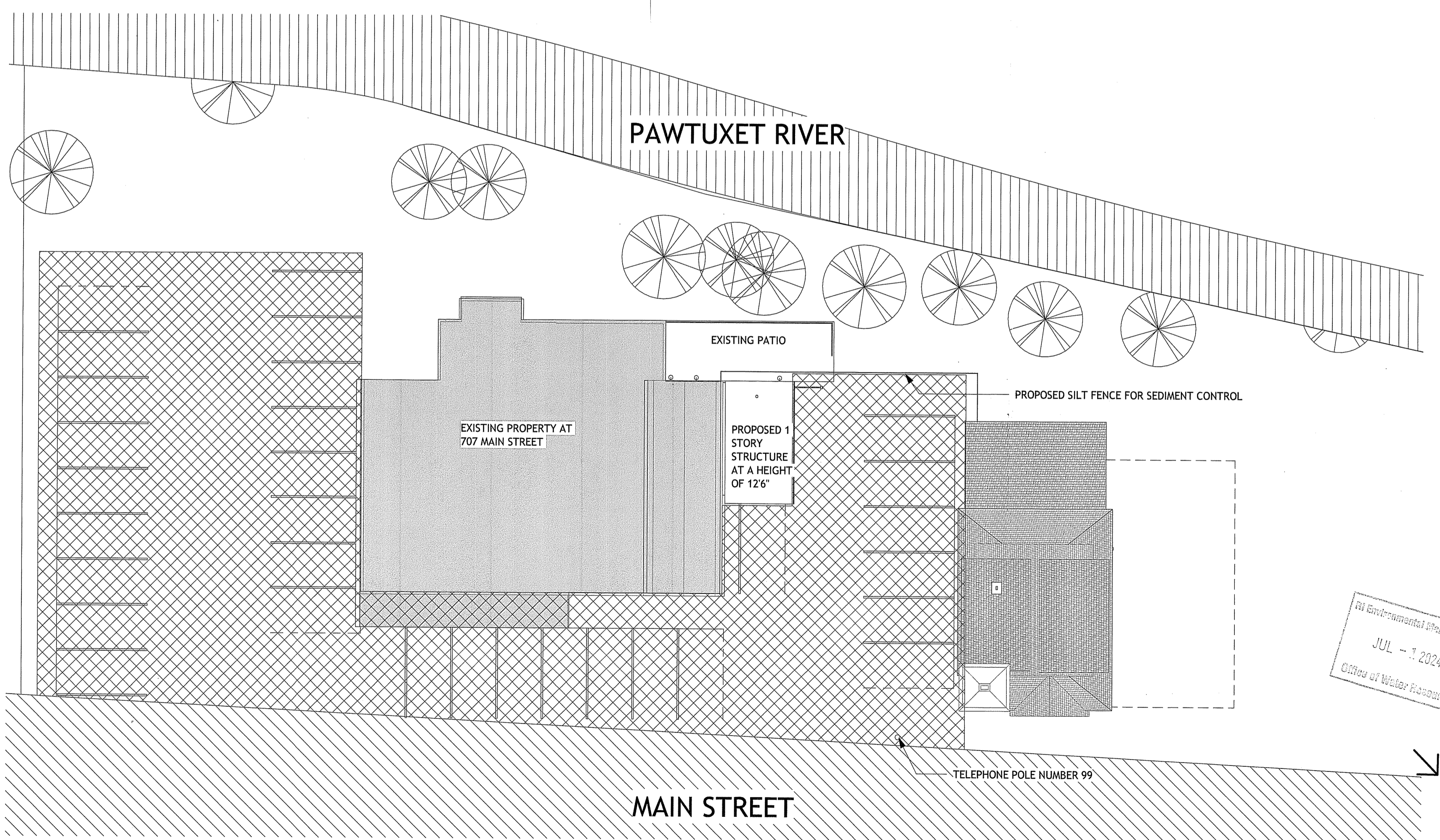

1 Proposed Site Plan  
1/16" = 1'-0"

ARCHITECTURAL SITE PLAN NOT A SURVEY.  
6/27/2024

**ARCHITECT**  
ANDERSON ALEXANDER

**PROJECT**  
BILL'S PLACE BAR RENO

**CLIENT**  
Vasilios Melanis

**PROJECT ADDRESS**  
707 Main St, West Warwick, RI 02893  
Assessor's Plat Number(s): 002  
Assessor's Lot Number(s): 0052

**NOTES**

1. THE ARCHITECT IS NOT RESPONSIBLE FOR THE INFORMATION CONCERNING THE SITE AND SURVEY INFORMATION PREPARED BY OTHERS.
2. THE CONTRACTOR SHALL SITE VERIFY THE SURVEY INFORMATION PRIOR TO PROCEEDING WITH THE WORK. FAILURE TO REPORT ANY DISCREPANCIES SHALL CONSTITUTE ACCEPTANCE OF THE SITE CONDITIONS.
3. THE CONTRACT DOCUMENTS PREPARED BY THE ARCHITECT ARE THE ARCHITECT'S COPYRIGHT PROPERTY AND SHALL BE RETURNED TO THE ARCHITECT UPON REQUEST. REPRODUCTION OF THE CONTRACT DOCUMENTS IN WHOLE OR IN PART IS FORBIDDEN WITHOUT THE ARCHITECT'S WRITTEN PERMISSION.
4. THE CONTRACTOR SHALL REVIEW THE DRAWINGS FOR SCOPE OF DEMOLITION AND NEW WORK, INCLUDING ALL DISCIPLINES, AND SHALL COORDINATE WITH THE NEW WORK DRAWINGS FOR EXACT EXTENT OF DEMOLITION.
5. SCOPE OF WORK SHALL NOT BE LIMITED TO THAT SHOWN ON THE DRAWINGS AND SHALL INCLUDE WORK REQUIRED TO ELIMINATE ALL EXISTING, ABANDONED OR REDUNDANT COMPONENTS, AND FACILITATE PROPER EXECUTION OF THE WORK.
6. ALL DIMENSIONS, INCLUDING EXISTING DIMENSIONS AND SETTING-OUT GEOMETRIES, SHALL BE SITE VERIFIED BY THE CONTRACTOR PRIOR TO PROCEEDING WITH THE WORK.
7. REMOVAL AND DISPOSAL OF THE HAZARDOUS MATERIALS SHALL BE IN ACCORDANCE WITH LOCAL REGULATIONS AND AUTHORITIES HAVING JURISDICTION.
8. UNLESS NOTED OTHERWISE, MAKE GOOD ALL AREAS DISTURBED BY EXCAVATION AND/OR INSTALLATION OF CIVIL, MECHANICAL AND ELECTRICAL SERVICES. REFER TO CIVIL, MECHANICAL AND ELECTRICAL DRAWINGS.
9. THE CONTRACTOR SHALL COORDINATE BASE BUILDING WORKS WITH WORK OF OTHER CONTRACTORS, INCLUDING TENANT WORKS AS REQUIRED TO FACILITATE PROPER INSTALLATION.
10. ALL EXPOSED CAST-IN-PLACE CONCRETE SHALL BE ARCHITECTURAL FINISH - MEDIUM SANDBLAST FINISH, UNLESS NOTED OTHERWISE.

**NOTE**  
Discrepancies must be reported immediately to the Architect before proceeding. Only figured dimensions are to be used. Contractors must check all dimensions on site. This drawing is protected by copyright.

**ALL DIMENSIONS ARE SHOWN IN IMPERIAL.**

**SEAL**  
JUL - 7 2024  
City of West Warwick

**DRAWING SET**  
DRAWING TITLE  
Architectural Site Plan

**PROJECT NO.**  
DATE  
SCALE  
DRAWN BY

2023  
Issue Date  
1/16" = 1'-0"  
Author  
A-051  
PAGE NUMBER